

FIN. FL.	627.70
TOP OF FNDN.	626.70
BSMT FL.	618.99
TOP FTR.	618.70
BOT FTR.	618.03
GARAGE FL.	625.70
8' BASEMENT	

LEGEND

- 625 EXISTING CONTOUR
- 625 PROPOSED CONTOUR
- SEDIMENT CONTROL
- TEMPORARY SEEDING AND MULCHING (30' BEHIND CURB)
- INLET PROTECTION

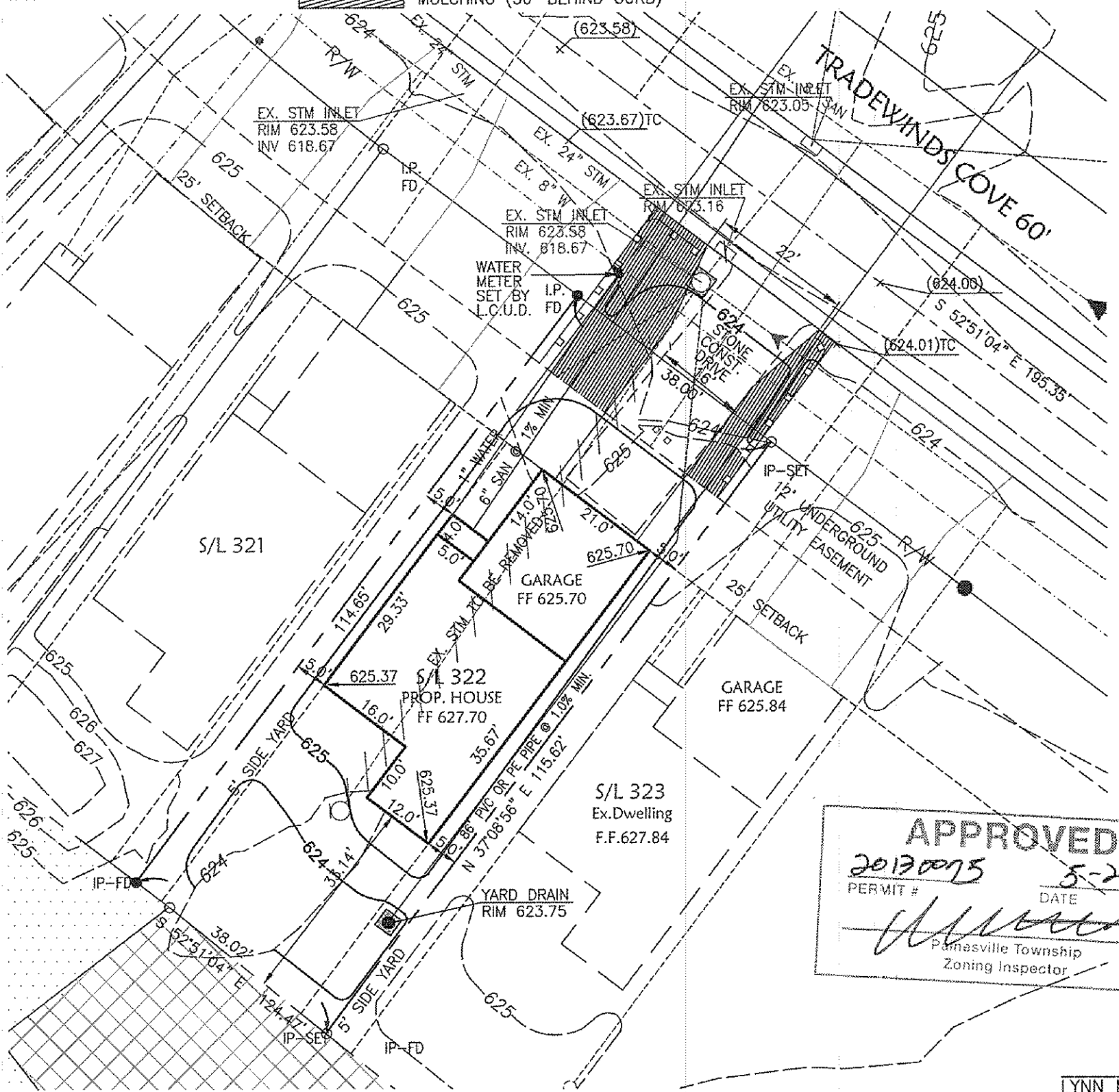

APPROVED
20130075 5-21-13
PERMIT # DATE
Painesville Township
Zoning Inspector

GENERAL NOTES

- BENCHMARK - EX. HYDRANT, TOP NUT, IN FRONT OF SUBLOT 318
ELEVATION = 626.08
- DRIVEWAY APRON TO BE 6" THICK CONCRETE.
- ALL DOWN SPOUTS TO BE OUTLETTED TO SPLASH BLOCKS.
- CONTRACTOR RESPONSIBLE FOR CONTACTING THE OHIO UTILITY PROTECTION SERVICE 1 (800) 362-2764 AND ALL UTILITY COMPANIES A MINIMUM OF 48 HOURS PRIOR TO CONSTRUCTION.
- THE LOCATION BOTH HORIZONTAL AND VERTICAL OF EXISTING UNDERGROUND UTILITIES SHOWN HEREON, HAVE BEEN OBTAINED BY A DILIGENT AND COMPREHENSIVE SEARCH OF AVAILABLE RECORDS. VERIFICATION BY FIELD OBSERVATION HAS BEEN CONDUCTED WHERE PRACTICAL, HOWEVER, OXBOW ENGINEERING, INC. DOES NOT GUARANTEE THE COMPLETENESS, NOR ACCURACY THEREOF.
- CONTRACTOR SHALL VERIFY ELEVATIONS OF LATERAL INVERTS IN THE FIELD PRIOR TO FOUNDATION EXCAVATION.
- EROSION AND SEDIMENT-CONTROL PRACTICES TO BE INSTALLED AS DESCRIBED IN THE RAIN WATER LAND DEVELOPMENT MANUAL AS DIRECTED BY THE LAKE COUNTY SOIL AND WATER CONSERVATION DISTRICT.
- DISTURBED AREAS OF THE SITE THAT ARE TO REMAIN IDLE FOR MORE THAN THIRTY (30) DAYS SHALL BE PROPERLY SEEDED AND STRAW MULCHED WITHIN SEVEN (7) DAYS OF COMPLETION OF INITIAL GRADING. TEMPORARY SEEDING AND MULCHING OF A THIRTY (30) FOOT STRIP OF THE ENTIRE FRONT OF THE LOT SHALL BE MAINTAINED ON THE SITE ONCE INITIAL GRADING IS COMPLETE.
- STRAW-MULCH SHALL BE APPLIED AT A RATE OF 1 BALE PER EVERY TEN (10) FEET OF CURB, AT A WIDTH OF THIRTY (30) FEET OF THE ENTIRE LENGTH OF THE LOT.
- WATER AND SANITARY LATERALS TO BE INSTALLED IN ACCORDANCE WITH LAKE COUNTY UTILITIES DEPARTMENT STANDARDS.
- CONTRACTOR INSTALLING LATERALS MUST BE REGISTERED WITH THE L.C.U.D. HOME BUILDER TO INSTALL WATER LATERAL TO THE WATER METER AND LCUD WILL TAP INTO THE WATER MAIN.
- CONTRACTOR SHALL BACKFILL ABOVE LATERALS WITH PREMIUM BACKFILL COMPACTED AND TESTED PER REQUIREMENTS OF A SOILS ENGINEER, WITHIN THE ZONE OF INFLUENCE.
- CONTRACTOR TO ADJUST EXISTING STORM INLET IN DRIVE TO GRADE AS NEEDED FOR FINAL DRIVE CONSTRUCTION.
- CONTRACTOR SHALL RELOCATE TELECOMMUNICATION BOXES FOUND IN DRIVE TO APPROVED LOCATION
- CONTRACTOR SHALL REMOVE ALL EXISTING STORM SEWER PIPE AND INLET FOUND TO BE IN CONFLICT W/THE HOUSE CONSTRUCTION.

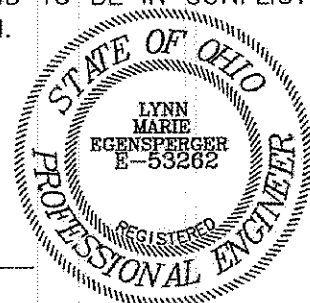

SITE PLAN
LAKE ERIE SHORES - PHASE 5
SUBLOT 322
PAINESVILLE TOWNSHIP - LAKE COUNTY - OHIO

JOB NUMBER:	11014
DATE:	05-1-13
DRAWN BY:	D.O.L.
CHECKED BY:	L.M.E.
NO. REVISION	
DATE	
BY	

oxbow
Engineering, Inc.
10 West Erie Street, Suite 201 Painesville, Ohio 44077
Phone (440) 352-8650/352-0222 Fax (440) 352-8106
oxbowengineering@oxbowglobal.net