

SHOW DOWNSPOUTS
DIRECT FLOW AWAY FROM
ADJACENT BLDGS.

GENERAL NOTES:

1. BENCHMARK - TOP OF INTERSECTION MONUMENT BOX AT TRADEWINDS COVE AND PIRATES TRAIL. ELEVATION = 624.29
2. SIDEWALK TO BE 4' WIDE, 4" THICK AND 6" THICK AT DRIVES.
3. DRIVEWAY APRON TO BE 6" THICK CONCRETE.
4. ALL DOWN SPOUTS TO BE OUTLETTED TO SPLASH BLOCKS.
5. CONTRACTOR RESPONSIBLE FOR CONTACTING THE OHIO UTILITY PROTECTION SERVICE 1 (800) 362-2764 AND ALL UTILITY COMPANIES A MINIMUM OF 48 HOURS PRIOR TO CONSTRUCTION.
6. THE LOCATION BOTH HORIZONTAL AND VERTICAL OF EXISTING UNDERGROUND UTILITIES SHOWN HEREON, HAVE BEEN OBTAINED BY A DILIGENT AND COMPREHENSIVE SEARCH OF AVAILABLE RECORDS. VERIFICATION BY FIELD OBSERVATION HAS BEEN CONDUCTED WHERE PRACTICAL, HOWEVER, OXBOW ENGINEERING, INC. DOES NOT GUARANTEE THE COMPLETENESS, NOR ACCURACY THEREOF.
7. CONTRACTOR SHALL VERIFY ELEVATIONS OF LATERAL INVERTS IN THE FIELD PRIOR TO FOUNDATION EXCAVATION.
8. EROSION AND SEDIMENT-CONTROL PRACTICES TO BE INSTALLED AS DESCRIBED IN THE RAIN WATER LAND DEVELOPMENT MANUAL AS DIRECTED BY THE LAKE COUNTY SOIL AND WATER CONSERVATION DISTRICT.
9. TEMPORARY SEEDING SHALL BE APPLIED ON ALL DISTURBED SOIL THAT WILL NOT BE REWORKED FOR WITHIN 30 DAYS. THESE IDLE AREAS TO BE SEEDD WITHIN 7 DAYS.

C1- CURVE DATA:
A = 40.98'
R = 60.00'
 Δ = 39°07'59"
C = 40.19'
N 00°57'32" E

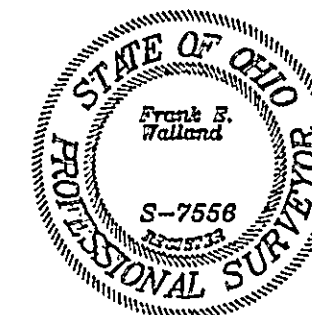

Frank E. Walland
FRANK E. WALLAND, P.S. NO. 7556

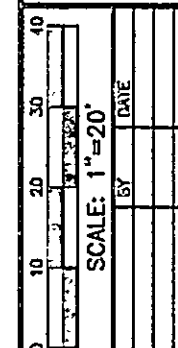

JOB NUMBER: 102020
DATE: 7-30-03
DRAWN BY: URB
CHECKED BY: FEM
NO. REVISION: 1

oxbow Engineering, Inc.
10 East Erie Street, Suite 201, Plainville, Ohio 43077
Phone (419) 523-8335 / 018-0341 Fax (419) 523-0103
oxbow@oxbow.com

SITE PLAN
LAKE ERIE SHORES - SUBLOT 99
PAINSEVILLE TOWNSHIP
LAKE COUNTY - OHIO

SHEET
1 OF 1

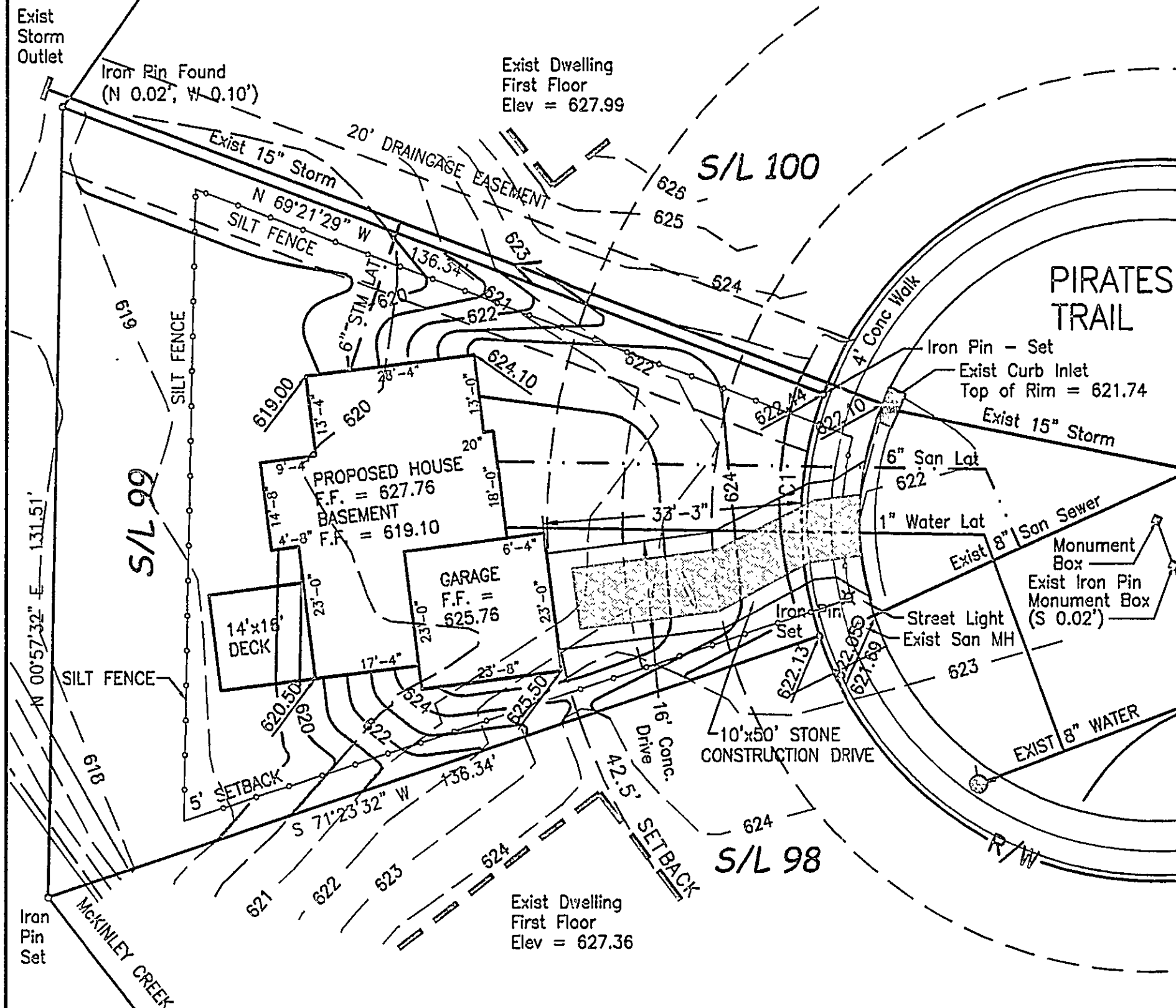

Subject to approval by:

- ☒ Zoning Department *DONE*
- ☐ LC General Health District
- ☒ LC Soil & Water Conservation District
- ☒ LC Building Department (final approval)

Stormwater Management Plan
Approved as shown and/or noted
JAMES R. GILLS, P.E.
County Drainage Engineer

By L.S. Date 2/13/04