

# GRAPHIC SCALE

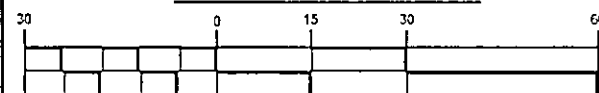

(IN FEET)  
1 inch = 30 ft.

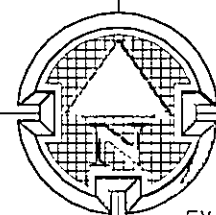

**Barrington**  
CONSULTING GROUP, INC.

EX STM INLET  
RIM=614 31  
INV =606 21  
INV =609 36

EX SAN MH  
RIM=614 92  
INV =600 62

EX STM MH  
RIM=614 03  
INV =605 23

T.B.I.L. TOP STEM OF HYD.  
ELEV. = 617.29

**NORTH SHORE DR. 60'**

PROP 5' CONC  
SIDEWALK

150' EX 12" STM SEWER

EX 8" WATERLINE

1 PIN SET  
& USED

PROP CONC  
DRIVE

6" STM CONC  
W/ R CONC

6" STM CONC  
W/ R CONC

6" STM CONC  
W/ R CONC

6" STM CONC  
W/ R CONC

6" STM CONC  
W/ R CONC

6" STM CONC  
W/ R CONC

6" STM CONC  
W/ R CONC

6" STM CONC  
W/ R CONC

6" STM CONC  
W/ R CONC

6" STM CONC  
W/ R CONC

6" STM CONC  
W/ R CONC

6" STM CONC  
W/ R CONC

6" STM CONC  
W/ R CONC

6" STM CONC  
W/ R CONC

6" STM CONC  
W/ R CONC

6" STM CONC  
W/ R CONC

6" STM CONC  
W/ R CONC

6" STM CONC  
W/ R CONC

L=33.11'  
R=530.00'  
Δ=03°34'44"  
C=33.10'  
S 65°12'55" W

S/L 27  
P.P. No 11-B-050-A-00-027-0  
1661 N SHORE DR  
BERTONE ANTHONY F & CAROL L  
(VACANT)

1 PIN SET  
20' FROM CORNER

PROPOSED  
HOUSE

S/L 26

P.P. No 11-B-050-A-00-026-0

1665 N SHORE DR

SCHILTZ KENNETH A & TINA M

14,611 80 SQ FT

0.3354 ACRES

PRESERVATION EASEMENT

FOOTER DRAIN

1 PIN SET

1 PIN SET

1 PIN SET

1 PIN SET

EX HSE  
FF ELEV  
=618 46

S/L 25  
P.P. No 11-B-050-A-00-025-0  
1641 N SHORE DR  
MANCINI SANDRO N TR

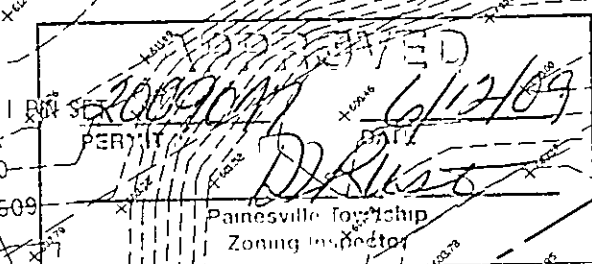

## GENERAL NOTES:

1. BENCHMARK - TOP STEM OF EXISTING FIRE HYDRANT LOCATED IN FRONT SUBLOT 24, ELEVATION = 617.29.
2. DRIVEWAY APRON TO BE 6" THICK CONCRETE.
3. ALL DOWNSPOUTS TO BE OUTLETED TO SPLASH BLOCKS.
4. CONTRACTOR RESPONSIBLE FOR CONTACTING THE OHIO UTILITY PROTECTION SERVICE (1.800.362 2764) AND ALL UTILITY COMPANIES A MINIMUM OF 48 HOURS PRIOR TO CONSTRUCTION.
5. THE LOCATION BOTH HORIZONTAL AND VERTICAL OF EXISTING UNDERGROUND UTILITIES SHOWN HEREON, HAVE BEEN OBTAINED BY A DILIGENT AND COMPREHENSIVE SEARCH OF AVAILABLE RECORDS. VERIFICATION BY FIELD OBSERVATION HAS BEEN CONDUCTED WHERE PRACTICAL, HOWEVER, BARRINGTON CONSULTING GROUP, INC. DOES NOT GUARANTEE THE COMPLETENESS, NOR ACCURACY THEREOF.
6. CONTRACTOR SHALL VERIFY ELEVATIONS OF LATERAL INVERTS IN THE FIELD PRIOR TO FOUNDATION EXCAVATION.
7. SEE SHEET 2 FOR EROSION AND SEDIMENT-CONTROL PLAN
8. SEE SHEET 2 FOR SEEDING INFORMATION

## CERTIFICATION :

"I THE UNDERSIGNED HEREBY CERTIFIES THAT THIS TOPOGRAPHY INDICATED BY 1 FOOT CONTOURS AND ELEVATION SHOWN HEREON REPRESENTS AN ACTUAL SURVEY MADE BY ME ON THE 7th DAY OF MAY, 2009 AND THE ELEVATIONS WERE TAKEN AT AN APPROPRIATE INTERVAL AND AS OF THAT DAY THEY EXISTED AS INDICATED HEREON.

"I HEREBY CERTIFY THAT THIS PLAN WAS PREPARED BY ME AND IS CORRECT TO THE BEST OF MY KNOWLEDGE AND BELIEF"

*David W. Novak*  
6/11/2009

DAVID W. NOVAK, P.S. No. 7507  
CERT 10709

Stormwater Management Plan  
Approved as shown and/or noted  
**JAMES R. GILLS, P.E.**  
County Drainage Engineer

By 1' OVERHANG & S. Date 6/24/09

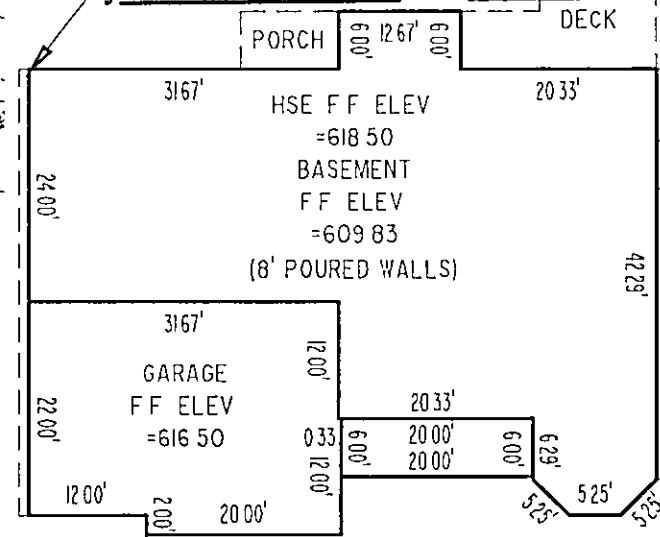

REVISIONS	BY

**Barrington**  
CONSULTING GROUP, INC.  
9114 TYLER BLVD., MENTOR, OHIO 44060  
PHONE 440.205.1260 FAX 440.205.1262  
www.BarringtonCGI.com



**SITE PLAN**  
1665 NORTH SHORE DR., PAINESVILLE TWP., OHIO 44077  
NORTH SHORE ESTATES VOL. 50 PG. 5

PROBUILT HOMES

DRAWN WSO	CHECKED DWN
DATE JUNE 9, 2009	SCALE 1" = 30'
JOB NO 09005-006	SHEET 1/2
OF	SHEETS

09005-026