

7/11/10



~~2005259 D/K~~  
8/1/05

[illegible]

**Barrington**  
CONSULTING GROUP, INC.  
9114 TYLER BLVD., MENTOR, OHIO 44060  
PHONE 440.205.1260 FAX 440.205.1262  
BCG@BarringtonCGI.com



**SITE PLAN**  
SIL 36 MADISON AVE. P.P. NO. 11A022000360  
PAINESVILLE TWP. OHIO 44077

**NOSTALGIA HOMES**

**NOSTALGIA HOMES**

DRAWN	WSO
CHECKED	DWN
DATE	JULY 27, 2005
SCALE	1" = 30'
JOB NO	05055-36
SHEET	1/2

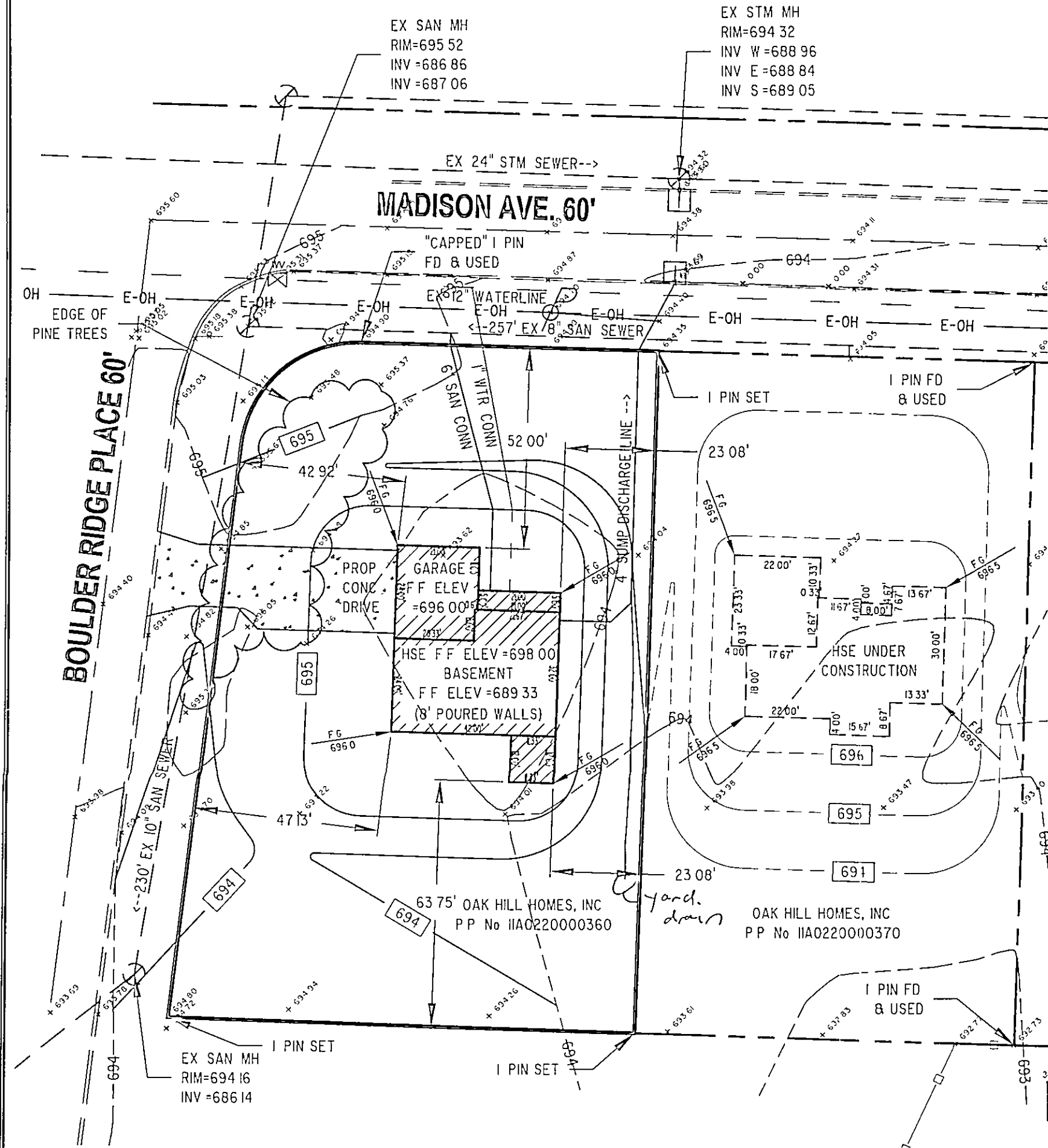

1. BENCHMARK - TOP STEM OF EXISTING FIRE HYDRANT LOCATED APPROX. 172± EAST OF SUBLOT 37, ELEVATION = 695.95.
2. DRIVEWAY APRON TO BE 6" THICK CONCRETE.
3. ALL DOWNSPOUTS TO BE OUTLETTED TO SPLASH BLOCKS.
4. CONTRACTOR RESPONSIBLE FOR CONTACTING THE OHIO UTILITY PROTECTION SERVICE (1.800.362.2764) AND ALL UTILITY COMPANIES A MINIMUM OF 48 HOURS PRIOR TO CONSTRUCTION.
5. THE LOCATION BOTH HORIZONTAL AND VERTICAL OF EXISTING UNDERGROUND UTILITIES SHOWN HEREON, HAVE BEEN OBTAINED BY A DILIGENT AND COMPREHENSIVE SEARCH OF AVAILABLE RECORDS. VERIFICATION BY FIELD OBSERVATION HAS BEEN CONDUCTED WHERE PRACTICAL, HOWEVER, BARRINGTON CONSULTING GROUP, INC. DOES NOT GUARANTEE THE COMPLETENESS, NOR ACCURACY THEREOF.
6. CONTRACTOR SHALL VERIFY ELEVATIONS OF LATERAL INVERTS IN THE FIELD PRIOR TO FOUNDATION EXCAVATION.
7. SEE SHEET 2 FOR EROSION AND SEDIMENT-CONTROL PLAN
8. SEE SHEET 2 FOR SEEDING INFORMATION

"I THE UNDERSIGNED HEREBY CERTIFIES THAT THIS TOPOGRAPHY INDICATED BY 1 FOOT CONTOURS AND ELEVATION SHOWN HEREON REPRESENTS AN ACTUAL SURVEY MADE BY ME ON THE 27th DAY OF JULY, 2005 AND THE ELEVATIONS WERE TAKEN AT AN APPROPRIATE INTERVAL AND AS OF THAT DAY THEY EXISTED AS INDICATED HEREON.

"I HEREBY CERTIFY THAT THIS PLAN WAS PREPARED BY ME AND IS  
CORRECT TO THE BEST OF MY KNOWLEDGE AND BELIEF"

D. Davis

DAVID W. NOVAK, P.S. No. 7507

CERT 1.DWG

