

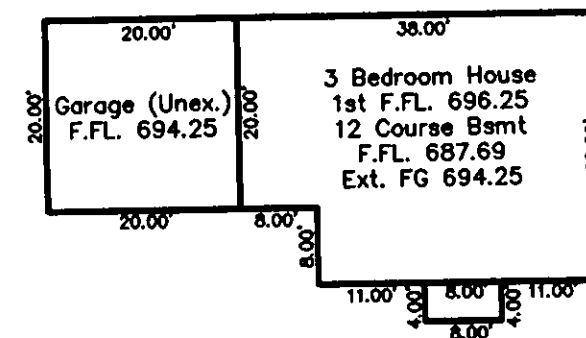

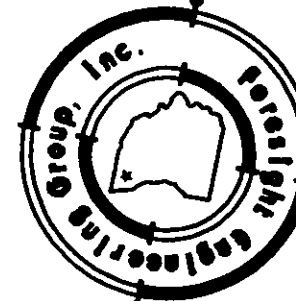



36 BIG ROCK DRIVE - 60'



Front Setback 50'
Side Yard Setback 10'
Rear Yard Setback 25'

SYMBOL LEGEND	
	Monument Box Foundation
	Fire Hydrant
	Manhole
	Catch Inlet
	Yard Drain
	Telephone Box

Note: Floodway Information per LOMR
Map Revision FEMA Case # 95-05-329R
Lot not in Flood Zone.

THOMAS P. GILLES, Eng.
Lake County Engineer

By TAM Date 7/12/95

ROOF DRAINS
SHALL DISCHARGE
TO SPLASH BLOCKS

for : R.L. MOORE
CLIENT
7121 Ravenna Rd. Concord Ohio 44077
ADDRESS CITY STATE ZIP

45 Eastern Woodlands Sub.
SUBLOT No. SUBDIVISION NAME VOL. PAGE
Painesville Twp. Ohio
LOT TRACT CITY STATE

Foresight Engineering Group

440 286-1010
440 286-1034 fax
320 Center Street, Unit F
Chardon, Ohio 44024

Engineers & Surveyors

DESIGN CERTIFICATION

This Site Plan was prepared by Foresight Engineering Group, Inc.,
and is correct to the best of my knowledge and belief.

NAME Chae Grabe

CHECK LIST

LOT DIMENSIONS & BEARINGS
TIE TO NEAREST STREET
SUBLOT No. (PARCEL No.)
SURROUNDING OWNERS
BUILDING DIMENSIONS
SETBACK, SDEYARD, REARYARD
FINISH GRADES
DRIVE & APRON TYPE, WIDTH, THICKNESS
SIDEWALK TYPE, WIDTH, THICKNESS
CULVERT TYPE, DIAM., LENGTH
WATER MAIN SIZE, LOCATION
SAN. SEWER SIZE, % GRADE, LOC.
SAN. MH. CAST. ELEV., INV. ELEV.
SAN. CONN. SIZE, % GRADE, LOC.
STORM SEWER SIZE, % GRADE, LOC.
STORM MH. CAST. ELEV., INV. ELEV.
PAVT TYPE, GRADE, CURBS
GAS LINE LOC., SIZE
SEPTIC SYSTEM & DUPLICATION
WELL LOCATION & ISOLATION RADIUS

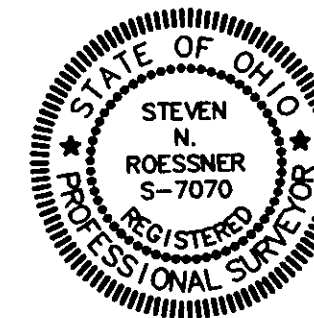

STATE SEAL

"AS BUILT" CERTIFICATION

I hereby certify that the circled information is existing as
obtained on the site _____ 19____ and is
correct to the best of my knowledge and belief.

NAME _____

SCALE : 1" = 20'	1	
FILE NAME: I: \Rim19909\SL-45	2	
DATE : July 8, 1999	3	

BENCHMARK: SAS Manhole Rim elev. = 691.91

"I, the undersigned hereby certify that this topography, indicated by 6", 1' or 2' contours, and the elevations shown hereon represent an actual field survey made by Foresight Engineering Group, Inc. on the 12 day of March, 19 99 and that the elevations were taken at appropriate intervals and that as of that date they existed as indicated hereon."

NAME Chad Graker

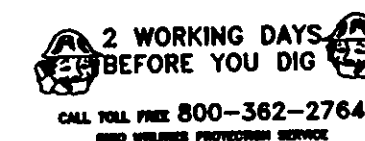

EXISTING UNDERGROUND UTILITIES NOTES:

EXISTING UNDERGROUND UTILITIES NOTES:
The location both horizontal and vertical of the underground utilities shown hereon, have been obtained by a diligent and comprehensive search of available records. Verification by field observation, has been conducted where practical. However, Foresight Engineering Group, Inc. does not guarantee the completeness nor accuracy thereof.