

SITE PLAN OF  
PROPOSED NEW DWELLING  
FOR

DALE & CAROL GIBBON

KNOWN AS BEING PART OF TRACT 3  
LOT 4 IN RANGE 6, TOWNSHIP 12 OF  
THE CONNECTICUT WESTERN RESERVE

TOWNSHIP OF MADISON

COUNTY OF LAKE - STATE OF OHIO

LAKE ERIE

DALE E. & CAROL J. GIBBON  
VOLUME 68, PAGE 1000

NOTE: DIRT FROM FOUNDATION IS  
TO BE PLACED IN THIS AREA

ODNR Permit  
Required

RICHARD SEYMOUR  
DOC #960048868  
1B-115-1-9

Stormwater Management Plan  
Approved as shown and/or noted  
JAMES R. GILLS, P.E.  
County Drainage Engineer  
By LSH Date 12/17/03  
ODNR Permit required

0 15 30 60  
SCALE 1" = 30'

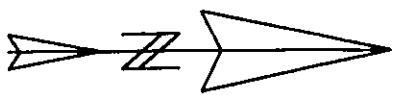

BENCHMARK SURVEY COMPANY  
5964 SOUTH RIDGE ROAD  
MADISON, OHIO 44057-9741  
AUGUST 22, 2003  
APPROVED 1-440-428-8599  
MADISON TOWNSHIP ZONING  
DATE 2/8/03  
BY 21601

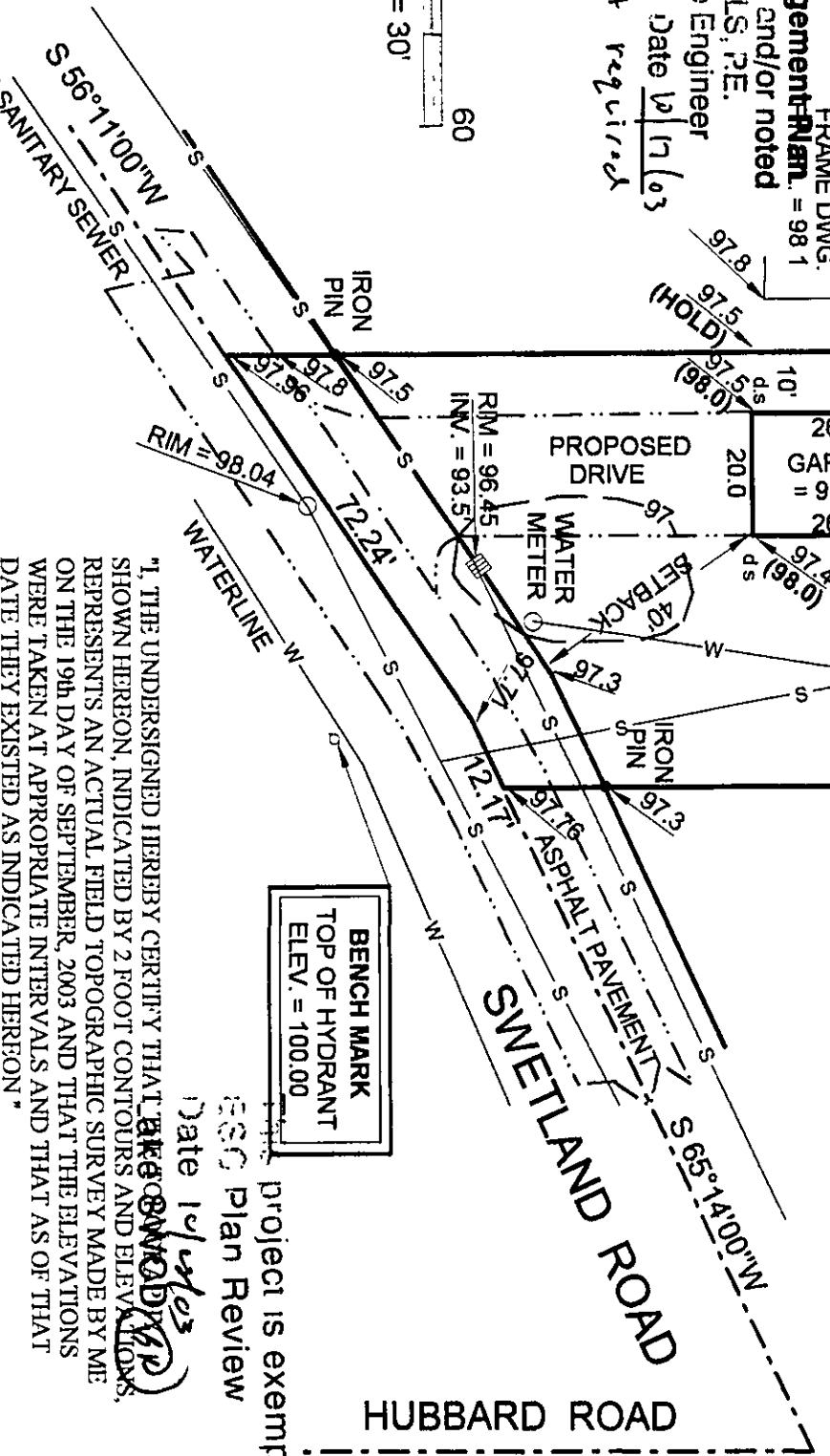

NOTES: 1) TEMPORARY STONE TO BE INSTALLED  
AT DRIVEWAY ENTRANCE.

2) UNABLE TO OPEN MANHOLE IN FRONT OF  
LOT AND OBTAIN INVERT. INVERT IS TAKEN  
FROM IMPROVEMENT PLANS OBTAINED  
FROM THE UTILITIES DEPARTMENT. IT  
APPEARS THAT THE BASEMENT FLOOR  
IS 2 FEET HIGHER THAN THE INVERT.  
CONNECTIONS ARE TO BE VERIFIED  
AT TIME OF CONSTRUCTION.

3) ds = DOWNSPOUT WITH SPLASHBLOCKS

LOUISE HALL & LOIS ALBRIGHT  
VOLUME 260, PAGE 1078  
1B-115-1-5

EXISTING ELEVATION  
(PROPOSED ELEVATION)

EXISTING CONTOUR  
(PROPOSED CONTOUR)

BENCH MARK  
TOP OF HYDRANT  
ELEV. = 100.00

"I, THE UNDERSIGNED HEREBY CERTIFY THAT THE ELEVATIONS  
SHOWN HEREON, INDICATED BY 2 FOOT CONTOURS AND ELEVATIONS,  
REPRESENTS AN ACTUAL FIELD TOPOGRAPHIC SURVEY MADE BY ME  
ON THE 19th DAY OF SEPTEMBER, 2003 AND THAT THE ELEVATIONS  
WERE TAKEN AT APPROPRIATE INTERVALS AND THAT AS OF THAT  
DATE THEY EXISTED AS INDICATED HEREON"

Project is exempt from  
ESC Plan Review  
Date 12/17/03

JAMES A. ZIEMBA, PROFESSIONAL SURVEYOR #7094

