

SITE PLAN

MADISON TOWNSHIP, LAKE COUNTY, OHIO

for: HANDCRAFTED HOMES

CLIENT	OWNER
ADDRESS	STREET CITY ZIP
SILVER ASH SUB	NAME TRACT
SUBDIVISION 34-26	STREET
VOL-PG. 3	LOT
SUBLOT NO. 3	SILVER ASH TRAIL
STREET	VOL-PG. PERM. PARCEL NO.

LEGEND

SANITARY MANHOLE	EXIST. ELEV. 100.0	PROP. ELEV. 100.0
STORM MANHOLE	AS BUILT ELEVATION	
INLET OR CATCH BASIN	INDICATES	
HYDRANT	DIRECTION OF	
EXISTING CONTOURS	SURFACE DRAINAGE	
PROPOSED CONTOURS		

REMARKS

ALL BOUNDARY DATA SHOWN WAS OBTAINED FROM (DEEDS, RECORDED SUBDIVISION PLAT OR OTHER PUBLIC RECORDS)

LOCATIONS AS SHOWN OF ADJACENT WELLS AND SEPTIC TANKS OBTAINED FROM LAKE COUNTY HEALTH DEPARTMENT

DESIGN CERTIFICATION

THIS PLAN WAS PREPARED BY ME, AND IS CORRECT TO THE BEST OF MY KNOWLEDGE AND BELIEF

NAME *Harry Jones* SURVEYOR REGISTRATION NO. *6343*

CHECK LIST

NO. OF BEDROOMS	WATER MAIN SIZE, LOCATION
DIMENSIONS	SAN. SEWER SIZE & GR. LOC.
BEARINGS	SAN. M.H. CAST. ELEV. INV. ELEV.
TIE TO NEAREST STREET	SAN. CORR. SIZE, LOC. DEPTH
SUBLOT NO. PARCEL NO.	STORM SEWER SIZE & GR. LOC.
SURROUNDING OWNERS	STORM M.H. CAST. ELEV. INV. ELEV.
BLDG. DIMENSIONS FIN GR.	PAY/T TYPE GRADE CURBS
BLDG. TIES FL'R. GRADES	GAS LINE LOC. SIZE PRESSURE
APRON TYPE WIDTH THICKNESS	SEPTIC TANK LOCATION & DUPLICATION AREA
SIDEWALK TYPE WIDTH THICKNESS	WELL LOCATION
CULVERT TYPE DIA., LENGTH	ISOLATION RADIUS FROM WELL
ROCK OUTCROPPINGS	

REVISIONS			PLAN PREPARED BY:		
NO.	DATE	BY	Bj BABCOCK JONES & ASSOCIATES, INC.		
1			PAINESVILLE, OHIO		
2			DRAWN BY M.M.	SCALE 1"=40'	PHONE NO. 440-357-1811
3			CHK'D. H.J.	DATE 4/4/02	DRAWING NO. 02-021-03
4			CREW EWH	APP'D H.J.	
5					

"AS BUILT" CERTIFICATION

I, HEREBY CERTIFY THAT THE CIRCLED GRADES ARE EXISTING FINISH GRADES CHECKED IN THE FIELD ON 4/4/02, 2002 AND ARE CORRECT TO THE BEST OF MY KNOWLEDGE AND BELIEF.

REGISTERED SURVEYOR REG. NO.

BM-IP MON
ASSUMED ELEV. 100.00

APPROVED
MADISON TOWNSHIP ZONING
DATE *4/26/02*
BY *20853*

"I, the undersigned hereby certify that this topography indicated by 6", 1", or 2' contours, and elevations shown hereon represent an actual field survey made by me on the 3rd day of April, 2002 and that the elevations were taken at appropriate intervals and that as of that date they existed as indicated hereon."

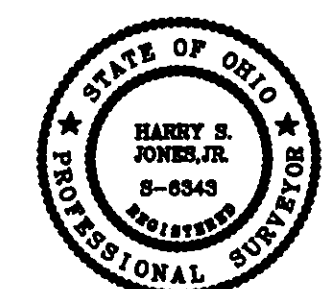

Name *Harry Jones* Reg. No. *6343*

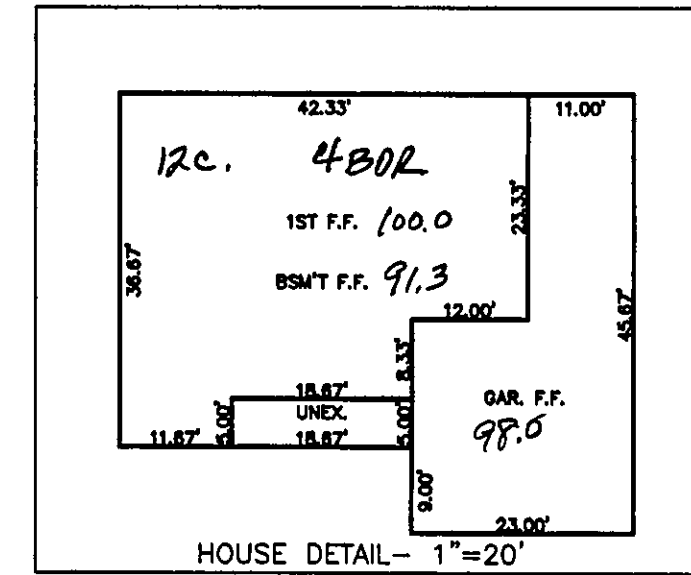

S/L 4
(VACANT)

