

2

Madison Township

RECEIVED MAR 04 1988

BENNETT RD

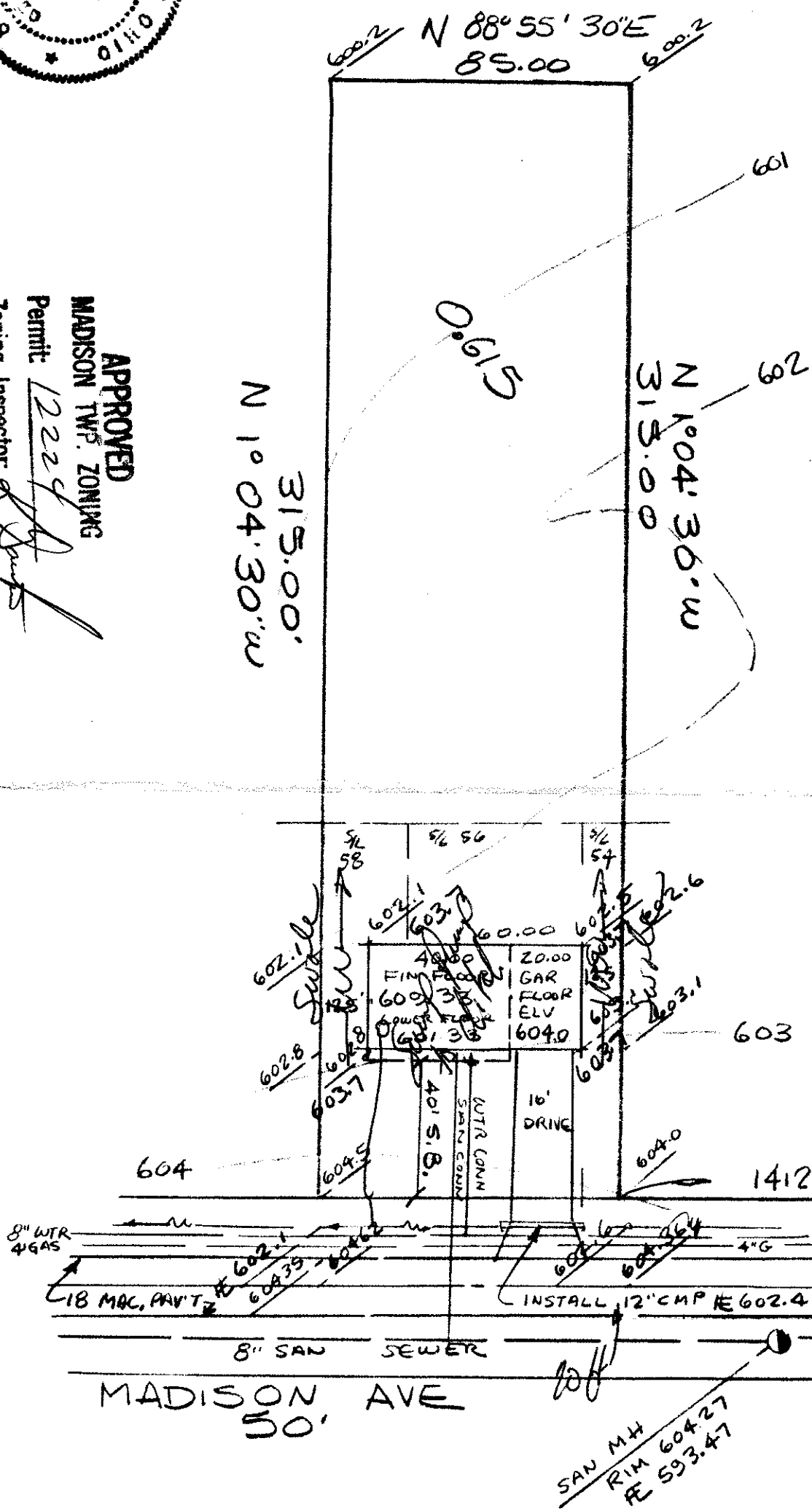

Grading Plan Approved
as shown and/or noted
THOMAS P. GILLES, P.E.
Lake County Engineer

Date 5-18-89

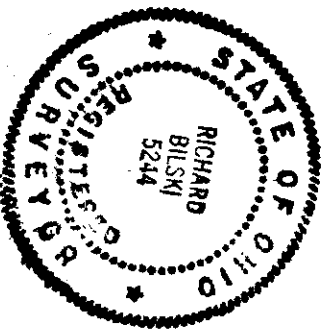

DESIGN CERTIFICATION

THIS PLAN WAS PREPARED BY ME,
AND IS CORRECT TO THE BEST OF
MY KNOWLEDGE AND BELIEF.

REG. SURVEYOR NO. 5244

AS BUILT CERTIFICATION

I HEREBY CERTIFY THAT THE CIRCLED GRADES
ARE EXISTING FINISH GRADES CHECKED IN THE
FIELD ON _____ AND THAT
SURVEY IS CORRECT TO THE BEST OF MY
KNOWLEDGE AND BELIEF.

REG. SURVEYOR NO. _____



COLPETZER-THOMAS, INC.
AN ENGINEERING GROUP

WILLOUGHBY • MENTOR • NORTH CANTON • STEUBENVILLE • LORAIN

DATE 10/6/87

SCALE 1"=40'

DRAWN BY RPB

CHKD BY 87-XXX

JOB NO. 87-XXX

PG. _____

SITE PLAN for

ARTCRAFT HOMES

MADISON TWP - LAKE

COUNTY ~ OHIO