

Stormwater Management Plan
 Approved as shown and/or noted
 JAMES R. GILLS, P.E.
 County Drainage Engineer
 By L.S. Date 10/18/13
GRAPHIC SCALE

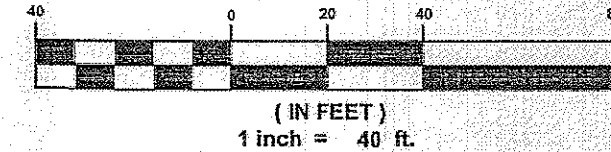

Builder and all subcontractors shall review this plan to verify house dimensions and all site improvements for any discrepancies, omissions and/or changes and notify Barrington Consulting Group, Inc. prior to any site work.

GENERAL NOTES:

1. BENCHMARK - TOP STEM OF EXISTING FIRE HYDRANT LOCATED NEAR BUILDING NO. 9, ELEVATION = 617.02.
2. DRIVEWAY APRON TO BE 6" THICK CONCRETE.
3. ALL DOWNSPOUTS TO BE OUTLETTED TO SPLASH BLOCKS.
4. CONTRACTOR RESPONSIBLE FOR CONTACTING THE OHIO UTILITY PROTECTION SERVICE (1.800.362.2764) AND ALL UTILITY COMPANIES A MINIMUM OF 48 HOURS PRIOR TO CONSTRUCTION.
5. THE LOCATION BOTH HORIZONTAL AND VERTICAL OF EXISTING UNDERGROUND UTILITIES SHOWN HEREON, HAVE BEEN OBTAINED BY A DILIGENT AND COMPREHENSIVE SEARCH OF AVAILABLE RECORDS. VERIFICATION BY FIELD OBSERVATION HAS BEEN CONDUCTED WHERE PRACTICAL, HOWEVER, BARRINGTON CONSULTING GROUP, INC. DOES NOT GUARANTEE THE COMPLETENESS, NOR ACCURACY THEREOF.
6. CONTRACTOR SHALL VERIFY ELEVATIONS OF LATERAL INVERTS IN THE FIELD PRIOR TO FOUNDATION EXCAVATION.
7. PRIOR TO ANY WORK BEING PERFORMED WITH THE RIGHT OF WAY AND/OR UNDERGROUND UTILITY EASEMENTS, CONTRACTOR SHALL CONFIRM THAT ALL REQUIRED CLEARANCES AND BURY DEPTHS OF ALL UNDERGROUND UTILITIES WILL BE MAINTAINED AS A RESULT OF ANY AND ALL SITE IMPROVEMENTS.
8. SEE SHEET 3 FOR EROSION AND SEDIMENT-CONTROL PLAN
9. SEE SHEET 3 FOR SEEDING INFORMATION

CERTIFICATION :

TOPOGRAPHY INDICATED BY 1 FOOT CONTOURS AND ELEVATION SHOWN HEREON WAS PROVIDED BY THE OWNER AND IS BASED ON DRAWINGS PREPARED BY OXBOW ENGINEERING, INC. FOR THE SITE.

"I HEREBY CERTIFY THAT THIS PLAN WAS PREPARED BY ME AND IS CORRECT TO THE BEST OF MY KNOWLEDGE AND BELIEF"

D. W. Novak 10/10/2013
 DAVID W. NOVAK, P.S. No. 7507

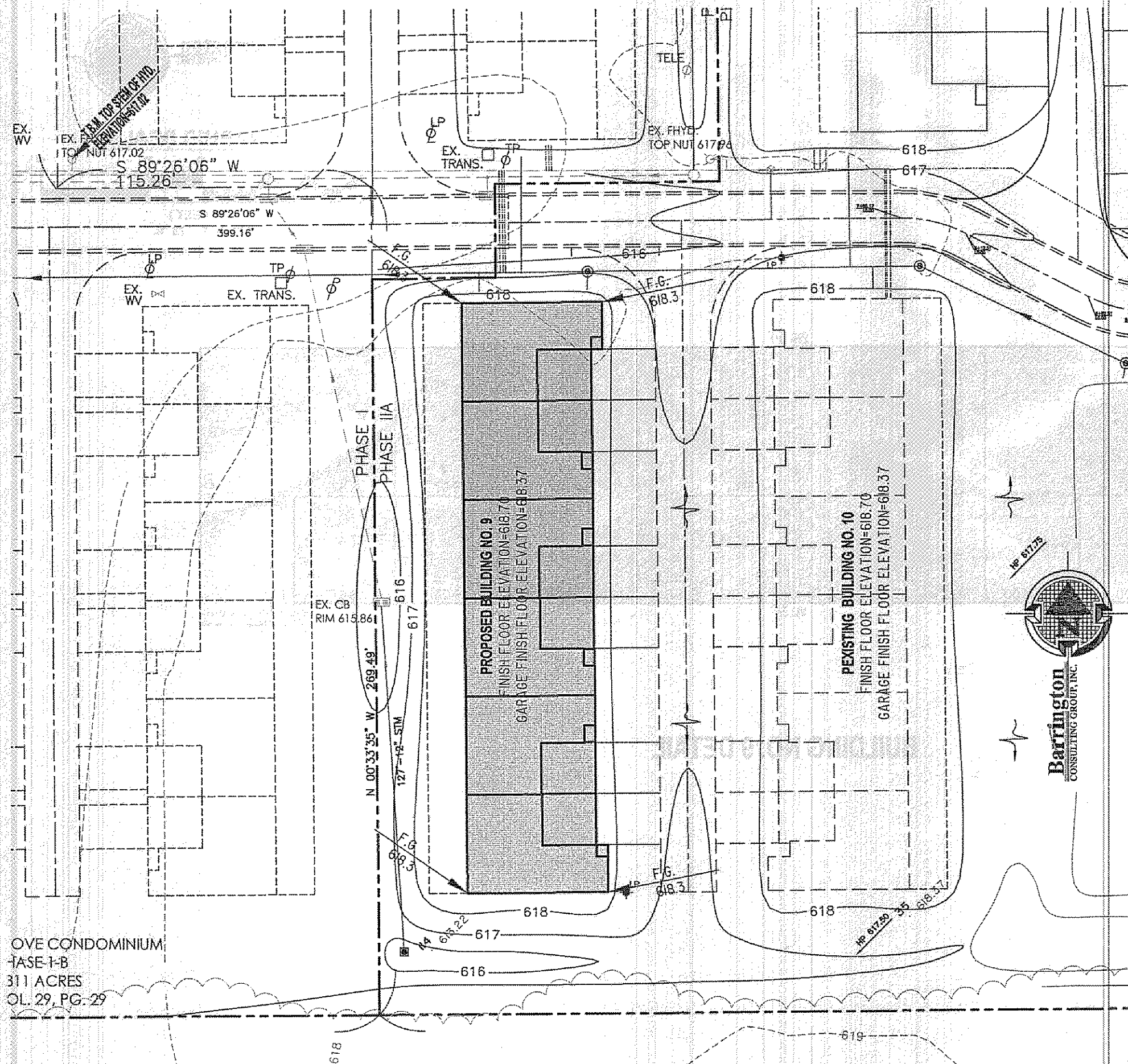

OVE CONDOMINIUM
 TASE 1-B
 311 ACRES
 OL. 29, PG. 29

REVISIONS	BY

Barrington
 CONSULTING GROUP, INC.
 9114 TYLER BLVD, MENTOR, OHIO 44060
 PHONE 440.285.1260 FAX 440.285.1262
 www.BarringtonCGI.com

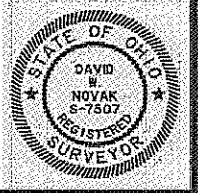

SITE PLAN
 BAYSIDE DRIVE, MADISON TWP., OH
 SNADY POINTE CONDOMINIUM
 RALPH VICTOR CONSTRUCTION

BY DWN
CHECKED DWN
DATE OCT. 11, 2013
SCALE 1" = 40'
JOB NO. 12041.09
SHEET 1/3
OF SHEETS

M:\2012\12041\2041-09 20131011-SP.dwg, 10/11/2013 10:04:50 AM, Copyright Barrington Consulting Group