

J.T. & L.K. POOLE
VOL. 780 P. 23

ROBERT L. & ANNA MAE REESE
VOL. 789 P. 362
4.425 ACRES

WM & D.L. DEVINE
VOL. 150 P. 1097

**SITE PLAN
FOR
CIANFAGLIONE BUILDERS, INC.
8209 PROCTOR ROAD**

Situated in the Township of Leroy, County of Lake and State of Ohio and known as being a part of Original Leroy Township Lots No. 5 and 6 and further being known as a parcel of land conveyed to Robert L. and Anna Mae Reese by deed recorded in Volume 789, Page 362 of Lake County Deed Records.

DESIGN CERTIFICATION

This Plat was prepared by me, and is correct to the best of my knowledge and belief.

RUDY E. SCHWARTZ, P.S. NO. 7193

NOTES: See Architect's Plan for complete house dimensions.
Builder to establish swales as required.

PREPARED BY:
RUDY E. SCHWARTZ
PROFESSIONAL SURVEYOR
15750 AUBURN ROAD
NEWBURY, OHIO 44065
(440)584-7528
FAX: (440)584-5875

PREPARED FOR:
CIANFAGLIONE BUILDERS, INC.
13842 RADCLIFF ROAD
CHARDON, OHIO 44024

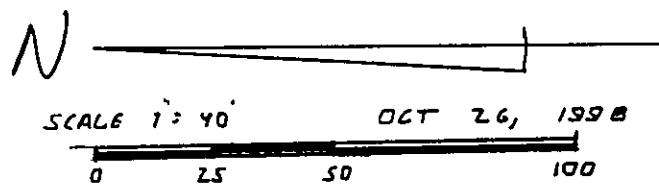

EXISTING UNDERGROUND UTILITIES NOTE:
THE LOCATION BOTH HORIZONTAL AND VERTICAL OF THE UNDERGROUND UTILITIES SHOWN HEREON, HAVE BEEN OBTAINED BY A DILIGENT AND COMPREHENSIVE SEARCH OF AVAILABLE RECORDS. VERIFICATION BY FIELD OBSERVATION HAS BEEN CONDUCTED WHERE PRACTICAL. HOWEVER, RUDY E. SCHWARTZ, P.S. NO. 7193 DOES NOT GUARANTEE THE COMPLETENESS, NOR ACCURACY THEREOF.

Topographic information shown here was obtained from county topographic maps.

LEROY TOWNSHIP
Zoning Approved
2577
Grading Plan Approved
as shown and/or noted
THOMAS P. GILLES, P.E.
Lake County Engineer
Zoning Inspector

By GJH Date 11.3.98

