

ABBEY ROAD - 60'

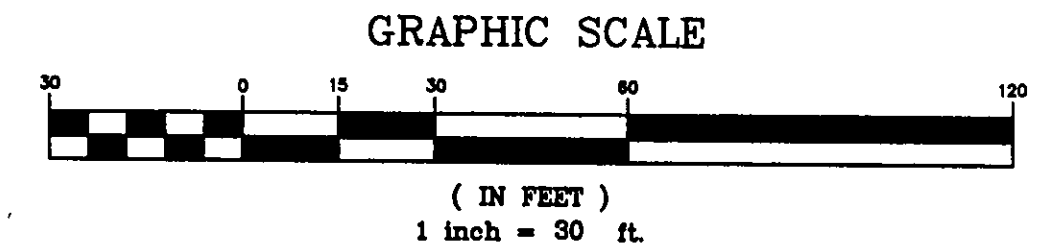
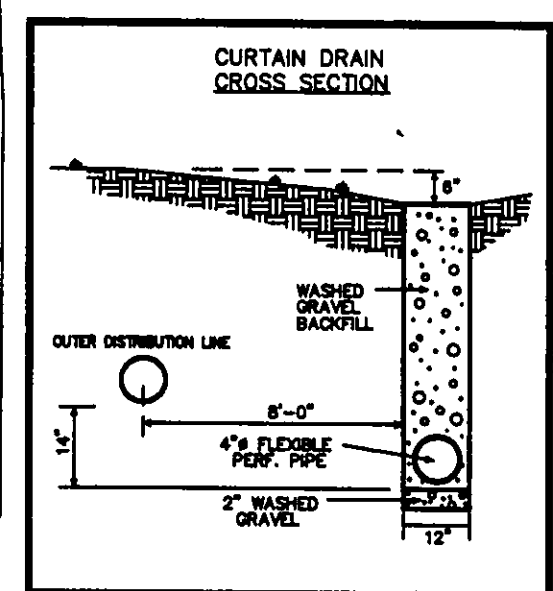
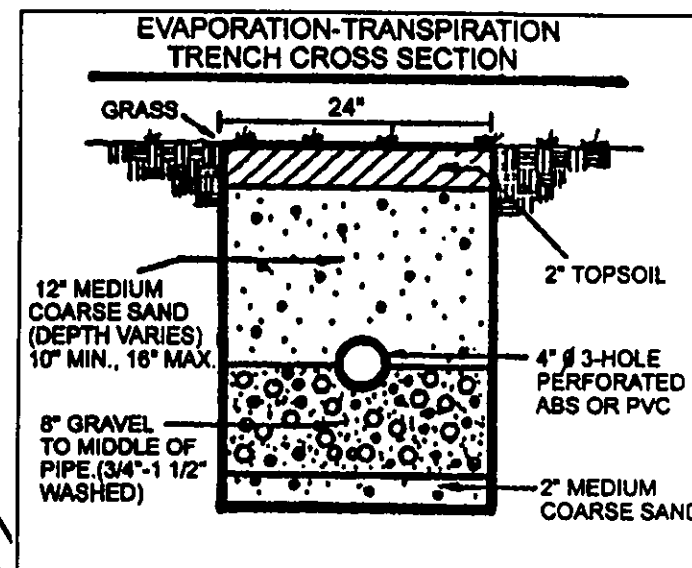

Erosion and Sediment Control Schedule

**Ingress-Egress**  
A stone access drive complete with under lying geo-textile fabric (20 feet wide and 50 feet long) for ingress and egress at the site shall be installed. This drive shall be the only entrance and exit to the site.

**Silt Fence**  
A silt fence shall be installed prior to any earthwork activities at the site in the locations shown on the site plan as well as along the front of any lot that slopes towards the street.

**Temporary Seeding**  
Disturbed areas of the site that are to remain idle for more than twenty-one(21) days shall be properly seeded and straw mulched within seven(7) days of completion of initial grading. Temporary seeding and mulching as a thirty(30) foot strip of the entire front of the lot shall be maintained on the site once initial grading is complete.

**Stabilization of critical areas** within fifty(50) feet of any stream or wetland shall be complete within two(2) days of the disturbance if the site is to remain inactive for longer than fourteen(14) days.

**Mulching**  
Straw-mulch shall be applied at a rate of 1 bale per every ten (10) feet of curb, at a width of thirty(30) feet to the entire length of the lot. Wood chips may also be used but must be spread at a minimum depth of four inches over the thirty-foot width and must be accompanied by a properly installed silt fence.

**Maintenance**  
Erosion and sediment controls shall be inspected every seven(7) days or within 24 hours of a 0.5" or greater rainfall event. Necessary repairs shall be made at this time.

FINAL FOUNDATION PLAN MUST BE SUBMITTED PRIOR TO FINAL HOUSE STAKEOUT

PHILIP & BILLIE WALKER  
7A-43-7

DUPLICATION AREA

DOSING TANK  
2-1000 GAL  
SEPTIC TANKS

FOUR  
URINALS

PHILIP & BILLIE WALKER  
7A-43-31

I, the undersigned hereby certify that this topography indicated by 6", 1" or 2" contours, and elevations shown hereon represent an actual field survey made by me on the 5th day of June 2008 and that the elevations were taken at appropriate intervals and that as of that date they existed as indicated hereon.

Harry J. Gills, P.E.  
Reg. No. 6343

REVIEWED AND ACCEPTED  
LAKE COUNTY GENERAL  
HEALTH DISTRICT

7/18/08 BY [Signature]

SEWAGE DISPOSAL PERMIT MUST BE OBTAINED BY A LAKE COUNTY LICENSED INSTALLER BEFORE INSTALLATION IS STARTED.

LEROT TOWNSHIP  
Zoning Approved

# 4254  
Myron Jones - Zoning Inspector

TBM - 1" IRON PIPE FND @ & @  
ELEV - 850.00

EXISTING UTILITIES NOTE:  
THE SIZE AND LOCATION, BOTH HORIZONTAL AND VERTICAL OF THE UNDERGROUND UTILITIES SHOWN HEREON, HAVE BEEN OBTAINED BY A SEARCH OF AVAILABLE RECORDS. VERIFICATION BY FIELD OBSERVATION HAS BEEN CONDUCTED WHERE PRACTICAL. HOWEVER, BABCOCK, JONES AND ASSOCIATES, INC. DOES NOT GUARANTEE THE COMPLETENESS NOR ACCURACY THEREOF.

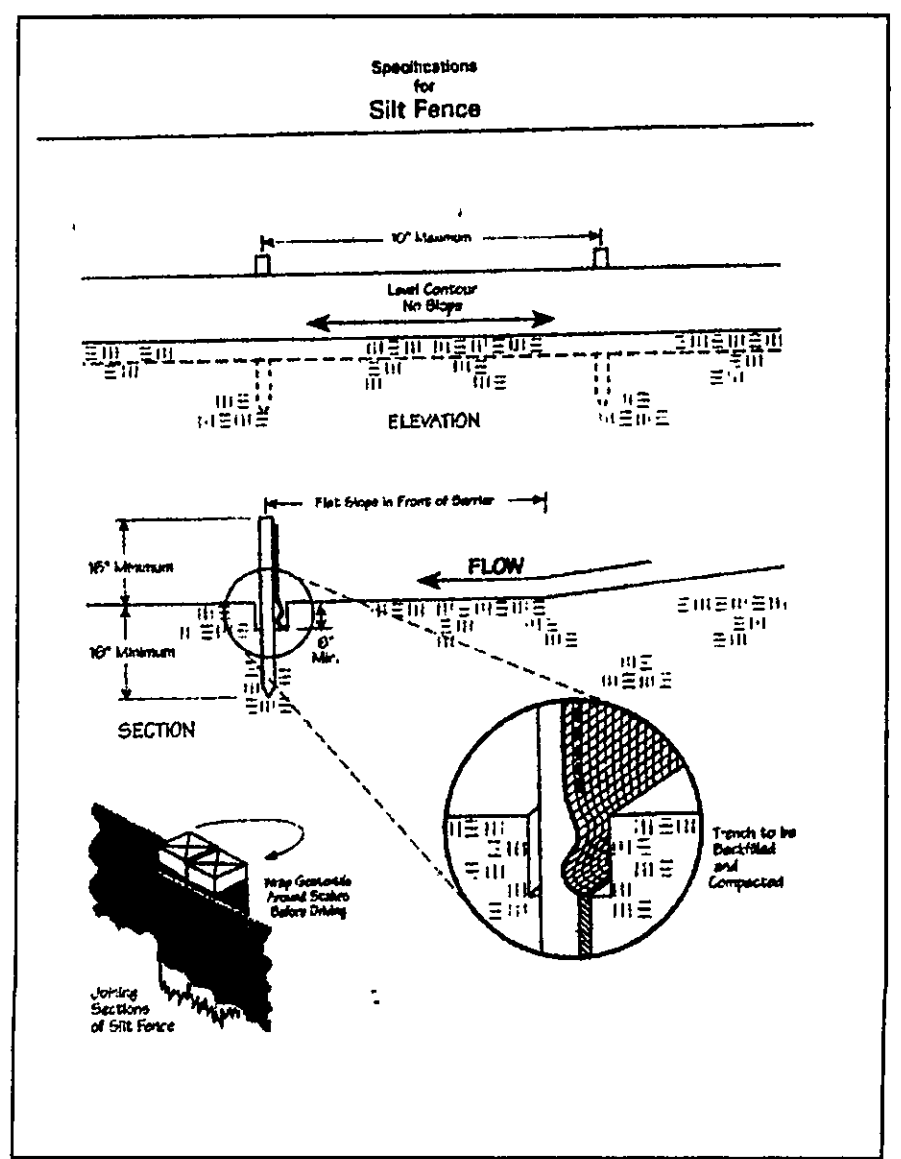

Temporary Seeding Species Selection				
Seeding Dates	Species	Lb./1,000 ft. <sup>2</sup>	Per Ac.	
March 1 to August 15	Grass	3	4 bushel	
	Tall Fescue	1	40 lb.	
	Annual Ryegrass	1	40 lb.	
	Perennial Ryegrass	1	40 lb.	
August 16 to November 1	Rye	3	2 bushel	
	Tall Fescue	1	40 lb.	
	Annual Ryegrass	1	40 lb.	
	Perennial Ryegrass	1	40 lb.	
November 1 to Spring Seeding	Wheat	3	2 bushel	
	Tall Fescue	1	40 lb.	
	Annual Ryegrass	1	40 lb.	
	Perennial Ryegrass	1	40 lb.	
Use mulch only, sodding practices or dormant seeding.				
Note: Other approved seed species may be substituted.				

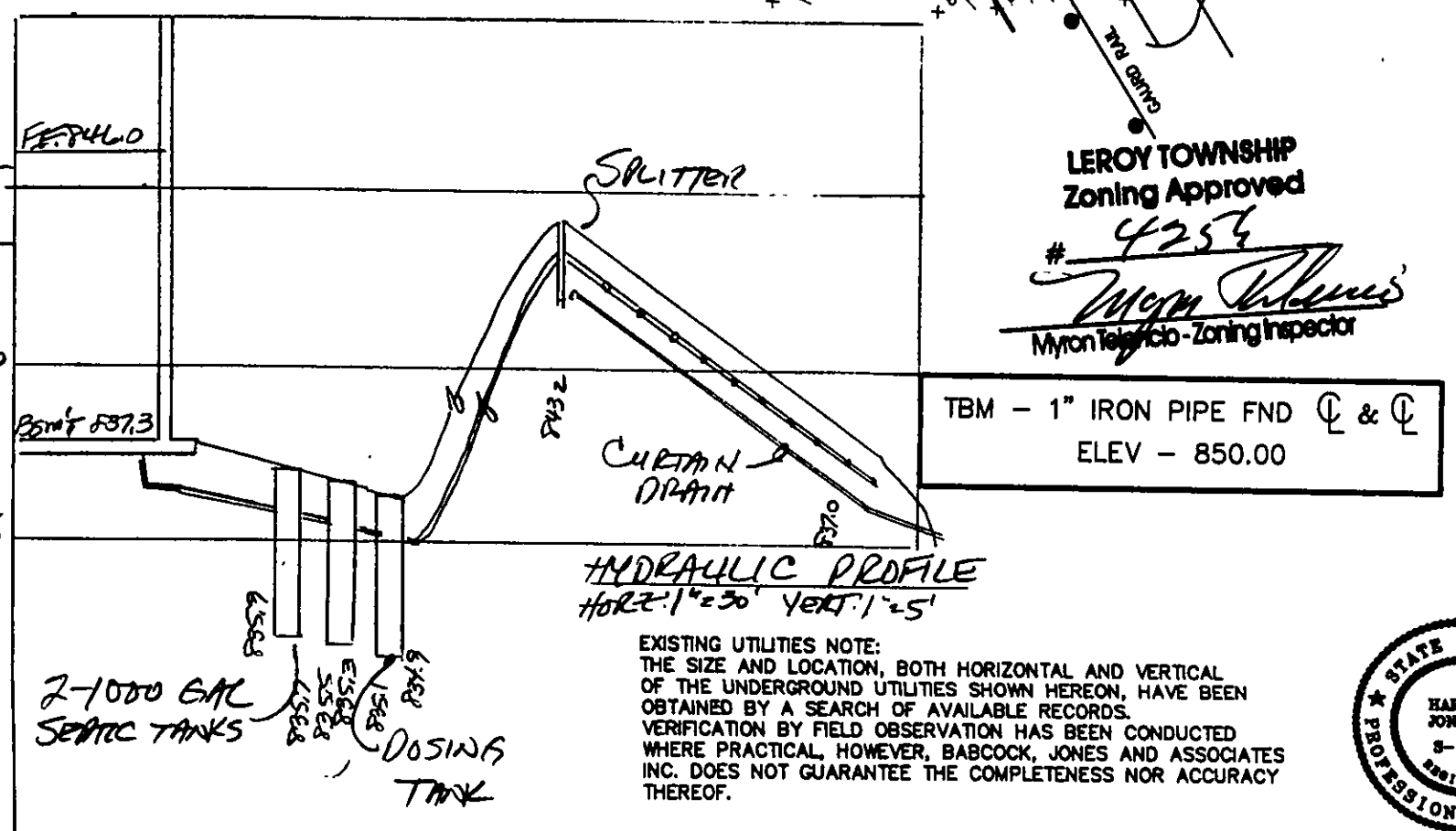
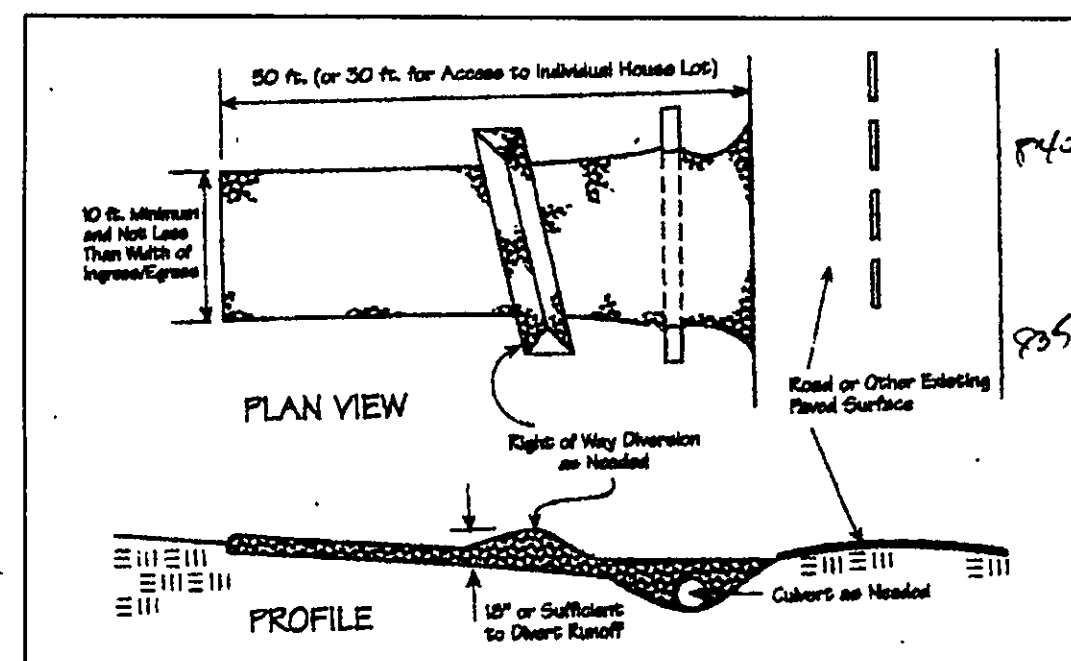
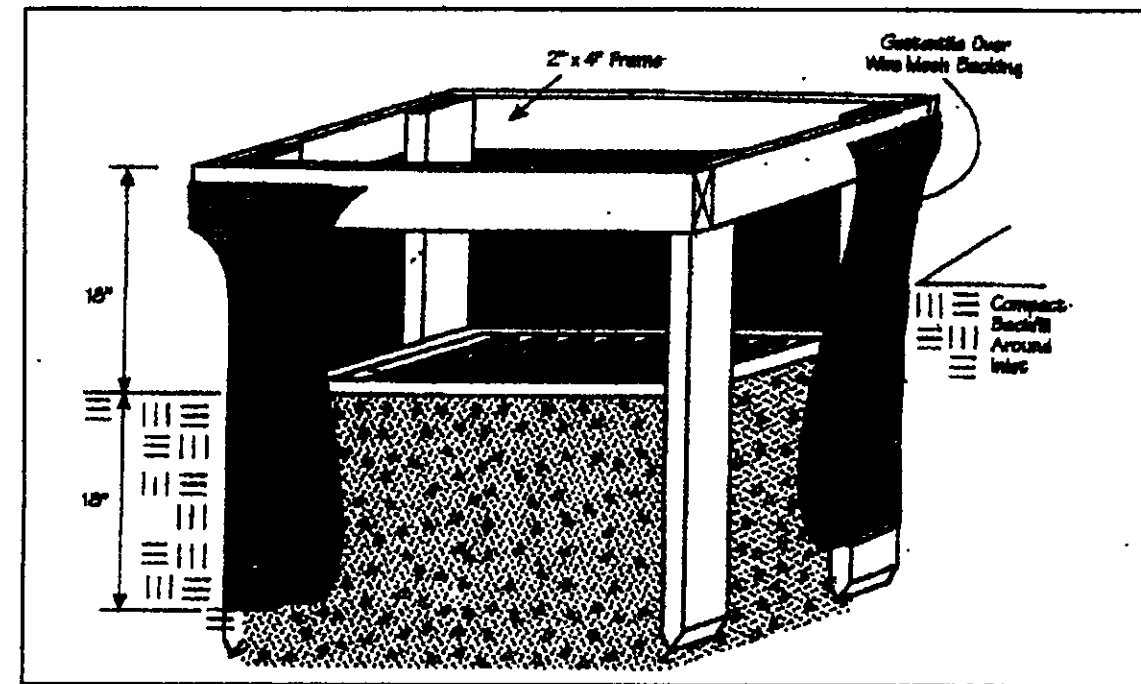

REV. NO.	DESCRIPTION	DATE	BY	CHK'D

**bj** BABCOCK, JONES AND ASSOCIATES, INC.  
CIVIL ENGINEERS - SURVEYORS - LAND PLANNERS  
PAINESVILLE OHIO 44077

DATE 7/3/08  
DESIGN BY H.J.  
DRAWN BY B.P.  
APPROVED BY H.J.  
CHECKED BY W.B.

SITE PLAN FOR PHIL WALKER  
14351 BAKER ROAD (P.P.# 7A-43-7A31)  
LAKE COUNTY  
STATE OF OHIO

SCALE 1"=30'  
JOB NO 08-067  
SHEET 1 OF 1