

EROSION AND SEDIMENT CONTROL SCHEDULE

SILT FENCE
ALL SILT FENCE SHALL BE INSTALLED PRIOR TO ANY EARTHWORK ACTIVITIES AT THE SITE IN THE LOCATIONS SHOWN ON THE SITE PLAN AS WELL AS ALONG THE FRONT OF ANY LOT THAT SLOPES TOWARDS THE STREET.

TEMPORARY SEEDING
DISTURBED AREAS OF THE SITE THAT ARE TO REMAIN IDLE FOR MORE THAN TWENTY-ONE (21) DAYS SHALL BE PROPERLY SEEDDED AND STRAW MULCHED WITHIN SEVEN (7) DAYS OF COMPLETION OF INITIAL GRADING. TEMPORARY SEEDING AND MULCHING OF A THIRTY (30) FOOT STRIP OF THE ENTIRE FRONT OF THE LOT SHALL BE MAINTAINED ON THE SITE ONCE INITIAL GRADING IS COMPLETE.

STABILIZATION OF CRITICAL AREAS WITHIN FIFTY (50) FEET OF ANY STREAM OR WETLAND SHALL BE COMPLETE WITHIN TWO (2) DAYS OF THE DISTURBANCE IF THE SITE IS TO REMAIN INACTIVE FOR LONGER THAN FOURTEEN (14) DAYS.

MULCHING
STRAW-MULCH SHALL BE APPLIED AT A RATE OF 1 BALE PER EVERY TEN (10) FEET OF CURB, AT A WIDTH OF THIRTY (30) FEET OF THE ENTIRE LENGTH OF THE LOT. WOOD CHIPS MAY ALSO BE USED BUT MUST BE SPREAD AT A MINIMUM DEPTH OF FOUR INCHES OVER THE THIRTY-FOOT WIDTH AND MUST BE ACCOMPANIED BY A PROPERLY INSTALLED SILT FENCE.

MAINTENANCE
EROSION AND SEDIMENT CONTROLS SHALL BE INSPECTED EVERY SEVEN (7) DAYS OR WITHIN 24 HOURS OF A 0.5" OR GREATER RAINFALL EVENT. NECESSARY REPAIRS SHALL BE MADE AT THIS TIME.

NOTE:
ALL EROSION AND SEDIMENT CONTROL

ARE BASED OF THE DESCRIPTIONS AND STANDARDS OF THE OHIO DEPARTMENT OF NATURAL RESOURCES "RAINWATER AND LAND DEVELOPMENT MANUAL" AND CAN BE FOUND IN THE LAKE COUNTY EROSION AND SEDIMENT CONTROL RULES AS ADOPTED DECEMBER 21, 1995

THE SPECIFIED EROSION AND SEDIMENT CONTROL STANDARDS ARE GENERAL GUIDELINES AND SHALL NOT LIMIT THE RIGHT OF THE COUNTY TO IMPOSE, AT ANY TIME, ADDITIONAL, MORE STRINGENT REQUIREMENTS. NOR SHALL THE STANDARDS LIMIT THE RIGHT OF THE COUNTY TO WAIVE, IN WRITING, INDIVIDUAL REQUIREMENTS.

EROSION AND SEDIMENT CONTROL SCHEDULE

INGRESS-EGRESS
A STONE ACCESS DRIVE COMPLETE WITH UNDER LYING GEO-TEXTILE FABRIC (20 FEET WIDE AND 50 FEET LONG) FOR INGRESS AND EGRESS AT THE SITE SHALL BE INSTALLED. THIS DRIVE SHALL BE THE ONLY ENTRANCE AND EXIT TO THE SITE

STREETS DIRECTLY ADJACENT TO THE CONSTRUCTION ENTRANCES AND RECEIVING TRAFFIC FROM THE DEVELOPMENT AREA, SHALL BE CLEANED DAILY TO REMOVE SEDIMENT TRACKED OFF-SITE. IF APPLICABLE, THE CATCH BASINS ON THESE STREETS NEAREST TO THE CONSTRUCTION ENTRANCES SHALL BE CLEANED WEEKLY.

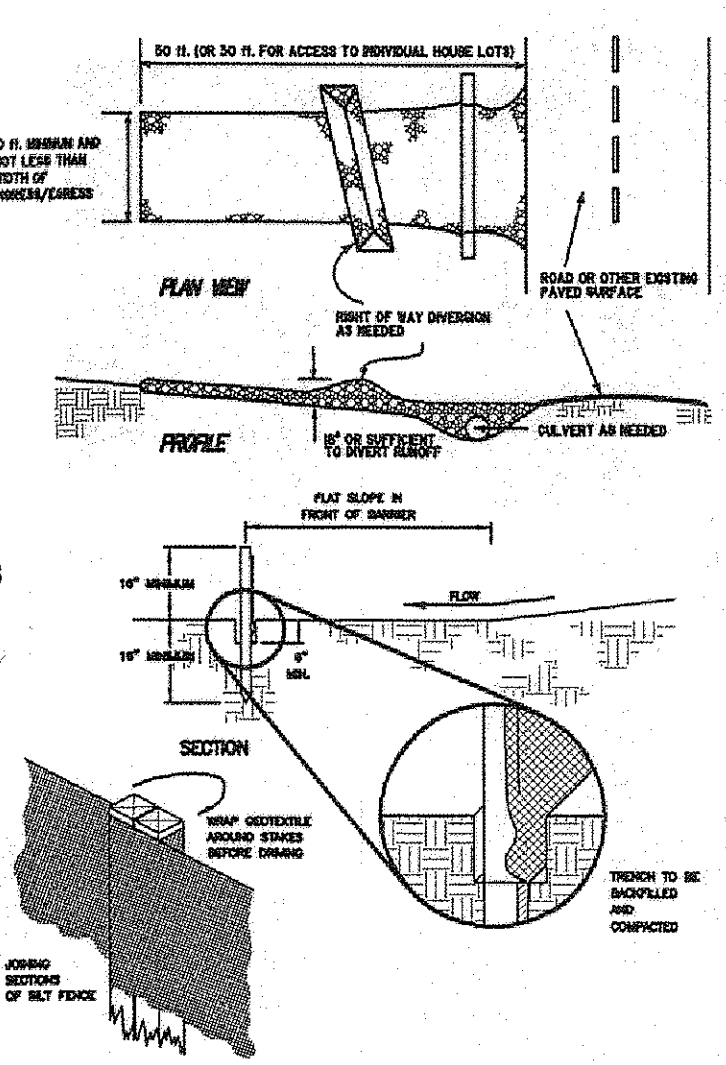

TEMPORARY SEEDING SPECIFICATIONS			
SEEDING DATES	SPECIES	LB./1000 FT.	PER AC.
MARCH 1 TO AUGUST 15	OATS	3	4 BUSHEL
	TALL FESCUE	1	40 LB.
	ANNUAL RYEGRASS	1	40 LB.
	PERENNIAL RYEGRASS	1	40 LB.
	TALL FESCUE	1	40 LB.
	ANNUAL RYEGRASS	1	40 LB.
AUGUST 16 TO NOVEMBER 1	RYE	3	2 BUSHEL
	TALL FESCUE	1	40 LB.
	ANNUAL RYEGRASS	1	40 LB.
	WHEAT	3	2 BUSHEL
	TALL FESCUE	1	40 LB.
	ANNUAL RYEGRASS	1	40 LB.
	PERENNIAL RYEGRASS	1	40 LB.
	TALL FESCUE	1	40 LB.
ANNUAL RYEGRASS	1	40 LB.	
NOVEMBER 1 TO SPRING SEEDING		USE MULCH ONLY, SODDING PRACTICES OR DORMANT SEEDING.	

NOTE: OTHER APPROVED SEED SPECIES MAY BE SUBSTITUTED.

Stormwater Management Plan

JAMES B GILL SPF

County Drainage Engineer
15 8-26-

By L.S. Date 5-28

SEPTIC SYSTEM NOTES

1. ALL ASPECTS OF THE SEPTIC SYSTEM SHALL ADHERE TO THE REGULATIONS OF THE BOARD OF HEALTH OF THE LAKE COUNTY GENERAL HEALTH DISTRICT PART (CHAPTER) 29 "SEWAGE TREATMENT RULES"
2. THE FULL SOIL ABSORPTION AREA SHALL BE FREE OF ANY SITE DISTURBANCE. IF ANY DISTURBANCE OR DAMAGE HAS OCCURRED, INSTALLATION SHALL NOT PROCEED AND THE REGISTERED INSTALLER SHALL CONTACT THE OWNER AND THE BOARD OF HEALTH.
3. THE SYSTEM MUST BE INSTALLED WHEN THE SOILS ARE DRY. THE INSTALLATION OF A SYSTEM IN WET CONDITIONS CAN CAUSE SOIL COMPACTION AND SMEARING WHICH LEADS TO SYSTEM FAILURE.
4. PRIOR TO EXCAVATION, THE REGISTERED INSTALLER SHALL CHECK ALL ELEVATIONS IN THE LAYOUT PLAN RELATIVE TO THE ESTABLISHED BENCHMARK.
5. THE INSTALLER MUST BE REGISTERED AND APPROVED PER O.A.C. 3701.29-04.1.
6. THE SYSTEM INSTALLER SHALL CONSULT WITH THE DESIGNER PRIOR TO ANY INTENDED CHANGES TO THE SYSTEM.
7. THE SYSTEM INSTALLER SHALL COORDINATE WITH THE DESIGNER IN ORDER TO PROVIDE AN ACCURATE AS-BUILT.
8. THE PROPOSED DRIP FIELD AREA AND DISTRIBUTION AREA SHALL BE ROPED OFF PRIOR TO THE START OF ANY CONSTRUCTION TO PREVENT DISTURBANCE TO THE AREAS.
9. THE DRIP MOUNDS SHALL NOT BE INSTALLED WHERE GROUND SLOPES EXCEED 15%.
10. ALL ELECTRICAL WORK SHALL COMPLY WITH THE NATIONAL ELECTRICAL CODE.

THIS PARTICULAR PROJECT WAS DESIGNED FOR A FOUR BEDROOM HOUSE PRODUCING AN AVERAGE FLOW OF 288 GALLONS PER DAY AND HAVING RESIDENTIAL STRENGTH WASTEWATER OF 140 MG/L OF BOD(5). THE SYSTEM DESIGN IS CAPABLE OF ACCOMMODATING PEAK FLOW OF UP TO 480 GALLONS PER DAY AND WASTEWATER STRENGTHS NOT TO EXCEED 250 MG/L OF BOD(5) FOR SHORT PERIODS OF TIME.

GENERAL NOTES:

1. BENCHMARK - TOP STEN OF EXISTING FIRE HYDRANT LOCATED AT THE INTERSECTION OF ORCHARD RD. & STRUMBLEY ALEN. ELEVATION = 928.78.
2. DRIVEWAY APPROX TO BE 6" THICK CONCRETE
3. ALL DOWNSPOUTS TO BE OUTLETTED TO SPLASH BLOCKS.
4. CONTRACTOR RESPONSIBLE FOR CONTACTING THE OHIO UTILITY PROTECTION SERVICE (1.800.362.2764) AND ALL UTILITY COMPANIES A MINIMUM OF 48 HOURS PRIOR TO CONSTRUCTION.
5. THE LOCATION BOTH HORIZONTAL AND VERTICAL OF EXISTING UNDERGROUND UTILITIES SHOWN HEREON, HAVE BEEN OBTAINED BY A DILIGENT AND COMPREHENSIVE SEARCH OF AVAILABLE RECORDS. VERIFICATION BY FIELD OBSERVATION HAS BEEN CONDUCTED WHERE PRACTICAL. HOWEVER, BARRINGTON CONSULTING GROUP, INC. DOES NOT GUARANTEE THE COMPLETENESS, NOR ACCURACY THEREOF.
6. CONTRACTOR SHALL VERIFY ELEVATIONS OF LATERAL INVERTS IN THE FIELD PRIOR TO FOUNDATION EXCAVATION.

CERTIFICATION :

THIS PLAT REPRESENTS A SURVEY WHICH MEETS THE
MINIMUM STANDARDS FOR A BOUNDARY SURVEY IN THE
STATE OF OHIO AS SPECIFIED IN THE ADMINISTRATIVE
CODE CHAPTER 4733-37. SURVEYED ON JULY 21st 2010
UNDER THE SUPERVISION OF DAVID W. NOVAK, P.S. No.
7507. ALL PINS SHOWN WERE EITHER FOUND OR NOTED

"I THE UNDERSIGNED HEREBY CERTIFY THAT THIS TOPOGRAPHY INDICATED BY 1" CONTOURS AND ELEVATIONS SHOWN HEREON REPRESENTS AN ACTUAL SURVEY MADE BY ME ON THE 21st DAY OF JULY, 2010 AND THE ELEVATIONS WERE TAKEN AT APPROPRIATE INTERVALS AND AS OF THAT DAY THEY EXISTED AS INDICATED HEREON.

"I HEREBY CERTIFY THAT THIS PLAN WAS PREPARED BY ME
AND IS CORRECT TO THE BEST OF MY KNOWLEDGE"

DAVID W. NOVAK, P.S. No. 7507

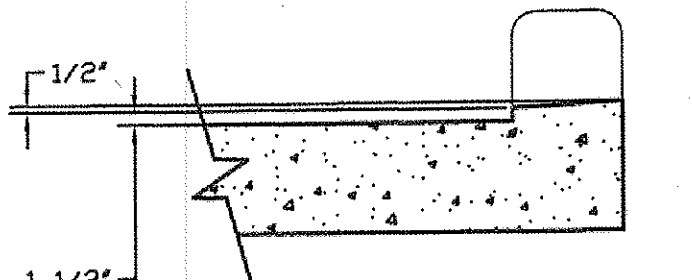
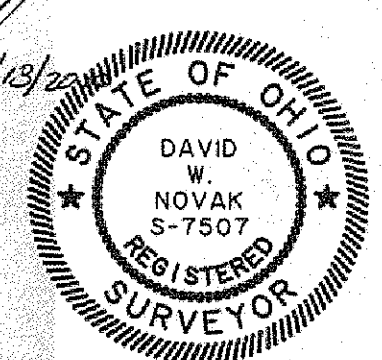

CURB CUT DETAIL