

Erosion and Sediment Control Schedule

Ingress-Egress

A stone access drive complete with under lying geo-textile fabric (20 feet wide and 50 feet long) for ingress and egress at the site shall be installed. This drive shall be the only entrance and exit to the site.

Silt Fence

A silt fence shall be installed prior to any earthwork activities at the site in the locations shown on the site plan as well as along the front of any lot that slopes towards the street.

Temporary Seeding

Disturbed areas of the site that are to remain idle for more than twenty-one(21) days shall be properly seeded and straw mulched within seven(7) days of completion of initial grading. Temporary seeding and mulching on a thirty(30) foot strip of the entire front of the lot shall be maintained on the site once initial grading is complete.

Stabilization of critical areas within fifty(50) feet of any stream or wetland shall be complete within two(2) days of the disturbance if the site is to remain inactive for longer than fourteen(14) days.

Mulching

Straw-mulch shall be applied at a rate of 1 bale per every ten (10) feet of curb, at a width of thirty(30) feet to the entire length of the lot. Wood chips may also be used but must be spread at a minimum depth of four inches over the thirty-foot width and must be accompanied by a properly installed silt fence.

Maintenance

Erosion and sediment controls shall be inspected every seven(7) days or within 24 hours of a 0.5" or greater rainfall event. Necessary repairs shall be made at this time.

"I CERTIFY THIS SEWAGE SYSTEM DESIGN MEETS THE MINIMUM REQUIREMENTS ESTABLISHED BY THE LOGHD IN THE HSTS GUIDANCE MANUAL, AND THE REQUIREMENTS AND RECOMMENDATIONS OF THE SYSTEM MANUFACTURER."

Harry Jones
Reg. No. 6263

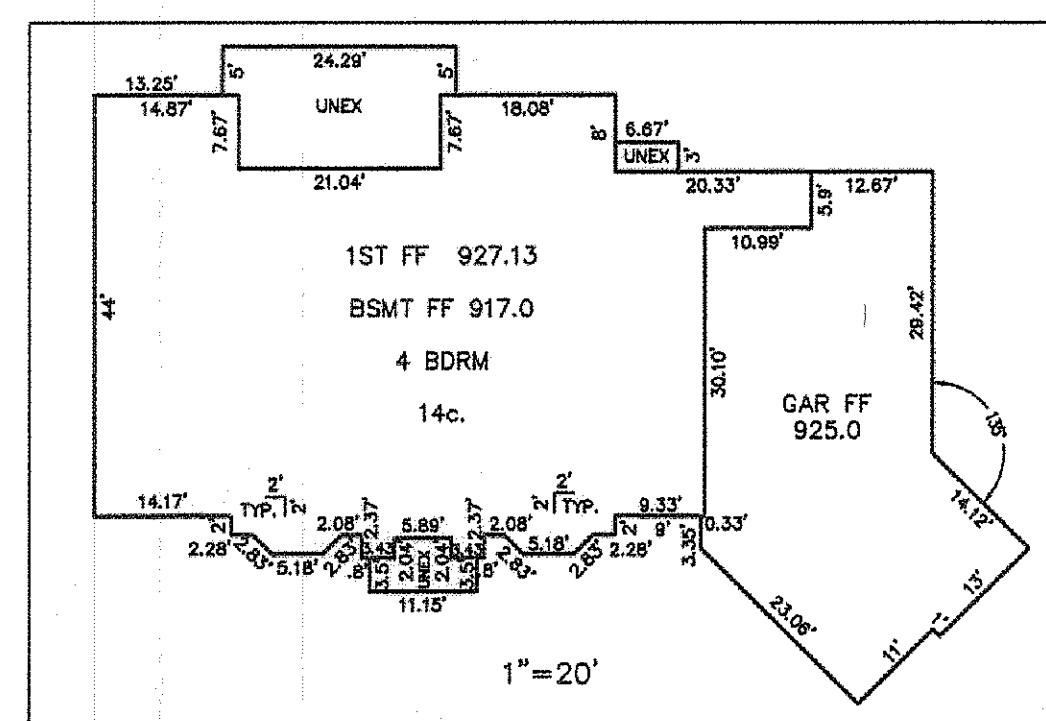

CURVE TABLE					
CURVE	LENGTH	RADIUS	TANGENT	CHORD	BEARING
C1	90.01	70.00	52.44	83.94	N37°58'36"E
					73°40'25"

REV. NO.	DESCRIPTION	DATE	BY	CHK'D
1	ADDED HOUSE & GRADING	1/17/10	B.P.	H.J.



BABCOCK, JONES AND ASSOCIATES, INC.
CIVIL ENGINEERS - SURVEYORS - LAND PLANNERS
PAINESVILLE OHIO 44077

DATE	12/8/09
DESIGN BY	H.J.
DRAWN BY	B.P.
APPROVED BY	H.J.
CREW CHIEF	W.B.

SITE PLAN
FOR
KRAIG KERN

S/L 12 EAGLE CREEK COURT (FOXWOOD FOREST SUB)
CITY OF KIRTLAND LAKE COUNTY STATE OF OHIO

SCALE	1"=30'
JOB NO	04-120-12
SHEET	OF
1	1

EXISTING UTILITIES NOTE:
THE SIZE AND LOCATION, BOTH HORIZONTAL AND VERTICAL OF THE UNDERGROUND UTILITIES SHOWN HEREON, HAVE BEEN OBTAINED BY A SEARCH OF AVAILABLE RECORDS. VERIFICATION BY FIELD OBSERVATION HAS BEEN CONDUCTED WHERE PRACTICAL. HOWEVER, BABCOCK, JONES AND ASSOCIATES, INC. DOES NOT GUARANTEE THE COMPLETENESS NOR ACCURACY THEREOF.



Stormwater Management Plan
Approved as shown and/or noted
JAMES R. GILLS, P.E.
County Drainage Engineer
By L.S. Date 1-21-2010

TBM - IP MONUMENT
ELEV - 908.17

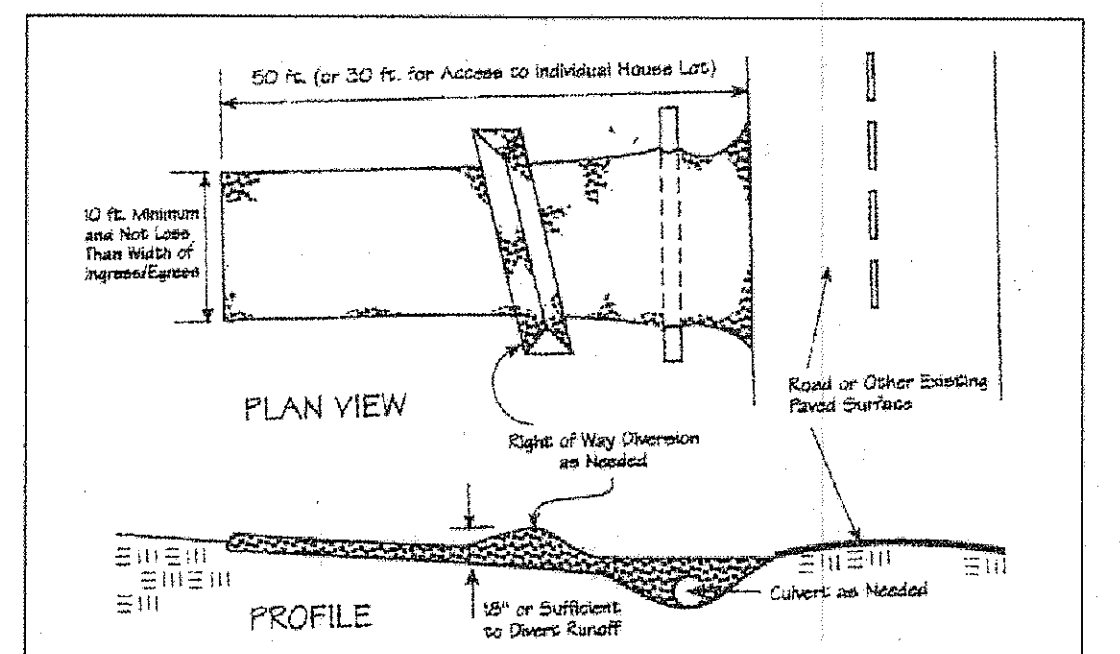

SURVEYOR CERTIFICATION

THIS PLAT REPRESENTS A SURVEY WHICH MEETS STANDARDS FOR A BOUNDARY SURVEY IN THE STATE OF OHIO AS SPECIFIED IN THE ADMINISTRATIVE CODE CHAPTER 4733-37.

SURVEYED ON 12/8/09 BY William Jones UNDER THE SUPERVISION OF Harry Jones P.S.# 6263, ALL IRON PINS SHOWN HEREON WERE EITHER FOUND OR SET AS NOTED.

Harry Jones P.S.# 6263 DATE: 1/17/10

THE (TOPOGRAPHY) INDICATED BY 1' CONTOURS AND ELEVATIONS SHOWN HEREON REPRESENT AN ACTUAL FIELD SURVEY MADE BY William Jones ON 1/17/10. THE ELEVATIONS WERE TAKEN AT APPROPRIATE INTERVALS AND AS OF THE ABOVE DATE THEY EXISTED AS INDICATED HEREON.

Harry Jones P.S.# 6263 DATE: 1/17/10

GRAPHIC SCALE



(IN FEET)
1 inch = 30 ft.

