

- NOTES:
- 1.) PROTECTION OF SEPTIC SYSTEM AND DUPLICATION AREA NEEDS TO BE STAKED.
 - 2.) INSTALLATION OF SEPTIC AREA BY APPROVED LIST OF INSTALLED BY LAKE COUNTY HEALTH DEPARTMENT.
 - 3.) ANY CHANGES OF SEPTIC SYSTEM BY HOMEOWNER OR INSTALLER SHALL BE APPROVED BY DESIGNER.

L.L.R. = 4.3
 2 BEDROOM = 240 GPD
 240 / 4.3 = 56'
 4.3 / 0.8 = 5.4'
 6 LINES @ 56' = 336' TOTAL

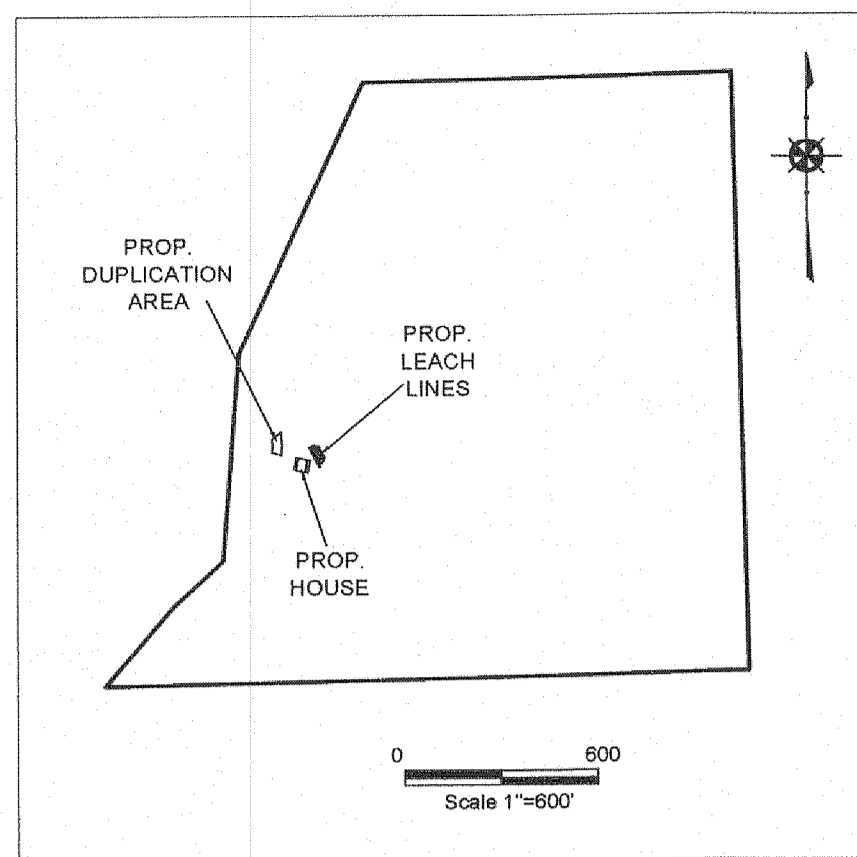

Parage Septic
 3640 Robin-Ton Road SW
 Warren, OH 44481
 Office: 330-947-3321
 Fax: 330-939-7954

1000 Gallon Single & 2 compartment (w/ 2" Straight Divider Wall)

Item	Value	Notes
Tank Length	A = 98.00	(Calc. Based on 1/3 / 2/3)
Tank Width	B = 60.00	
Tank Height	C = 67.00	
Wall Thickness	D = 3.00	*** Except or Override Compartment Dimensions ***
Lid Thickness	E = 4.00	
Floor Thickness	F = 2.00	
Wall Taper	G = 2.00	
Liquid Level	H = 66.00	
Distance In/Out	I = 0.00	
Air Space	J = 10.00	
% of Air Space	K = 10%	
Inside Lght @ Top	L = 64.00	
Inside Lght @ Bot	M = 63.00	
Inside Lght @ Top	N = 79.00	
Inside Lght @ Bot	O = 88.00	
Inside Lght of 1st Comp	P = 41.00	
Inside Lght of 2nd Comp	Q = 41.00	
Lght @ Bot of 1st Comp	R = 38.50	
Lght @ Bot of 2nd Comp	S = 38.50	
Width @ Bottom of Tank	T = 64.00	
Lght @ Bottom of Tank	U = 85.00	
Height	V = 60.00	
Inside Height	W = 63.00	
Outlet Height	X = 63.00	
Space above Inlet	Y = 6.50	
Total Gal. - Single Comp	1854	
Gallons of 1st Comp.	514	
Gallons of 2nd Comp.	514	
Gal. of 1st + 2nd Comp.	1028	
Total Gallons (Full to Lid)	1281	
Volume of Concrete	2 Comp	
Gal/In (Single)	21.1	
Gal/In (1st comp)	10.3	
Gal/In (2nd comp)	10.3	
Weight of Tank	6235.8	6218.9
Weight of Lid	2076.4	2076.4
Total Weight of Tank	2962.4	2962.4
Volume of Concrete	2 Comp	
Tank - Cubic Yards	1.69	1.54
Lid - Cubic Yards	6.53	6.53
Total Cubic Yards	2.52	2.87

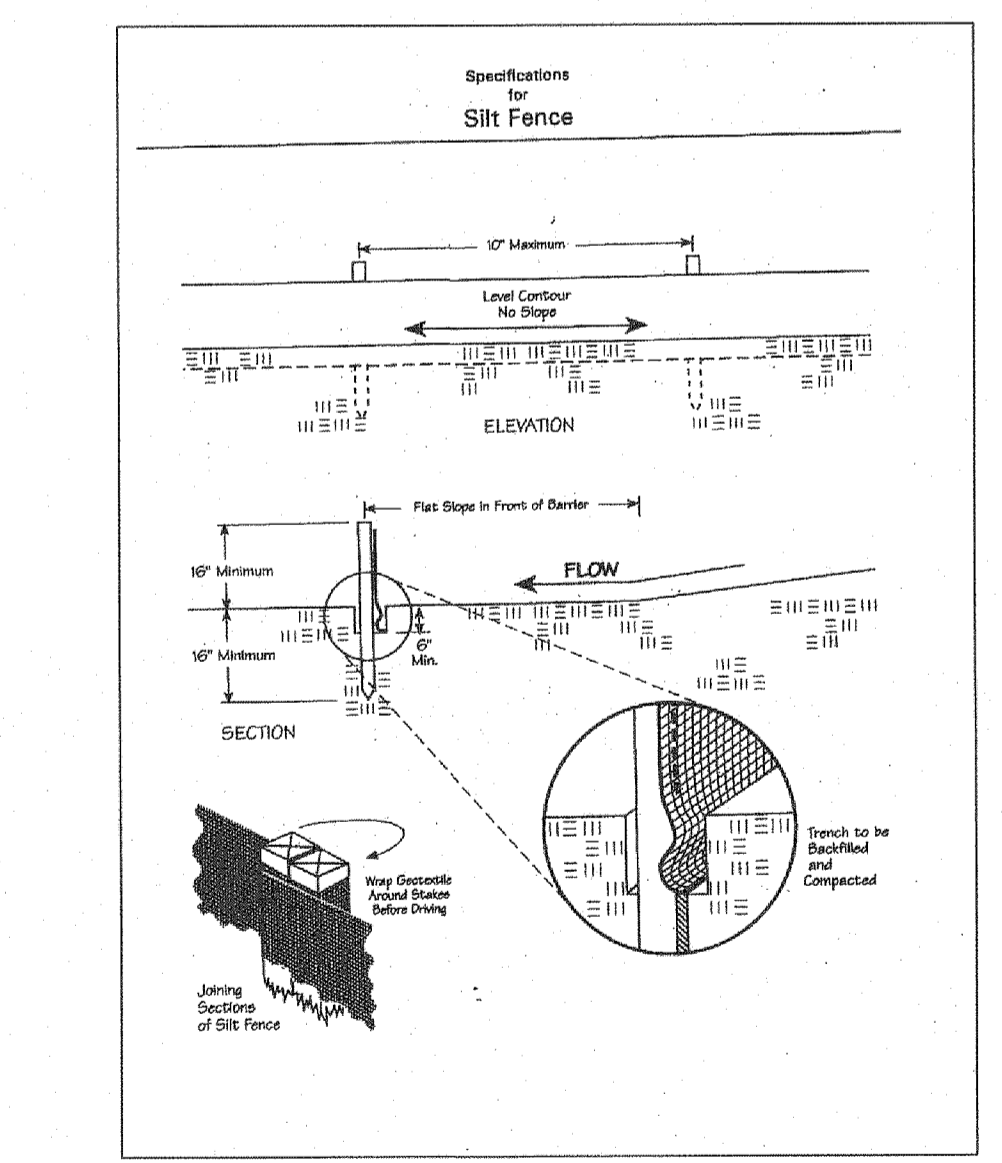
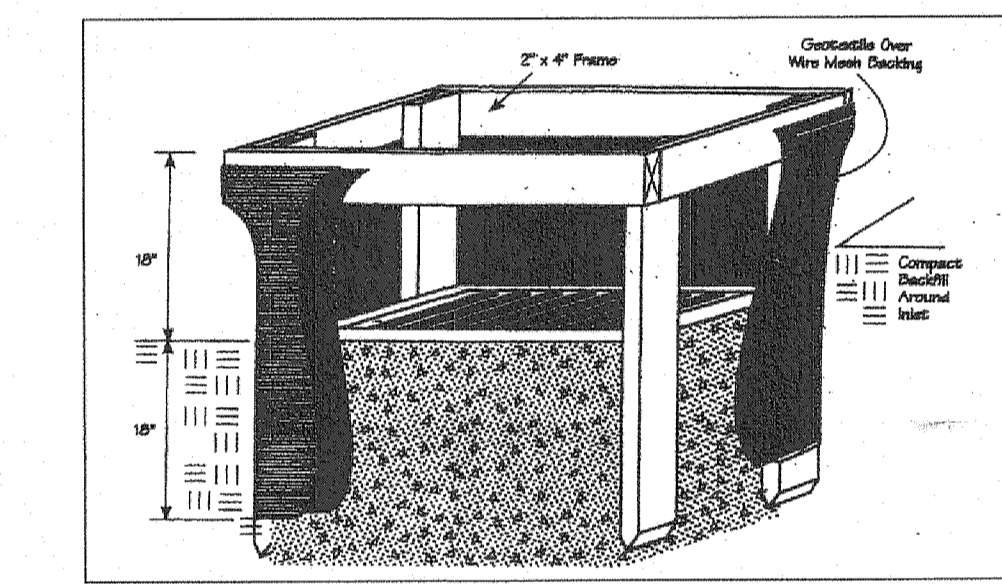
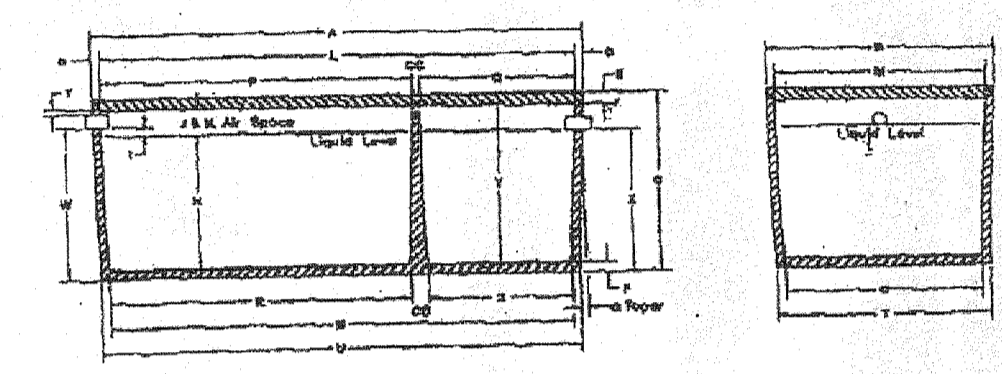

Erosion and Sediment Control Schedule

Ingress-Egress
 A stone access drive complete with under lying geo-textile fabric (20 feet wide and 50 feet long) for ingress and egress at the site shall be installed. This drive shall be the only entrance and exit to the site.

Silt Fence
 A silt fence shall be installed prior to any earthwork activities at the site in the locations shown on the site plan as well as along the front of any lot that slopes towards the street.

Temporary Seeding
 Disturbed areas of the site that are to remain idle for more than fourteen (14) days shall be properly seeded and straw mulched within seven (7) days of completion of initial grading. Temporary seeding and mulching on a thirty (30) foot strip of the entire front of the lot shall be maintained on the site once initial grading is complete.

Stabilization of critical areas within fifty (50) feet of any stream or wetland shall be complete within two (2) days of the disturbance if the site is to remain inactive for longer than fourteen (14) days.

Mulching
 Straw-mulch shall be applied at a rate of 1 bale per every ten (10) feet of curb, at a width of thirty (30) feet to the entire length of the lot. Wood chips may also be used but must be spread at a minimum depth of four inches over the thirty-foot width and must be accompanied by a properly installed silt fence.

Maintenance
 Erosion and sediment controls shall be inspected every seven (7) days or within 24 hours of a 0.5" or greater rainfall event. Necessary repairs shall be made at this time.

"This plan has been prepared solely for the purpose of establishing grading, drainage, location of utility connections, and compliance with local zoning regulations and is based upon plans approved by agencies having jurisdiction. Jones Surveying, LLC does not warrant or guarantee structural components of the structure or the underlying soils".

BENCHMARK:

EXISTING UNDERGROUND UTILITIES NOTE:
 The size and location, both horizontal and vertical, of the underground utilities shown hereon, have been obtained by a diligent and comprehensive search of available records. Verification by field observation has been conducted where practical. However, Jones Surveying, LLC does not guarantee the completeness nor accuracy thereof."

SITE PLAN CERTIFICATION:

This plan was prepared by me and is correct to the best of my knowledge and belief.

I, the undersigned, hereby certify that the topography, indicated by 1' contours, and elevations shown hereon, represent an actual field survey made under my supervision on the 1st day of December 2014, and that the elevations were taken at appropriate intervals and that as of that date they existed as indicated hereon.

Harry S. Jones, Jr. P.E. #6343

I hereby certify that this plan was prepared from a field survey made under my direct supervision. Monuments were found or set as indicated. Dimensions are expressed in feet and decimal parts thereof. All of which are correct to the best of my knowledge and belief. This plan was prepared in accordance with the provisions of Chapter 4733-37 of the Ohio Administrative Code. All Iron Pins Set are 5/8" x 30" long rebar and capped "H. Jones - 6343".

Harry S. Jones, Jr. P.E. #6343

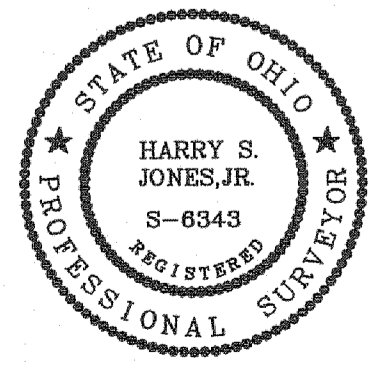

2 WORKING DAYS BEFORE YOU DIG
 CALL TOLL FREE 800-362-2764
 OHIO UTILITIES PROTECTION SERVICE

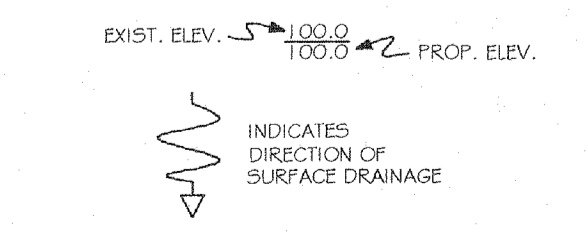

LAT 41°38'36"
 LONG -81°11'46"

WINCHELL ROAD - 60'

JENNIFER LEBLANC
 2011 R027354
 SA-2-7
 65.9573 AC.

"AS BUILT" CERTIFICATION
 I, HEREBY CERTIFY THAT THE CIRCLED GRADES ARE EXISTING FINISH GRADES CHECKED IN THE FIELD ON 11/12/2015 AND ARE CORRECT TO THE BEST OF MY KNOWLEDGE AND BELIEF.
Harry S. Jones, Jr. P.E. #6343

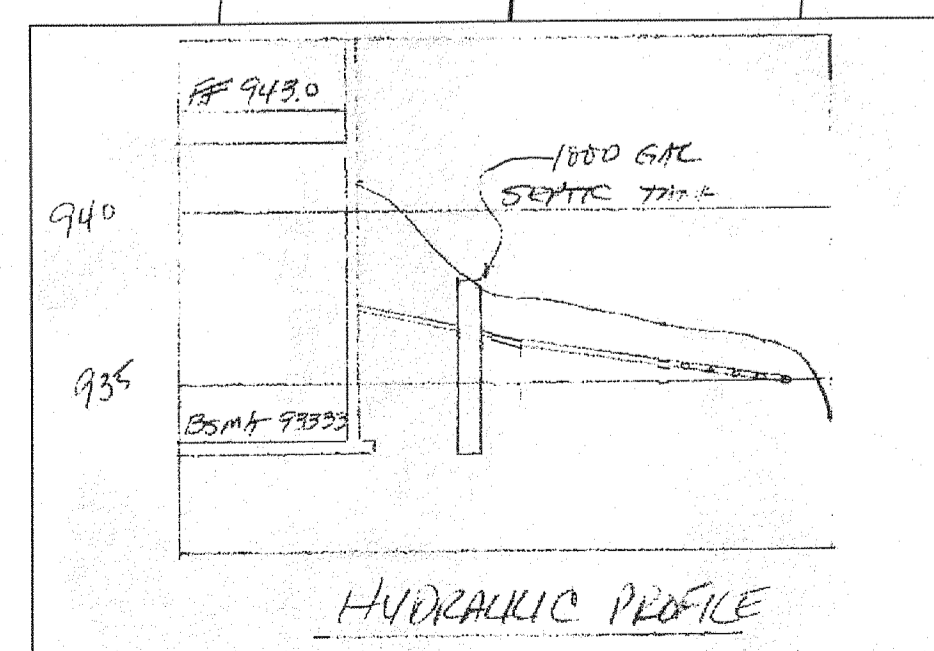

Seeding Date	Species	Lb./1,000 ft. ²	Per Ac.
March 1 to August 15	Oats	3	4 bushel
	Tall Fescue	1	40 lb.
	Annual Ryegrass	1	40 lb.
	Perennial Ryegrass	1	40 lb.
August 16 to November 1	Rye	3	2 bushel
	Tall Fescue	1	40 lb.
	Annual Ryegrass	1	40 lb.
	Perennial Ryegrass	1	40 lb.
November 1 to Spring Seeding	Wheat	3	2 bushel
	Tall Fescue	1	40 lb.
	Annual Ryegrass	1	40 lb.
	Perennial Ryegrass	1	40 lb.

Note: Other approved seed species may be substituted.

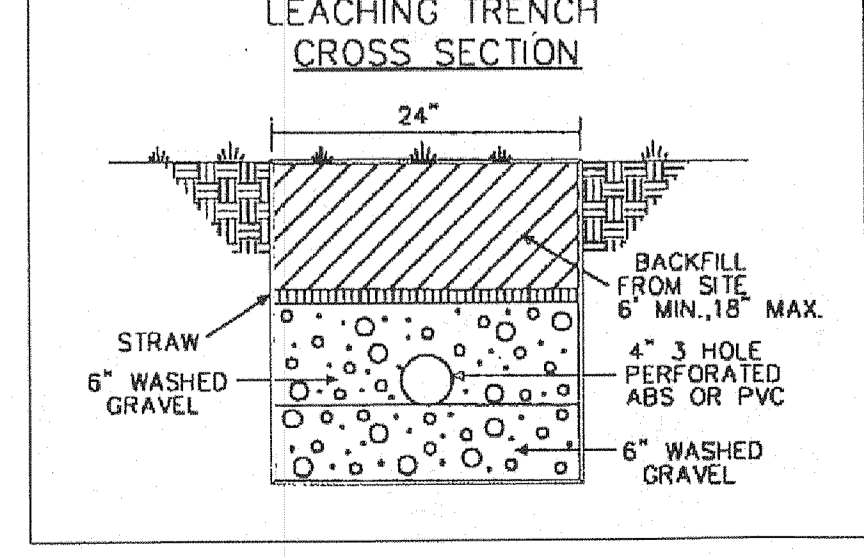
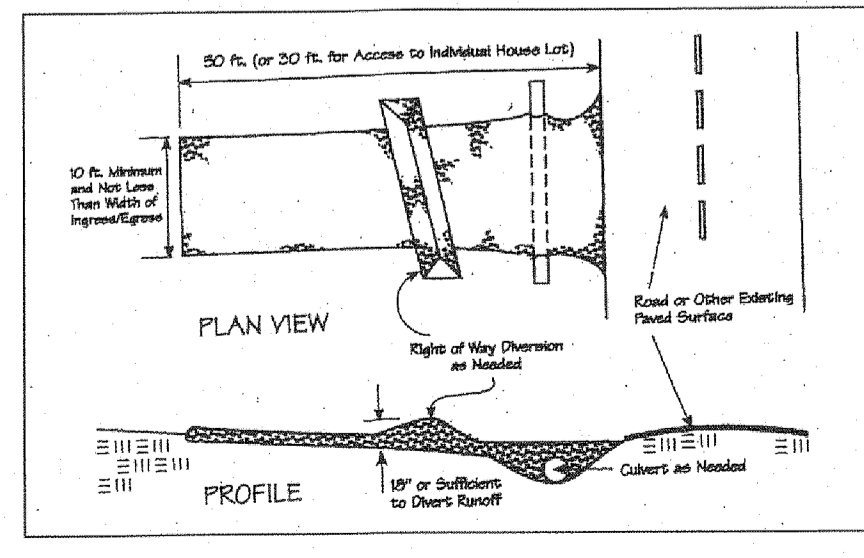

Revisions	
1	2/13/15 (GMB)
2	2/16/15 (GMB)
3	2/23/15 (GMB)
4	2/25/15 (GMB)
5	
6	

Jones Surveying, LLC
 ENGINEERS - SURVEYORS - PLANNERS
 1924 MENTOR AVE., PAINESVILLE, OHIO
 (PH) 440-357-1181 | (FAX) 440-357-9173
 (E-MAIL) hjonesurveying@yahoo.com

Date: 12/29/14
 Scale: Hor. 1"=20'
 Vert.
 Filename: 14-154SITEPL1
 Tab Name:
 Computer: GMB

SITE PLAN
 FOR JENNIFER HEIDEN
 CONCORD TWP. - LAKE COUNTY - OHIO

Sheet 1 of 1
 Contract No. 14-154