

- NOTES:
- 1.) PROTECTION OF SEPTIC SYSTEM AND DUPLICATION AREA NEEDS TO BE STAKED.
  - 2.) INSTALLATION OF SEPTIC AREA BY APPROVED LIST OF INSTALLER BY LAKE COUNTY HEALTH DEPARTMENT.
  - 3.) ANY CHANGES OF SEPTIC SYSTEM BY HOMEOWNER OR INSTALLER SHALL BE APPROVED BY DESIGNER.

L.L.R. = 4.3  
 2 BEDROOM = 240 GPD  
 240 / 4.3 = 56'  
 4.3 / 0.8 = 5.4'  
 6 LINES @ 56' = 336' TOTAL

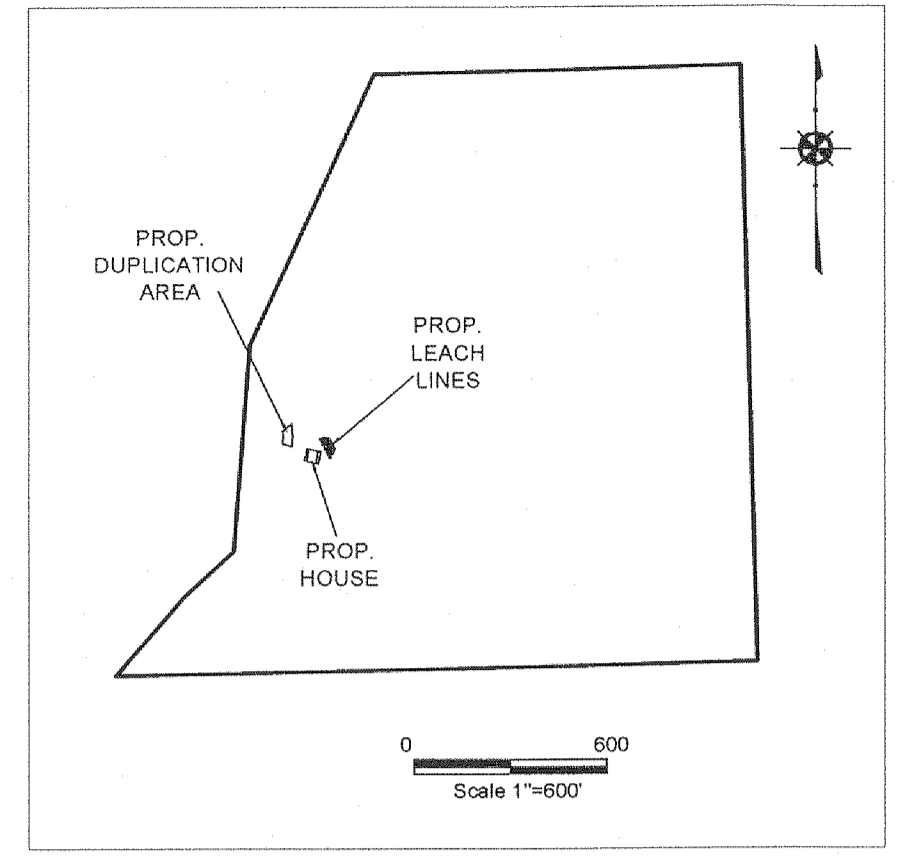

Portage Septic  
 3640 Kibler-Toot Road SW  
 Warren, OH 44481  
 Office: 330-947-3321  
 Fax: 330-389-7554

1000 Gallon Single & 2 compartment (w/ 2" Straight Divider Wall)

\*\*\* Error Dimension in Inches \*\*\*

|                 |           |   |               |
|-----------------|-----------|---|---------------|
| Tank Length     | A = 36.00 | (Calc. Based on 1/3 / 24)                           | Round off to: |
| Tank Width      | B = 48.00 | Length of 1st Comp                                  | 54.67         |
| Tank Height     | C = 67.00 | Length of 2nd Comp                                  | 27.33         |
| Wall Thickness  | D = 3.00  | *** Except or Override Compartment Dimensioning *** |               |
| Lid Thickness   | E = 4.00  | Length of 1st Comp                                  | 41            |
| Floor Thickness | F = 3.00  | Length of 2nd Comp                                  | 41            |
| Wall Taper      | G = 3.00  | Total   | 82            |
| Liquid Level    | H = 60.80 |   |               |
| Distance In/Out | I = 0.00  |   |               |

\*\*\* Air Space \*\*\*

|                             |           |                             |        |
|-----------------------------|-----------|-----------------------------|--------|
| Air Space                   | J = 10.00 | Total Gal. Single Comp      | 1854   |
| % of Air Space              | K = 20%   | Gallons of 1st Comp.        | 514    |
| Length & Width              | L = 84.00 | Gallons of 2nd Comp.        | 514    |
| Inside Lgth @ Top           | M = 83.00 | Gal. of 1st & 2nd Comp.     | 1028   |
| Inside Lgth @ 1st Comp      | N = 79.00 | Total Gallons (Full to Lid) | 1281   |
| Inside Width @ 1st Comp     | O = 88.00 |                             |        |
| Inside Lgth of 1st Comp     | P = 41.00 | Gal/In (Single)             | 21.1   |
| Inside Lgth of 2nd Comp     | Q = 41.00 | Gal/In (1st Comp)           | 16.3   |
| Lgth @ 1st Comp of 1st Comp | R = 38.93 | Gal/In (2nd Comp)           | 16.3   |
| Lgth @ 1st Comp of 2nd Comp | S = 38.93 | Fact Weights                | 2 Comp |
| Width @ Bottom of Tank      | T = 64.80 | Weight of Tank              | 6218.8 |
| Lgth @ Bottom of Tank       | U = 85.89 | Weight of Lid               | 2074.6 |
| Inside Height               | V = 60.00 | Total Weight of Tank        | 8293.4 |
| Inside Height               | W = 83.00 | Locations of Concrete       | 2 Comp |
| Outside Height              | X = 85.89 | Tank - Cubic Yards          | 1.69   |
| Space above Lid             | Y = 6.50  | Lid - Cubic Yards           | 0.53   |
|                             |           | Total Cubic Yards           | 2.22   |
|                             |           | Single Comp                 | 2.97   |

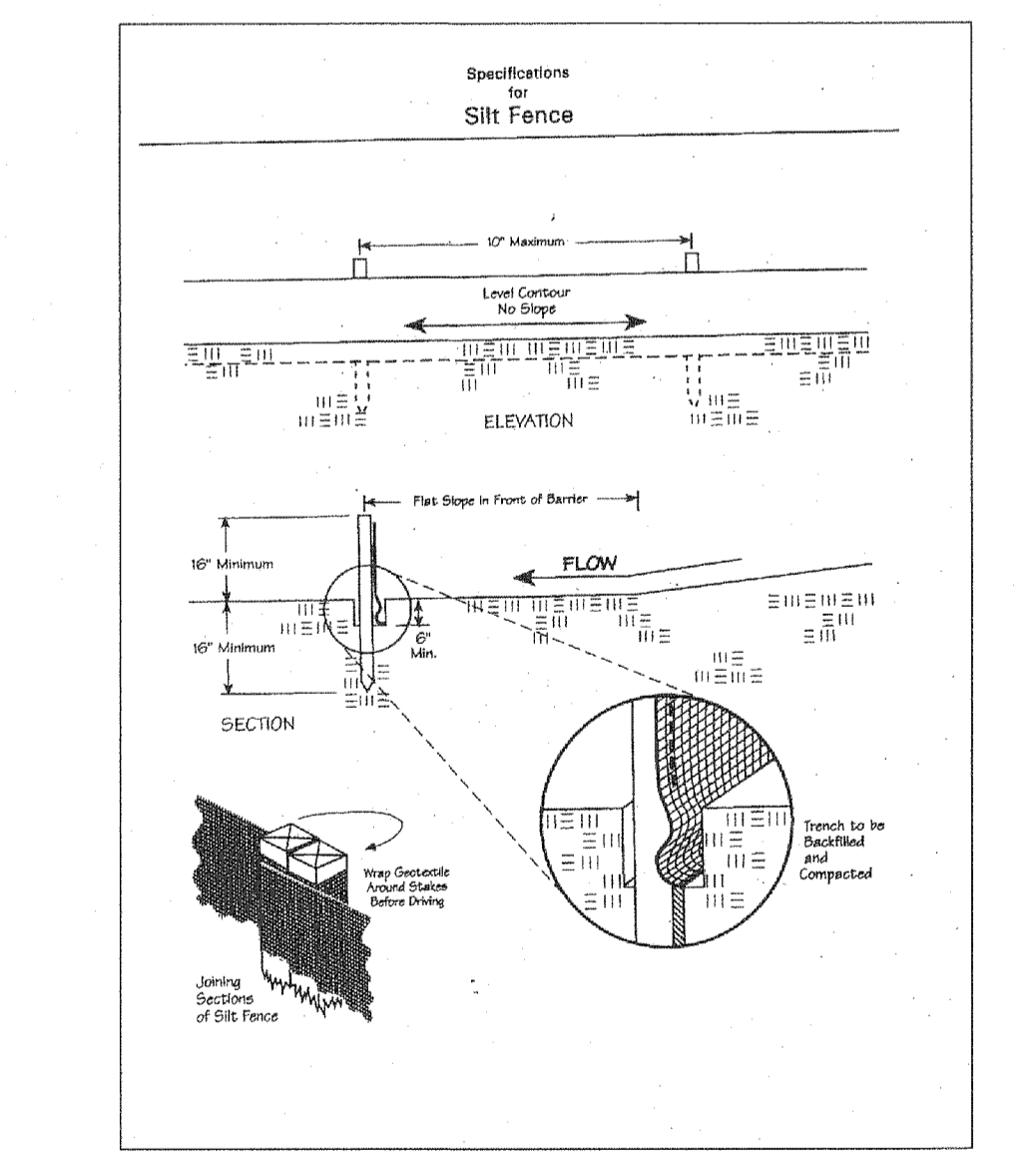
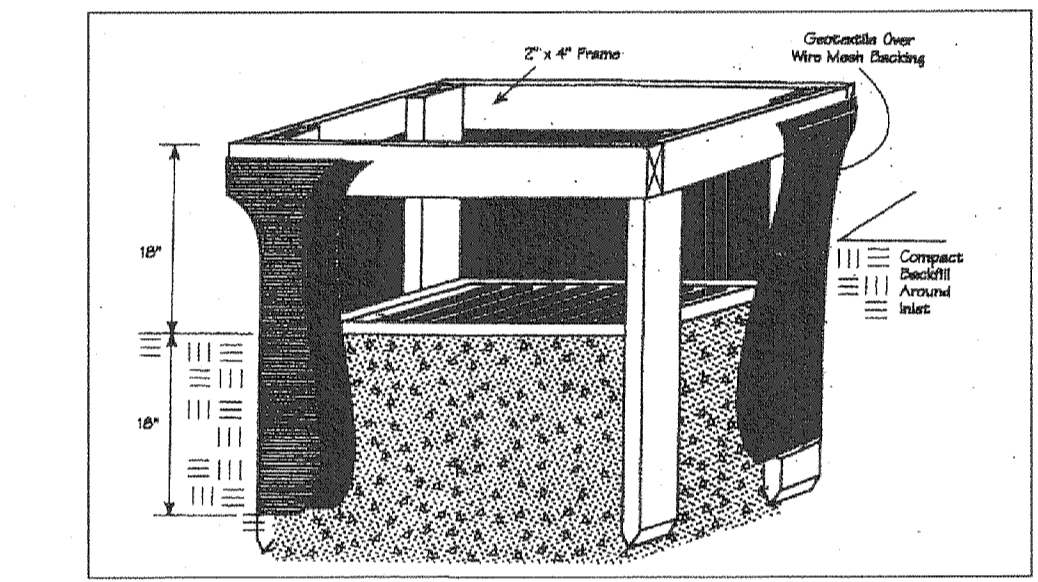
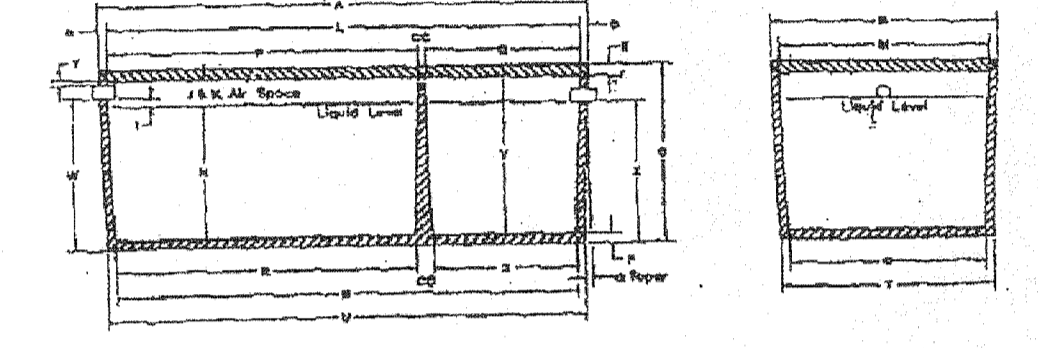

Erosion and Sediment Control Schedule

Ingress-Egress  
 A stone access drive complete with under lying geo-textile fabric (20 feet wide and 50 feet long) for ingress and egress at the site shall be installed. This drive shall be the only entrance and exit to the site.

Silt Fence  
 A silt fence shall be installed prior to any earthwork activities at the site in the locations shown on the site plan as well as along the front of any lot that slopes towards the street.

Temporary Seeding  
 Disturbed areas of the site that are to remain idle for more than fourteen (14) days shall be properly seeded and straw mulched within seven (7) days of completion of initial grading. Temporary seeding and mulching as a thirty (30) foot strip of the entire front of the lot shall be maintained on the site once initial grading is complete.

Stabilization of critical areas within fifty (50) feet of any stream or wetland shall be complete within two (2) days of the disturbance if the site is to remain inactive for longer than fourteen (14) days.

Mulching  
 Straw-mulch shall be applied at a rate of 1 bale per every ten (10) feet of curb, at a width of thirty (30) feet to the entire length of the lot. Wood chips may also be used but must be spread at a minimum depth of four inches over the thirty-foot width and must be accompanied by a properly installed silt fence.

Maintenance  
 Erosion and sediment controls shall be inspected every seven (7) days or within 24 hours of a 0.5" or greater rainfall event. Necessary repairs shall be made at this time.

"This plan has been prepared solely for the purpose of establishing grading, drainage, location of utility connections, and compliance with local zoning regulations and is based upon plans approved by agencies having jurisdiction. Jones Surveying, LLC does not warrant or guarantee structural components of the structure or the underlying soils."

BENCHMARK:  
 EXISTING UNDERGROUND UTILITIES NOTE:  
 "The size and location, both horizontal and vertical, of the underground utilities shown hereon, have been obtained by a diligent and comprehensive search of available records. Verification by field observation has been conducted where practical. However, Jones Surveying, LLC does not guarantee the completeness nor accuracy thereof."

SITE PLAN CERTIFICATION:  
 This plan was prepared by me and is correct to the best of my knowledge and belief.

I, the undersigned, hereby certify that this topography, indicated by 1' contours, and elevations shown hereon, represent an actual field survey made under my supervision on the 1st day of December 2014, and that the elevations were taken at appropriate intervals and that as of that date they existed as indicated hereon.

I hereby certify that this plan was prepared from a field survey made under my direct supervision. Monuments were found or set as indicated. Dimensions are expressed in feet and decimal parts thereof. All of which are correct to the best of my knowledge and belief. This plan was prepared in accordance with the provisions of Chapter 4733-37 of the Ohio Administrative Code. All Iron Pins Set are 5/8" x 30" long rebar and capped "H. Jones - G343".

WINCHELL ROAD - 60'

LAT 41°38'36"  
 LONG -81°11'46"

JENNIFER LEBLANC  
 2011R027354  
 6A-2-7  
 65.9573 AC.

Lake County General Health District  
 Reviewed and Accepted by:  
 Date 2-16-15

WATER WELL TO BE USED FOR NEW HOME

Approved MA  
 File #005415021  
 Date 08/25/15  
 Lake SWCD

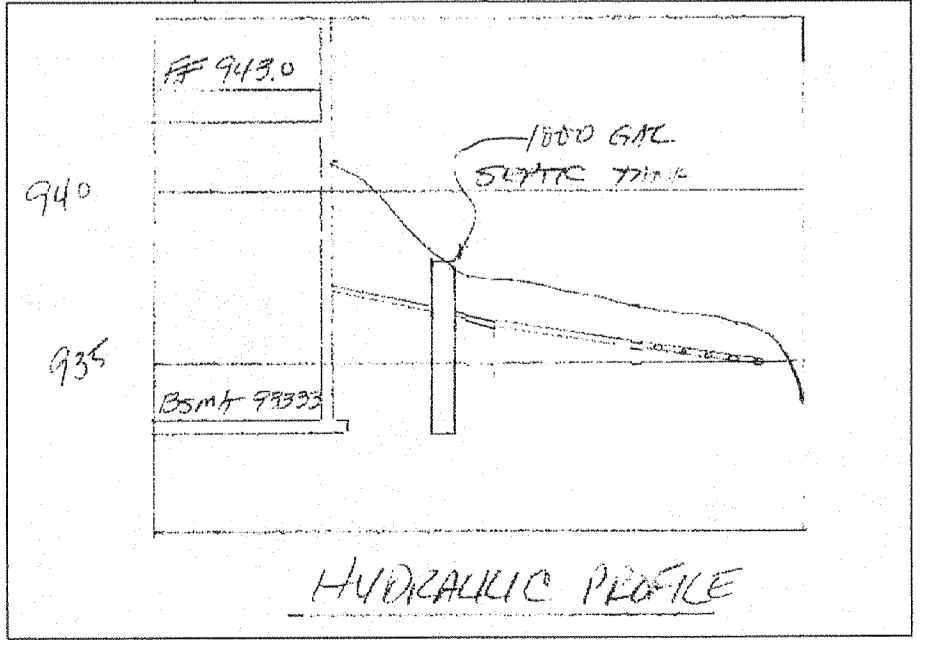

Temporary Seeding Species Selection

| Seeding Dates                | Species            | Lb./1,000 ft. <sup>2</sup> | Per Ac.  |
|------------------------------|--------------------|----------------------------|----------|
| March 1 to August 15         | Oats               | 3                          | 4 bushel |
|                              | Tall Fescue        | 1                          | 40 lb.   |
|                              | Annual Ryegrass    | 1                          | 40 lb.   |
|                              | Perennial Ryegrass | 1                          | 40 lb.   |
| August 16 to November 1      | Rye                | 3                          | 2 bushel |
|                              | Tall Fescue        | 1                          | 40 lb.   |
|                              | Annual Ryegrass    | 1                          | 40 lb.   |
|                              | Perennial Ryegrass | 1                          | 40 lb.   |
| November 1 to Spring Seeding | Wheat              | 3                          | 2 bushel |
|                              | Tall Fescue        | 1                          | 40 lb.   |
|                              | Annual Ryegrass    | 1                          | 40 lb.   |
|                              | Perennial Ryegrass | 1                          | 40 lb.   |

Note: Other approved seed species may be substituted.

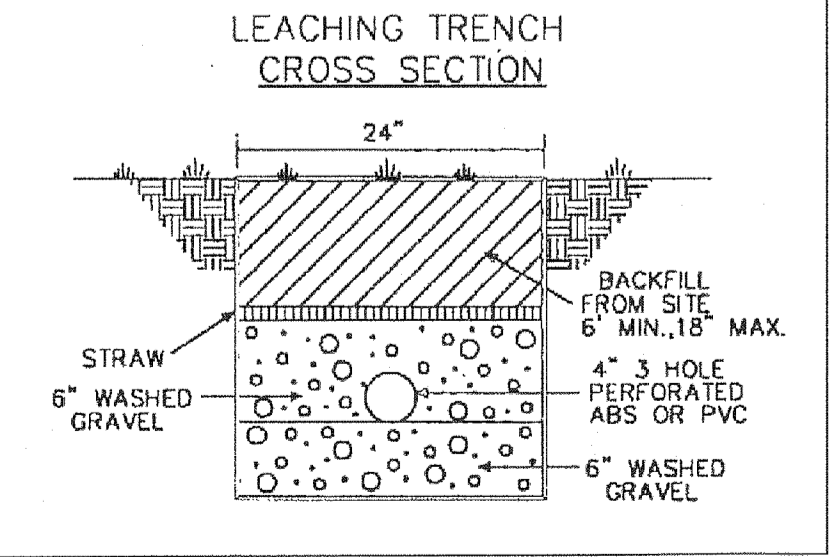
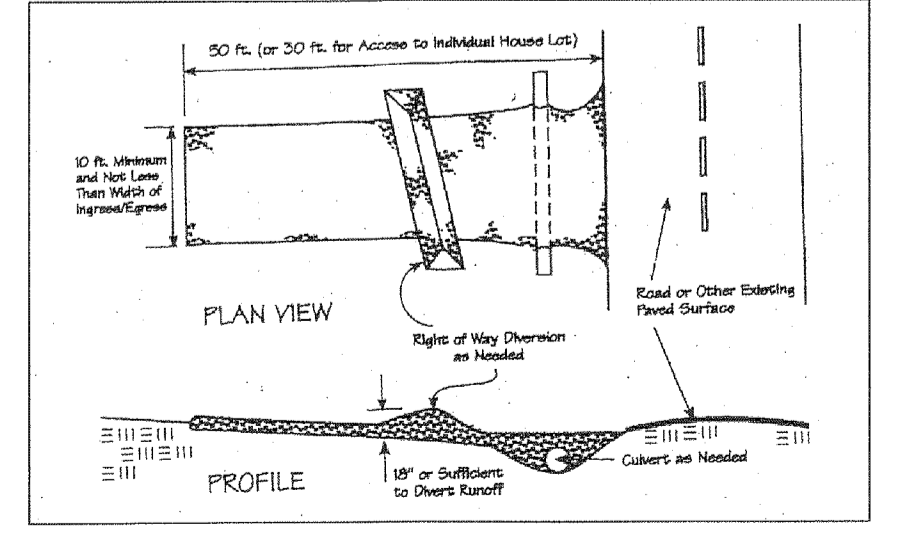

2 WORKING DAYS BEFORE YOU DIG  
 CALL TOLL FREE 800-362-2764  
 OHIO UTILITIES PROTECTION SERVICE

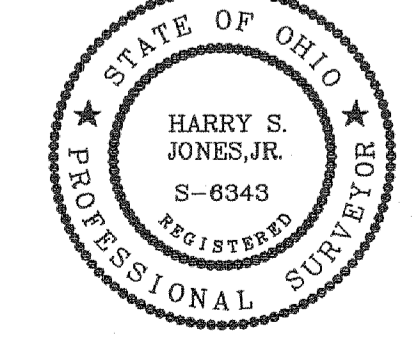

Revisions

|   |               |
|---|---------------|
| 1 | 2/13/15 (GMB) |
| 2 | 2/16/15 (GMB) |
| 3 | 2/23/15 (GMB) |
| 4 | 2/25/15 (GMB) |
| 5 |               |
| 6 |               |

INDEX

|   |           |
|---|-----------|
| 1 | SITE PLAN |
| 2 |           |
| 3 |           |
| 4 |           |
| 5 |           |
| 6 |           |

Jones Surveying, LLC  
 ENGINEERS - SURVEYORS - PLANNERS  
 1924 MENTOR AVE., PAINESVILLE, OHIO  
 (PH) 440-357-1811 (FAX) 440-357-9173  
 (E-MAIL) jhsurveying@yahoo.com

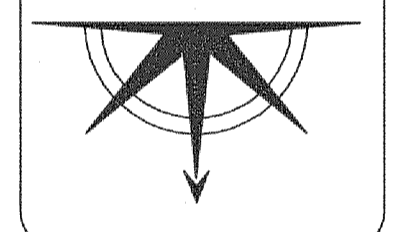

Date: 12/29/14  
 Scale: Hor. 1"=20'  
 Vert. 1"=10'  
 Filename: 14-154SITEPL1  
 Tab Name:  
 Computer: GMB

SITE PLAN  
 FOR JENNIFER HEIDEN  
 CONCORD TWP. - LAKE COUNTY - OHIO

Sheet 1 of 1  
 Contract No. 14-154