

SITE PLAN

for: 20th CENTURY CONSTRUCTION
 2167 MENTOR AVENUE PAINESVILLE
 ADDRESS STREET CITY
 85 SUMMERWOOD 54 - 28
 SUBLOT No. SUBDIVISION NAME VOL. PAGE
 CONCORD OHIO
 LOT CITY

GUTOSKEY & ASSOCIATES INC.
 Civil Engineers, Surveyors & Land Planners
 17078 Munn Road, Suite 3 Tel (440) 543-6900
 Chagrin Falls, Ohio 44023 Fax (440) 543-7176

CHECK LIST

LOT DIMENSIONS & BEARINGS
 TO NEAREST STREET
 SUBLOT No. (PARCEL No.)
 SURROUNDING OWNERS
 BUILDING DIMENSIONS
 SETBACK, SIDEYARD, REARYARD
 FINISHED GRADES
 DRIVE & APRON TYPE, WIDTH, THICKNESS
 SIDEWALK TYPE, WIDTH, THICKNESS
 CULVERT TYPE, DIAM., LENGTH
 WATER MAIN SIZE, LOCATION
 SAN. SEWER SIZE, % GRADE, LOCATION
 SAN. M.H. CAST. ELEV., INV. ELEV.
 SAN. CONN. SIZE, % GRADE, LOCATION
 STORM SEWER SIZE, % GRADE, LOCATION
 STORM M.H. CAST. ELEV., INV. ELEV.
 PAVT. TYPE, GRADE, CURBS
 GAS LINE LOC. SIZE
 SEPTIC SYSTEM & DUPLICATION
 WELL LOCATION & ISOLATION RADIUS



STATE SEAL

DESIGN CERTIFICATION

THIS PLAT WAS PREPARED BY ME, AND IS CORRECT
 TO THE BEST OF MY KNOWLEDGE.

Joseph Gutoskey PS 3/19/08
 JOSEPH GUTOSKEY P.S. #7567 DATE

"AS-BUILT" CERTIFICATION

I HEREBY CERTIFY THAT THE CIRCLED INFORMATION IS EXISTING
 AS OBTAINED ON THE SITE 20 AND IS
 CORRECT TO THE BEST OF MY KNOWLEDGE AND BELIEF.

JOSEPH GUTOSKEY P.S. #7567

LEGEND

STORM MAIN X
 SANITARY MAIN X
 EXISTING CONTOURS
 PROPOSED CONTOURS
 EXIST. ELEV. 100.0
 100.0 PROP. ELEV.
 DIRECTION OF SURFACE DRAINAGE

DRAWN BY JK
 CHK'D BY JG
 DATE 3/2008
 REV.

Erosion and Sediment Control Schedule

Ingress-Egress
 A stone access drive complete with under lying geo-textile fabric (20 feet wide and 50 feet long) for ingress and egress at the site shall be installed. This drive shall be the only entrance and exit to the site.

Silt Fence
 All silt fence shall be installed prior to any earthwork activities at the site in the locations shown on the site plan as well as along the front of any lot that slopes towards the street.

Temporary Seeding
 Disturbed areas of the site that are to remain idle for more than Twenty-one (21) days shall be properly seeded and straw mulched within seven (7) days of completion of initial grading. Temporary seeding and mulching of a thirty (30) foot strip of the entire front of the lot shall be maintained on the site once initial grading is complete.

Stabilization of critical areas within fifty (50) feet of any stream or wetland shall be complete within two (2) days of the disturbance if the site is to remain inactive for longer than fourteen (14) days.

Mulching
 Straw-mulch shall be applied at a rate of 1 bale per every ten (10) feet of curb, at a width of thirty (30) feet of the entire length of the lot. Wood chips may also be used but must be spread at a minimum depth of four inches over the thirty-foot width and must be accompanied by a properly installed silt fence.

Maintenance
 Erosion and sediment controls shall be inspected every seven (7) days or within 24 hours of a 0.5" or greater rainfall event. Necessary repairs shall be made at this time.

Construction Entrance Detail

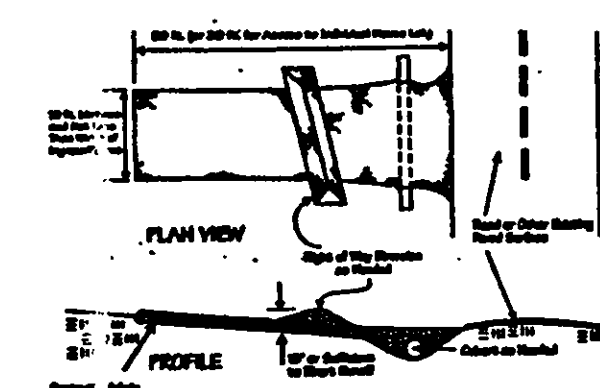

Silt Fence Detail

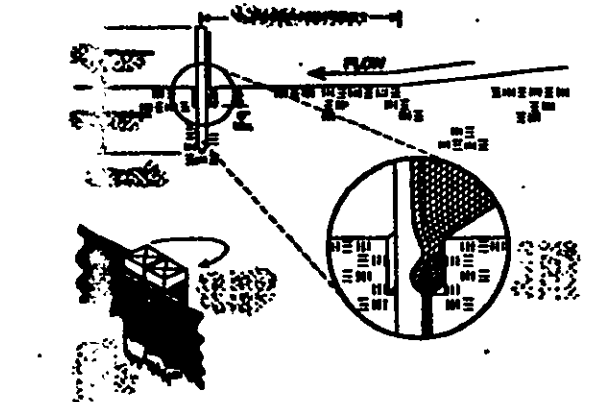

Stormwater Management Plan
 Approved as shown and/or noted
 JAMES R. GILLS, P.E.
 County Drainage Engineer
 Date 4/1/2008

CONTRACT NO.
 05-2000-85

NOTE: SEEDING OR MULCHING SHALL BE COMPLETED WITHIN 30 DAYS OF COMPLETION OF HOUSE.

LIMIT OF DISTURBANCE: ALL OF LOT.

■ = TEMP. SEEDING & MULCHING

BENCHMARK: TOP NUT HYDRANT
 ELEV. 1059.02

SILT FENCE x x x

● = 5/8" IRON PIN SET

* DRIVE APRON SHALL BE 6" THICK CONCRETE.

2 WORKING DAYS BEFORE YOU DIG
 CALL TOLL FREE 800-362-2764
 OHIO UTILITIES PROTECTION SERVICE

CONTRACTOR SHALL VERIFY ELEVATIONS OF LATERAL INVERTS IN THE FIELD AT THE TIME OF FOUNDATION EXCAVATION.

CONCORD TOWNSHIP ZONING OFFICE
 Zoning Permit # 0308-13427
 Date Issued 3/27/08
 Subject to Approval By:
☒ Lake Co. Engineer/Storm Water Mgmt.
☒ Lake Co. Utilities Dept.
☒ Lake Co. Soil + Water District
☒ Lake Co. Health District
☒ Lake Co. Building Dept.

S/L 86

S/L 84
 (VACANT)

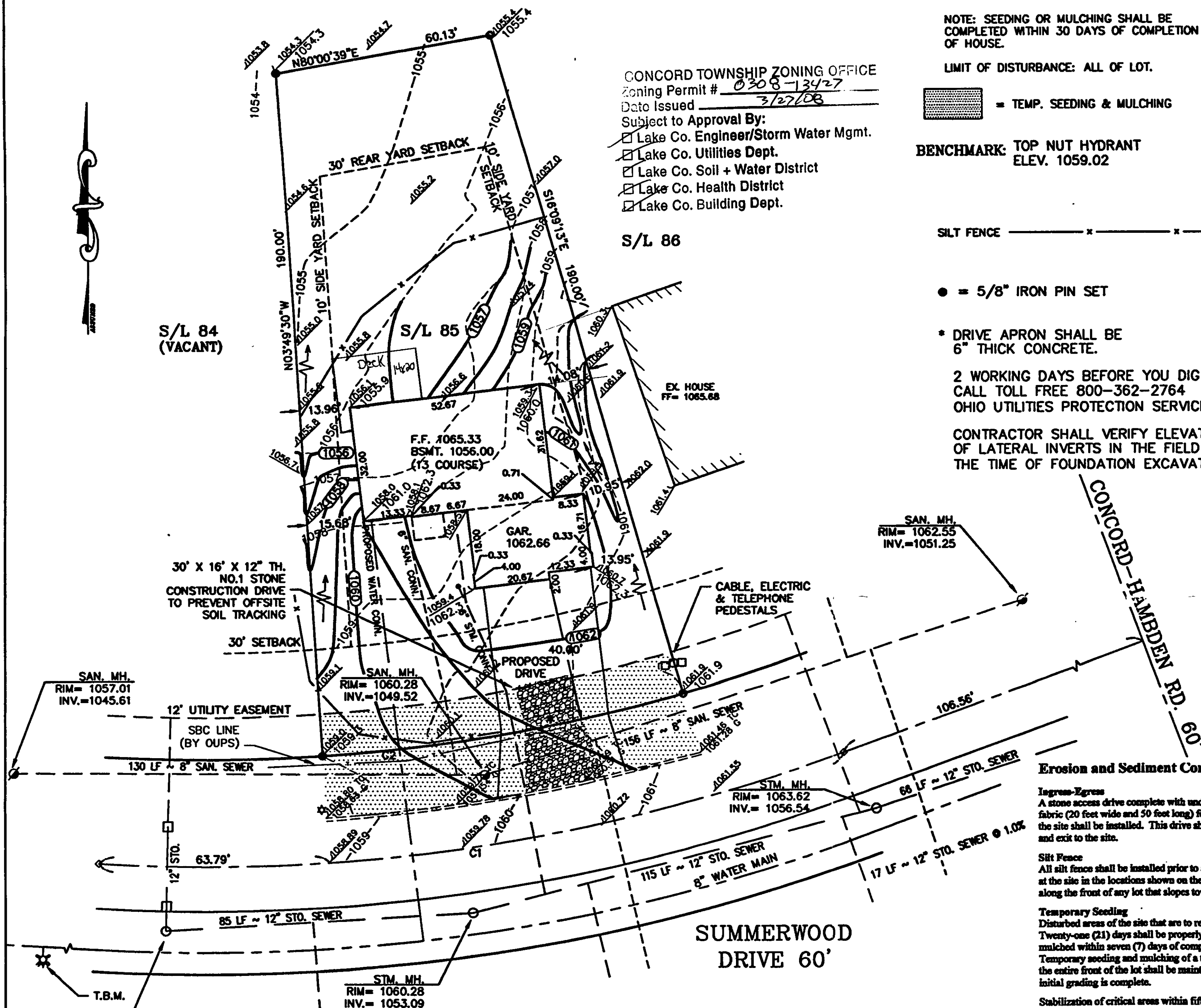

GRAPHIC SCALE

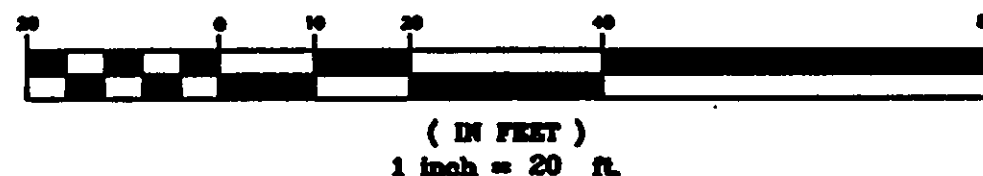

| CURVE TABLE | | | | | |
|-------------|---------|---------|-----------|---------|-------------|
| CURVE | LENGTH | RADIUS | DELTA | CHORD | BEARING |
| C1 | 209.38' | 500.00' | 23°59'36" | 207.85' | N87°29'18"E |
| C2 | 101.13' | 470.00' | 12°19'44" | 100.94' | N80°00'39"E |