

DESIGN & SURVEYOR'S CERTIFICATION

I, the undersigned hereby certify that I have surveyed the platted property shown hereon containing .505 acres of land. Iron pin monuments were found or set at points indicated. All dimensions shown hereon are expressed in feet and decimal parts thereof. Bearings shown hereon are based upon an assumed meridian and are for the sole purpose of indicating the relative angle between lines.

I, the undersigned hereby certify that the topography shown hereon, indicated by one foot contours and elevations represents an actual field topographic survey made by me and verified on Aug 17, 1998 and that the elevations were taken at appropriate intervals and that as of that date they existed as indicated hereon.

This Plat was prepared by me and is correct to the best of my knowledge and belief.

Surveyor's Signature Edward L. Scherer Date 8/18/98

Registration No: 4514

Seal:

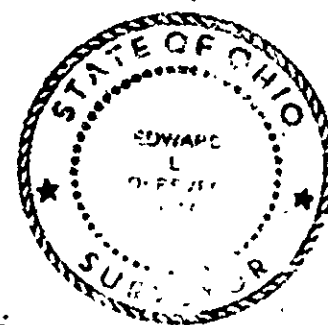

LEGEND

Existing Elevation: 800.00
Proposed Elevation: 800.00
As-Built Elevation: 800.00

Existing Contour: _____
Proposed Contour: _____

SITE AND GRADING PLAN

FOR HILL CONSTRUCTION CO.
3999 KIRTLAND ROAD
WILLOUGHBY, OH 44094
PH 275-8718 (PAGER)

BEING S/L NO 49 IN STURBRIDGE SUBDIVISION 2
AS SHOWN BY PLAT RECORDED IN VOL 27, PG 25
OF LAKE COUNTY MAP RECORDS
IN THE TOWNSHIP OF CONCORD
LAKE COUNTY, OHIO

ZONING PERMIT #0898-1184

ISSUED 8/24/98

SUBJECT TO APPROVAL BY:

Lake County Sanitary Eng. ☐
Lake County Eng. Dept. ☒
Lake County Planning Comm. ☐
Lake County Bldg. Dept. ☒

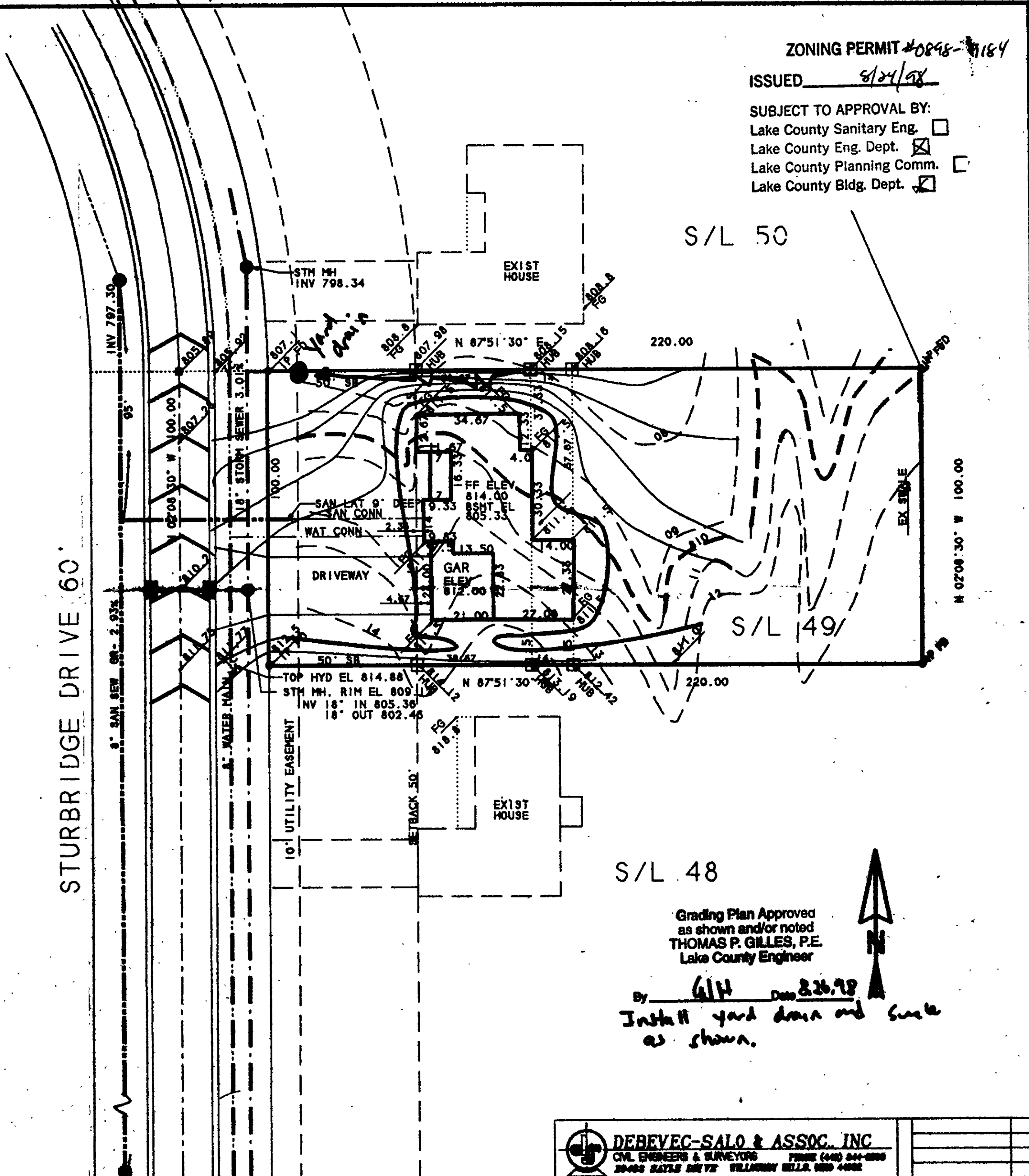

S/L 48

Grading Plan Approved
as shown and/or noted
THOMAS P. GILLES, P.E.
Lake County Engineer

By GH Date 8/28/98
Install yard drain and such
as shown.

	DEBEVEC-SALO & ASSOC. INC. CIVIL ENGINEERS & SURVEYORS 20405 SATEL DRIVE WILLOUGHBY, OHIO 44095		8/18/98
	S/L NO 49 STURBRIDGE 2 SITE & GRADING PLAN		SCALE 1"=20'
			S/L 49
			NO 6641