

For :	Jack Borkey		
	CLIENT		
7624 Brainerd Ct.			Montclair
ADDRESS	STREET		CITY

26	Call Woods #2		
SUBLOT No.	SUBDIVISION NAME	VOL.	PAGE
8.9.10	Concord		
LOT	TRACT	CITY/TOWNSHIP	COUNTY

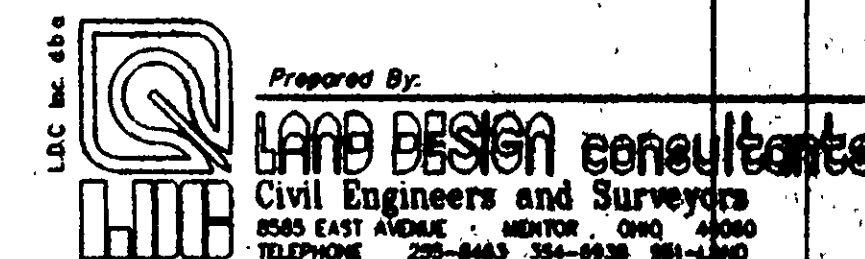

DESIGN CERTIFICATION

THIS PLAN WAS PREPARED BY ME, AND IS CORRECT TO THE
BEST OF MY KNOWLEDGE AND BELIEF.

Paul A. Telford 6.14.99

CHECK LIST

LOT DIMENSIONS & BEARINGS
TO NEAREST STREET
SUBJLT. No. (PAGES 2-3)
SURROUNDING OWNERS
BUILDING DIMENSIONS
SEAWALL, SHEDS, HEAVYDUTY
DRIVE, & APPROX. TYPE, WIDTH, THICKNESS
SIDEWALK TYPE, WIDTH, THICKNESS
CULVERT TYPE, DRAIN, LENGTH
WATER MAIN SIZE, DRAIN
SAN. SEWER SIZE, X GRADE, LOC.
SAN. MAN. CAST. ELEV. BY ELEV.
SAN. CROWN SIZE, X GRADE, LOC.
STORM. SEWER SIZE, X GRADE, LOC.
STORM. MAN. CAST. ELEV. BY ELEV.
PAVE. TYPE, GRADE, CURBS
GAS LINE LOC., SIZE
SEWER LINE LOC., SIZE
WELL LOCATION & CIRCULATION
WELL LOCATION & CIRCULATION RADIUS



"AS BUILT" CERTIFICATION

I HEREBY CERTIFY THAT THE CIRCLED INFORMATION IS
EXISTING AS OBTAINED ON THE SITE _____
AND IS CORRECT TO THE BEST OF MY KNOWLEDGE
AND BELIEF.

NAME _____

LEGEND

STORM MANHOLE
SANITARY MANHOLE
EXISTING CONTOURS
PROPOSED CONTOURS
EXIST ELEV 100.0
F.&100.0 = PRO
DIRECTION OF
SURFACE DRAINAGE

DRAWN BY	SCALE
G.S.V./J.B.R	1"=30'-0"
CHK'D BY/FIELD	DATE
R.A.T.	June, 1999

BENCHMARK: B.M.=T.B.M. Set On Top Of Hydrant
Located In Front Of Adjacent
Sublot 27; Elev.: 914.79

EXISTING UNDERGROUND UTILITIES NOTE:
THE SIZE & LOCATION, BOTH HORIZONTAL AND VERTICAL,
OF THE UNDERGROUND UTILITIES SHOWN HEREON, HAVE BEEN
OBTAINED BY A SEARCH OF AVAILABLE RECORDS.
VERIFICATION BY FIELD OBSERVATION HAS BEEN CONDUCTED
WHERE PRACTICAL. HOWEVER, LDC INC. DOES NOT
GUARANTEE THE COMPLETENESS NOR ACCURACY THEREOF.

Grading Plan Approved
as shown and/or noted
THOMAS P. GILLES, P.E.
Lake County Engineer

By [Signature] Date 7/16/99
10% Maximum Delivery Grade

ZONING PERMIT. 0799 94 80
ISSUED 7-14-99

SUBJECT TO APPROVAL BY:

Lake County Sanitary Eng.	<input type="checkbox"/>
Lake County Eng. Dept.	<input checked="" type="checkbox"/>
Lake County Planning Comm.	<input type="checkbox"/>
Lake County Bldg. Dept.	<input checked="" type="checkbox"/>



DWG. NAME
BORKJ1-9901

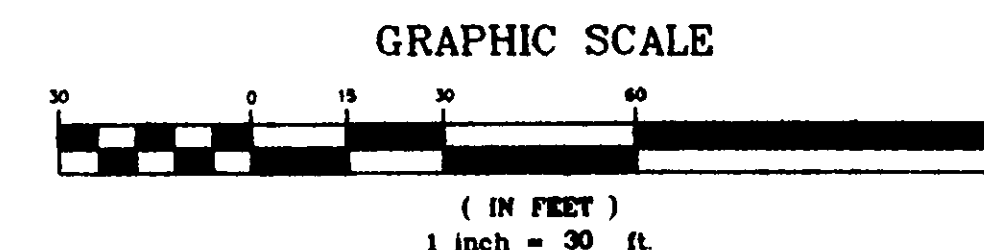
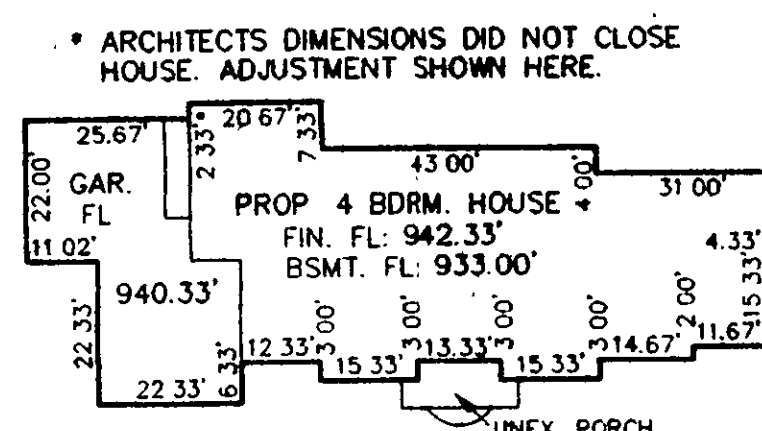

I, THE UNDERSIGNED, HEREBY CERTIFY THAT THIS TOPOGRAPHY, INDICATED BY 6", 1", OR 2' CONTOURS, AND ELEVATIONS SHOWN HEREON, REPRESENT AN ACTUAL FIELD SURVEY MADE BY ME ON THE DAY OF 19, AND THAT THE ELEVATIONS WERE TAKEN AT APPROPRIATE INTERVALS, AND THAT AS OF THAT DATE THEY EXISTED AS INDICATED HEREON.

Richard A. Thompson, Jr. 6-14-99

S/L 25

S/L 27

Subtot 26
(281100 4 cons)

M.H. Lantieri & J.C. Vioza
Vol. 972, Pg. 192

Chardon Methodist Church
111. 227 St. 222

SCALE: HORIZ 1" = 30'
VERT. 1" = 5'

Sarah Lee Drive 60'

10% maximum driveway grade

S/L 26 Crx D
R=70.00
A=85.58
C=80.27
N 44°28'00"

50' Setback

REVIEWED AND ACCEPTED
LAKE COUNTY GENERAL
HEALTH DISTRICT

Date: 6-21-99 BY: D. J. Lark
System must be built from end

SEWAGE DISPOSAL PERMIT MUST BE
OBTAINED BY A LAKE COUNTY LICENSED
INSTALLER BEFORE INSTALLATION IS
STARTED

12"

TYPICAL CURTAIN DRAIN CROSS SECTION

NOTES:

- 1.) SEE CORRESPONDING MOUND MANUAL FOR SEPTIC TANK, DOSING PUMP AND MOUND DETAILS
- 2.) THE DESIGN OF THIS SEPTIC SYSTEM IS BASED UPON REGULATIONS ESTABLISHED BY THE LAKE COUNTY GENERAL HEALTH DISTRICT AND IN COMPLIANCE WITH THEIR RECOMMENDATION FOR DESIGN. THIS PLAN REPRESENTS THEIR RECOMMENDATION AND IS FOR THE SOLE PURPOSE OF ESTABLISHING GRADES, ISOLATIONS AND OTHER PARTICULARS OF THE HEALTH DISTRICTS REGULATIONS AND DOES NOT CONSTITUTE ANY WARRANTY OR GUARANTEE OF THE SYSTEM OR ITS CAPABILITY TO FUNCTION IN CONFORMANCE WITH ANY REGULATIONS BY ANY REGULATORY AGENCY

