

SYMBOL LEGEND	
	PK Nail Set
	Manhole
	Power Pole
	Iron Pin Found

Bench Mark - SAS MH  
Rim elev 770.14  
Inv. elev 764.54

Thomas R. Revelinsky  
Vol. 1166 Pg. 813

Ex. Building  
F.F.L 772.72

ZONING PERMIT #0299-9277  
ISSUED 2-3-99

SUBJECT TO APPROVAL BY:  
Lake County Sanitary Eng. ☐  
Lake County Eng. Dept. ☒  
Lake County Planning Comm. ☐  
Lake County Bldg. Dept. ☒

Zoning District - R-1  
Front Setback 50'  
Side Yard Setback 15'  
Rear Yard Setback 40'

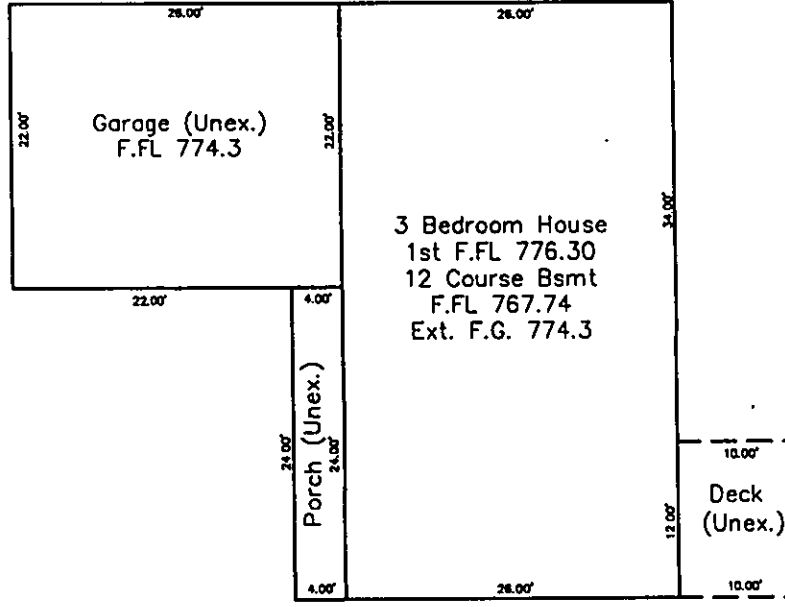

Grading Plan Approved  
as shown and/or noted  
THOMAS P. GILES, P.E.  
Lake County Engineer

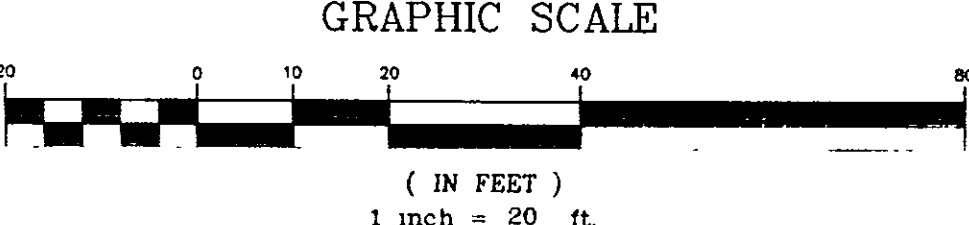

# SITE PLAN

for : Lee Babic CLIENT  
7394 Morley Rd. Concord Ohio 44077  
ADDRESS CITY STATE ZIP

SUBLOT No. 35 LOT TRACT 4  
SUBDIVISION NAME Concord Twp. CITY  
813 1092 VOL. PAGE  
Ohio STATE

## Foresight Engineering Group

Engineers & Surveyors  
440 286-1010  
440 286-1034 fax  
320 Center Street, Unit F  
Chardon, Ohio 44024

### DESIGN CERTIFICATION

This Site Plan was prepared by Foresight Engineering Group, Inc., and is correct to the best of my knowledge and belief.

Steve A. Roman  
NAME

### CHECK LIST

LOT DIMENSIONS & BEARINGS  
TIE TO NEAREST STREET  
SUBLOT No. (PARCEL No.)  
SURROUNDING OWNERS  
BUILDING DIMENSIONS  
SETBACK, SIDEYARD, REARYARD  
FINISH GRADES  
DRIVE & APRON TYPE, WIDTH, THICKNESS  
SIDEWALK TYPE, WIDTH, THICKNESS  
CULVERT TYPE, DIAM., LENGTH  
WATER MAIN SIZE, LOCATION  
SAN. SEWER SIZE, % GRADE, LOC.  
SAN. MH. CAST. ELEV., INV. ELEV.  
SAN. CONN. SIZE, % GRADE, LOC.  
STORM SEWER SIZE, % GRADE, LOC.  
STORM MH. CAST. ELEV., INV. ELEV.  
PAV'T TYPE, GRADE, CURBS  
GAS LINE LOC., SIZE  
SEPTIC SYSTEM & DUPLICATION  
WELL LOCATION & ISOLATION RADIUS

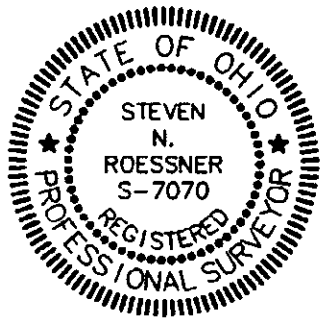

STATE SEAL

### "AS BUILT" CERTIFICATION

I hereby certify that the circled information is existing as obtained on the site \_\_\_\_\_ 19\_\_\_\_ and is correct to the best of my knowledge and belief.

NAME \_\_\_\_\_

SCALE : 1" = 30'	1
FILE NAME: I:\Bab49901\siteplan	2
DATE : February 1, 1999	3

BENCHMARK: Sanitary Manhole Rim elev. = 770.14

"I, the undersigned hereby certify that this topography, indicated by 6", 1' or 2' contours, and the elevations shown hereon represent an actual field survey made by Foresight Engineering Group, Inc. on the 29 day of January 19 99 and that the elevations were taken at appropriate intervals and that as of that date they existed as indicated hereon."

Steve A. Roman  
NAME



EXISTING UNDERGROUND UTILITIES NOTES:  
The location both horizontal and vertical of the underground utilities shown hereon, have been obtained by a diligent and comprehensive search of available records. Verification by field observation, has been conducted where practical. However, Foresight Engineering Group, Inc. does not guarantee the completeness nor accuracy thereof.

By JAM Date 2/8/99