

**CERTIFICATION :**

"I THE UNDERSIGNED HEREBY CERTIFIES THAT THIS TOPOGRAPHY INDICATED BY 1 FOOT CONTOURS AND ELEVATION SHOWN HEREON REPRESENTS AN ACTUAL SURVEY MADE BY ME ON THE 17th DAY OF DECEMBER, 2013 AND THE ELEVATIONS WERE TAKEN AT AN APPROPRIATE INTERVAL AND AS OF THAT DAY THEY EXISTED AS INDICATED HEREON.

"I HEREBY CERTIFY THAT THIS PLAN WAS PREPARED BY ME AND IS CORRECT TO THE BEST OF MY KNOWLEDGE AND BELIEF"

*DWN* 12/19/2013  
DAVID W. NOVAK, P.S. No. 7507

**NOTE:**

THE PRIVATE PRESERVATION EASEMENT AS SHOWN ON THIS PLAN TO REMAIN UNDISTURBED. THE PRIVATE PRESERVATION EASEMENT IS TO BE IDENTIFIED AND FLAGGED WITH CAUTION TAPE OR SOME OTHER SUITABLE MATERIAL PRIOR TO ANY WORK PERFORMED ON THE SITE. CONTRACTOR, BUILDER AND OR HOMEOWNER ARE RESPONSIBLE TO ABIDE BY THE DECLARATION OF COVENANTS, CONDITIONS AND RESTRICTIONS FOR THIS SUBDIVISION REGARDING THE PRIVATE PRESERVATION EASEMENT.

Barrington Consulting Group, Inc. has not conducted a wetlands investigation or researched any records to determine if any wetlands are present on this site. Any wetland information shown on this plan is not guaranteed to be complete or accurate. The owner is responsible to take the appropriate steps with regard to any wetlands that might be present on this site or adjacent to this site prior to the start of any activity on the lot.

**Barrington**  
CONSULTING GROUP, INC.



CURVE	RADIUS	LENGTH	CHORD	BEARING	DELTA ANGLE
CI	170.00'	82.65'	81.84'	S 74°52'12" E	27°51'20"

EX. SAN. MH. 1 RIM=1053.69 INV.=1042.69	EX. STM. MH. 1 RIM=1054.56 INV. 18"=1048.30 INV. 12"=1050.26	EX. STM. MH. 3 RIM=1055.89 INV.=1052.48
EX. SAN. MH. 2 RIM=1054.01 INV.=1043.24	EX. STM. MH. 2 RIM=1054.09 INV.=1050.29	EX. STM. INLET 1 RIM=1059.98 INV.=1056.98

**GRAPHIC SCALE**

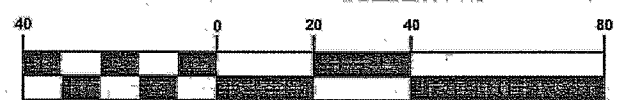

(IN FEET)  
1 inch = 40 ft.

LINE	BEARING	DISTANCE
L1	S 88°47'52" E	10.99'
L2	N 60°56'32" W	14.68'

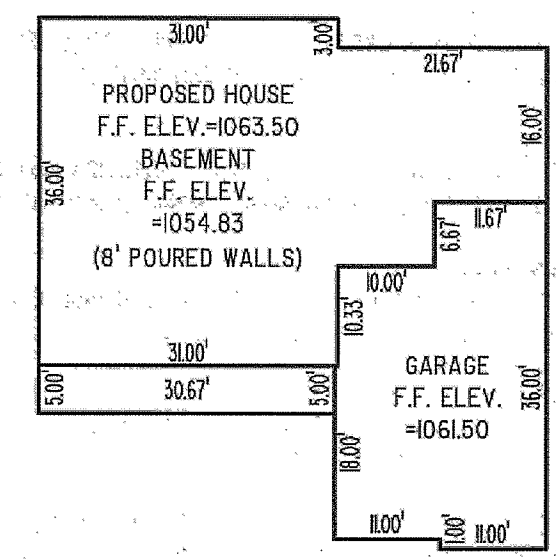

for Management Plan  
Approved as shown and/or noted  
**JAMES R. GILLS, P.E.**  
County Drainage Engineer  
By *L.S.* Date 2/5/14

**GENERAL NOTES:**

- BENCHMARK - TOP STEM OF EXISTING FIRE HYDRANT LOCATED IN FRONT SUBLOT 3, ELEVATION = 1060.44.
- DRIVEWAY APRON TO BE 6" THICK CONCRETE.
- ALL DOWNSPOUTS TO BE OUTLETTED TO SPLASH BLOCKS.
- CONTRACTOR RESPONSIBLE FOR CONTACTING THE OHIO UTILITY PROTECTION SERVICE (1.800.362.2764) AND ALL UTILITY COMPANIES A MINIMUM OF 48 HOURS PRIOR TO CONSTRUCTION.
- THE LOCATION BOTH HORIZONTAL AND VERTICAL OF EXISTING UNDERGROUND UTILITIES SHOWN HEREON, HAVE BEEN OBTAINED BY A DILIGENT AND COMPREHENSIVE SEARCH OF AVAILABLE RECORDS. VERIFICATION BY FIELD OBSERVATION HAS BEEN CONDUCTED WHERE PRACTICAL, HOWEVER, BARRINGTON CONSULTING GROUP, INC. DOES NOT GUARANTEE THE COMPLETENESS, NOR ACCURACY THEREOF.
- CONTRACTOR SHALL VERIFY ELEVATIONS OF LATERAL INVERTS IN THE FIELD PRIOR TO FOUNDATION EXCAVATION.
- PRIOR TO ANY WORK BEING PERFORMED WITH THE RIGHT OF WAY AND/OR UNDERGROUND UTILITY EASEMENTS, CONTRACTOR SHALL CONFIRM THAT ALL REQUIRED CLEARANCES AND BURY DEPTHS OF ALL UNDERGROUND UTILITIES WILL BE MAINTAINED AS A RESULT OF ANY AND ALL SITE IMPROVEMENTS.
- SEE SHEET 2 FOR EROSION AND SEDIMENT-CONTROL PLAN
- SEE SHEET 2 FOR SEEDING INFORMATION

Builder and all subcontractors shall review this plan to verify house dimensions and all site improvements for any discrepancies, omissions and/or changes and notify Barrington Consulting Group, Inc. prior to any site work.

REVISIONS	BY

**Barrington**  
CONSULTING GROUP, INC.  
9114 TYLER BLVD., MENTOR, OHIO 44060  
PHONE 440.205.1260 FAX 440.205.1262  
www.BarringtonCGI.com

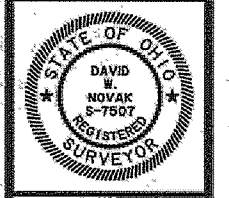

**SITE PLAN**  
10280 LAYDON LN., CONCORD TWP., OHIO 44077  
S/L 2 MOUNTAIN TOP ESTATES SUBDIVISION VOL. 57 PG. 15  
PROBUILT HOMES, INC.

DRAWN WSO  
CHECKED DWN  
DATE DEC. 18, 2013  
SCALE 1" = 40'  
JOB NO. 08040-002  
SHEET 112  
OF SHEETS