

HYDRAULIC PROFILE:
SCALE: HOR. 1" = 30', VERT. 1" = 5'

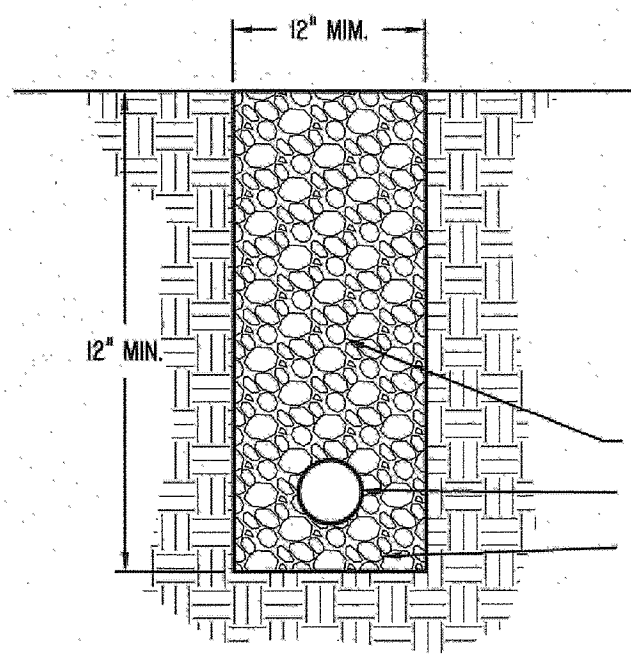
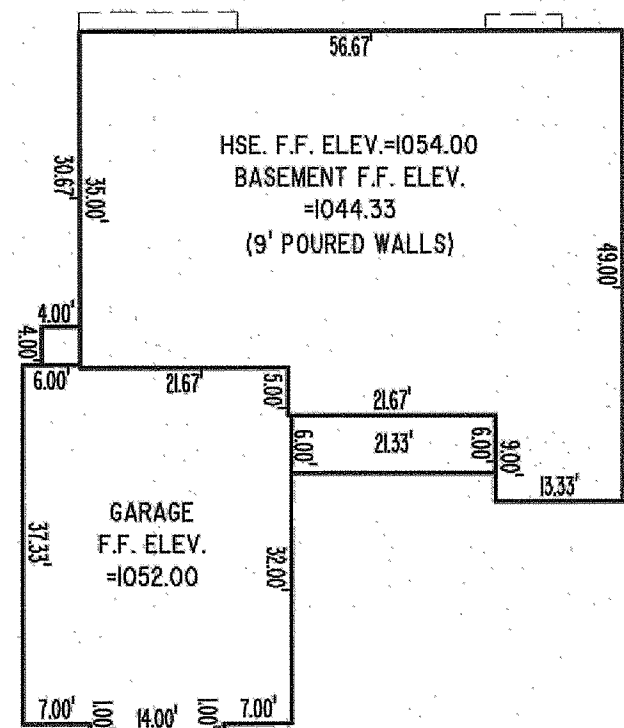

1. THE INTERCEPTOR DRAIN TRENCH SHALL BE A MINIMUM OF 12" DEEP AND 12" WIDE
2. INTERCEPTOR DRAIN TO BE A MINIMUM OF 8 FEET FROM TOE OF MOUND.
3. PIPE SHALL HAVE MINIMUM SLOPE OF 0.50%.
4. THE INVERT OF THE DRAIN OUTLET SHALL BE A MINIMUM OF 4 INCHES ABOVE THE RECEIVING WATER LEVEL OR GROUND SURFACE.

- WASHED GRAVEL (3/4" - 1.5" DIAMETER)
- 4" PERFORATED PVC PIPE
- 2" WASHED GRAVEL

TYPICAL INTERCEPTOR DRAIN CROSS SECTION

CONCORD TOWNSHIP ZONING OFFICE
Zoning Permit # 0574-1530
Date Issued 5/19/2014
Subject to Approval By:
☒ Lake Co. Engineer/Storm Water Mgmt.
☒ Lake Co. Utilities Dept.
☒ Lake Co. Soil + Water District
☒ Lake Co. Health District
☒ Lake Co. Building Dept.

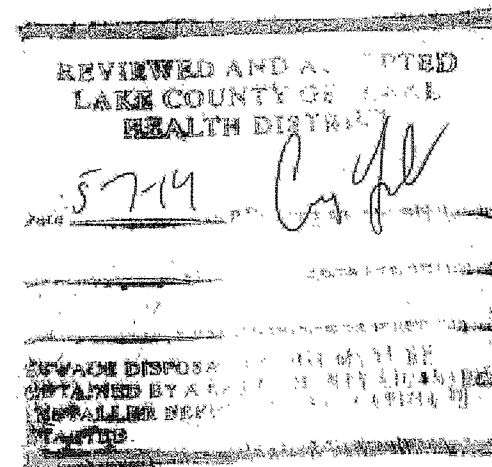

SEPTIC SYSTEM NOTES:

1. ALL ASPECTS OF THE SEPTIC SYSTEM SHALL ADHERE TO THE REGULATIONS OF THE BOARD OF HEALTH OF THE LAKE COUNTY GENERAL HEALTH DISTRICT PART (CHAPTER) 29 "SEWAGE TREATMENT RULES"
2. THE FULL SOIL ABSORPTION AREA SHALL BE FREE OF ANY SITE DISTURBANCE. IF ANY DISTURBANCE OR DAMAGE HAS OCCURRED, INSTALLATION SHALL NOT PROCEED AND THE REGISTERED INSTALLER SHALL CONTACT THE OWNER AND THE BOARD OF HEALTH.
3. THE SYSTEM MUST BE INSTALLED WHEN THE SOILS ARE DRY. THE INSTALLATION OF A SYSTEM IN WET CONDITIONS CAN CAUSE SOIL COMPACTION AND SMEARING WHICH LEADS TO SYSTEM FAILURE.
4. PRIOR TO EXCAVATION, THE REGISTERED INSTALLER SHALL CHECK ALL ELEVATIONS IN THE LAYOUT PLAN RELATIVE TO THE ESTABLISHED BENCHMARK.
5. THE INSTALLER MUST BE REGISTERED AND APPROVED PER O.A.C. 3701-29-04.1.
6. THE SYSTEM INSTALLER SHALL CONSULT WITH THE DESIGNER PRIOR TO ANY INTENDED CHANGES TO THE SYSTEM.
7. THE SYSTEM INSTALLER SHALL COORDINATE WITH THE DESIGNER IN ORDER TO PROVIDE AN ACCURATE AS-BUILT.
8. THE PROPOSED SEPTIC FIELD AREA AND DUPLICATION AREA SHALL BE ROPED OFF PRIOR TO THE START OF ANY CONSTRUCTION TO PREVENT DISTURBANCE TO THE AREAS.
9. THE MOUNDS SHALL NOT BE INSTALLED WHERE GROUND SLOPES EXCEED 15%.
10. ALL ELECTRICAL WORK SHALL COMPLY WITH THE NATIONAL ELECTRICAL CODE.
11. BASEMENT SERVICE BY GRAVITY NOT ATTAINABLE. PUMP REQUIRED TO SERVICE BASEMENT.

SEPTIC SYSTEM DESIGN NOTES

THIS PARTICULAR PROJECT WAS DESIGNED FOR A FOUR BEDROOM HOUSE PRODUCING AN AVERAGE FLOW OF 288 GALLONS PER DAY AND HAVING RESIDENTIAL STRENGTH WASTEWATER OF 140 MG/L OF BOD(5). THE SYSTEM DESIGN IS CAPABLE OF ACCOMMODATING PEAK FLOW OF UP TO 480 GALLONS PER DAY AND WASTEWATER STRENGTHS NOT TO EXCEED 250 MG/L OF BOD(5) FOR SHORT PERIODS OF TIME.

THE SEPTIC SYSTEM DESIGN IS BASED UPON A SOIL REPORT PREPARED BY JIM FINCHAM DATED NOVEMBER 19, 2013.

Barrington Consulting Group, Inc. has not conducted a wetlands investigation or researched any records to determine if any wetlands are present on this site. Any wetland information shown on this plan is not guaranteed to be complete or accurate. The owner is responsible to take the appropriate steps with regard to any wetlands that might be present on this site or adjacent to this site prior to the start of any activity on the lot.

Builder and all subcontractors shall review this plan to verify house dimensions and all site improvements for any discrepancies, omissions and/or changes and notify Barrington Consulting Group, Inc. prior to any site work.

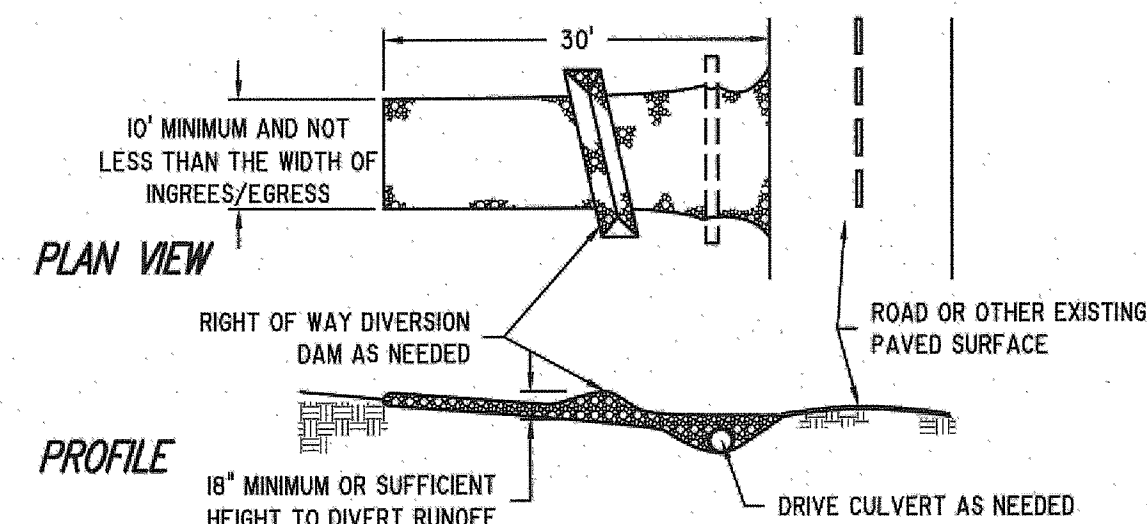

CONSTRUCTION DRIVE DETAIL

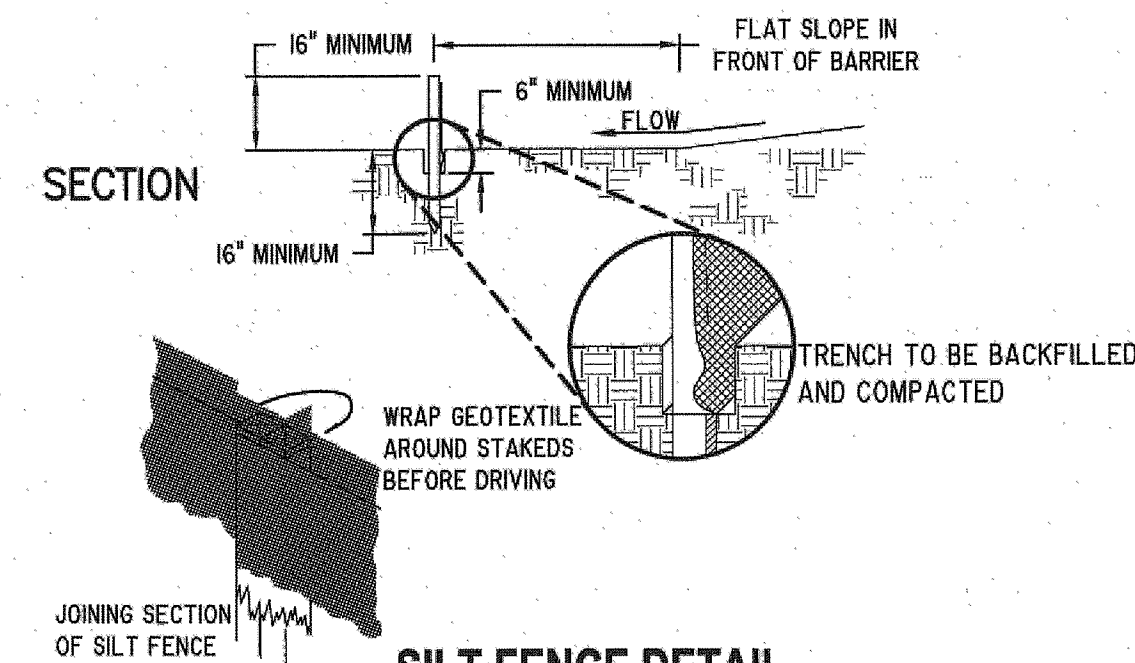

SILT FENCE DETAIL

TEMPORARY SEEDING SPECIFICATIONS			
SEEDING DATES	SPECIES	LB./1000 FT.	PER AC.
MARCH 1 TO AUGUST 15	OATS	3	4 BUSHEL
	TALL FESCUE	1	40 LB.
	ANNUAL RYEGRASS	1	40 LB.
	PERENNIAL RYEGRASS	1	40 LB.
	TALL FESCUE	1	40 LB.
	ANNUAL RYEGRASS	1	40 LB.
	WHEAT	3	2 BUSHEL
	TALL FESCUE	1	40 LB.
	ANNUAL RYEGRASS	1	40 LB.
	PERENNIAL RYEGRASS	1	40 LB.
AUGUST 16 TO NOVEMBER 1	RYE	3	2 BUSHEL
	TALL FESCUE	1	40 LB.
	ANNUAL RYEGRASS	1	40 LB.
	TALL FESCUE	1	40 LB.
NOVEMBER 1 TO SPRING SEEDING	TALL FESCUE	1	40 LB.
	ANNUAL RYEGRASS	1	40 LB.
USE MULCH ONLY, SODDING PRACTICES OR DORMANT SEEDING.			

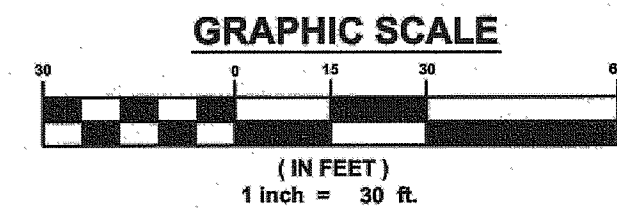

EROSION AND SEDIMENT CONTROL

SILT FENCE ALL SILT FENCE SHALL BE INSTALLED PRIOR TO ANY EARTHWORK ACTIVITIES AT THE SITE IN THE LOCATIONS SHOWN ON THE SITE PLAN AS WELL AS ALONG THE FRONT OF ANY LOT THAT SLOPES TOWARDS THE STREET.

TEMPORARY SEEDING DISTURBED AREAS OF THE SITE THAT ARE TO REMAIN IDLE FOR MORE THAN TWENTY-ONE (21) DAYS SHALL BE PROPERLY SEEDDED AND STRAW MULCHED WITHIN SEVEN (7) DAYS OF COMPLETION OF INITIAL GRADING. TEMPORARY SEEDING AND MULCHING OF A THIRTY (30) FOOT STRIP OF THE ENTIRE FRONT OF THE LOT SHALL BE MAINTAINED ON THE SITE ONCE INITIAL GRADING IS COMPLETE.

STABILIZATION OF CRITICAL AREAS WITHIN FIFTY (50) FEET OF ANY STREAM OR WETLAND SHALL BE COMPLETE WITHIN TWO (2) DAYS OF THE DISTURBANCE IF THE SITE IS TO REMAIN INACTIVE FOR LONGER THAN FOURTEEN (14) DAYS.

MULCHING STRAW-MULCH SHALL BE APPLIED AT A RATE OF 1 BALE PER EVERY TEN (10) FEET OF CURB, AT A WIDTH OF THIRTY (30) FEET OF THE ENTIRE LENGTH OF THE LOT. WOOD CHIPS MAY ALSO BE USED BUT MUST BE SPREAD AT A MINIMUM DEPTH OF FOUR INCHES OVER THE THIRTY-FOOT WIDTH AND MUST BE ACCOMPANIED BY A PROPERLY INSTALLED SILT FENCE.

MAINTENANCE EROSION AND SEDIMENT CONTROLS SHALL BE INSPECTED EVERY SEVEN (7) DAYS OR WITHIN 24 HOURS OF A 0.5" OR GREATER RAINFALL EVENT. NECESSARY REPAIRS SHALL BE MADE AT THIS TIME.

INGRESS-EGRESS A STONE ACCESS DRIVE COMPLETE WITH UNDER LYING GEO-TEXTILE FABRIC (14 FEET WIDE AND 30 FEET LONG WITH 6-10 INCH STONE DEPTH) FOR INGRESS AND EGRESS AT THE SITE SHALL BE INSTALLED. THIS DRIVE SHALL BE THE ONLY ENTRANCE AND EXIT TO THE SITE.

STREETS DIRECTLY ADJACENT TO THE CONSTRUCTION ENTRANCES AND RECEIVING TRAFFIC FROM THE DEVELOPMENT AREA SHALL BE CLEANED DAILY TO REMOVE SEDIMENT TRACKED OFF-SITE. IF APPLICABLE, THE CATCH BASINS ON THESE STREETS NEAREST TO THE CONSTRUCTION ENTRANCES SHALL BE CLEANED WEEKLY.

ALL EROSION AND SEDIMENT CONTROL SPECIFICATIONS, APPLICATIONS, AND TIMETABLES ARE BASED ON THE DESCRIPTIONS AND STANDARDS OF THE OHIO DEPARTMENT OF NATURAL RESOURCES "RAINWATER AND LAND DEVELOPMENT MANUAL" AND CAN BE FOUND IN THE LAKE COUNTY EROSION AND SEDIMENT CONTROL RULES AS ADOPTED DECEMBER 21, 1999.

THE SPECIFIED EROSION AND SEDIMENT CONTROL STANDARDS ARE GENERAL GUIDELINES AND SHALL NOT LIMIT THE RIGHT OF THE COUNTY TO IMPOSE, AT ANY TIME, ADDITIONAL, MORE STRINGENT REQUIREMENTS. NOR SHALL THE STANDARDS LIMIT THE RIGHT OF THE COUNTY TO WAIVE, IN WRITING, INDIVIDUAL REQUIREMENTS.

GENERAL NOTES

1. BENCHMARK - CAPPED POLARIS IRON PIN FOUND AS SHOWN IN SITE PLAN, ELEVATION = +042.51
2. DRIVEWAY APRON TO BE 6" THICK CONCRETE.
3. ALL DOWNSPOUTS TO BE TIED INTO THE FOOTER DRAIN AND OUTLETTED TO THE DITCH.
4. CONTRACTOR RESPONSIBLE FOR CONTACTING THE OHIO UTILITY PROTECTION SERVICE (1.800.382.2784) AND ALL UTILITY COMPANIES A MINIMUM OF 48 HOURS PRIOR TO CONSTRUCTION.
5. THE LOCATION BOTH HORIZONTAL AND VERTICAL OF EXISTING UNDERGROUND UTILITIES SHOWN HEREON, HAVE BEEN OBTAINED BY A DILIGENT AND COMPREHENSIVE SEARCH OF AVAILABLE RECORDS. VERIFICATION BY FIELD OBSERVATION HAS BEEN CONDUCTED WHERE PRACTICAL, HOWEVER, BARRINGTON CONSULTING GROUP, INC. DOES NOT GUARANTEE THE COMPLETENESS, NOR ACCURACY THEREOF.
6. CONTRACTOR SHALL VERIFY ELEVATIONS OF LATERAL INVERTS IN THE FIELD PRIOR TO FOUNDATION EXCAVATION.
7. PRIOR TO ANY WORK BEING PERFORMED WITH THE RIGHT OF WAY AND/OR UNDERGROUND UTILITY EASEMENTS, CONTRACTOR SHALL CONFIRM THAT ALL REQUIRED CLEARANCES AND BURY DEPTHS OF ALL UNDERGROUND UTILITIES WILL BE MAINTAINED AS A RESULT OF ANY AND ALL SITE IMPROVEMENTS.

WATER CONNECTION NOTE:

1" WATER SERVICE CONNECTION TO BE INSTALLED AND CONNECTED TO FUTURE WATER LINE EXTENSION FOR CONCORD-HAMBDEN ROAD BY OTHERS. CONTRACTOR TO COORDINATE WITH PAINESVILLE WATER FOR SERVICE CONNECTION.

SOIL AND EROSION CONTROL NOTE:

SITE ACREAGE 2.1178 ACRES
DISTURBED AREA 0.9194 ACRES
PROPOSED IMPERVIOUS AREA 0.1515 ACRES
PERCENT IMPERVIOUS 7.2%

CERTIFICATION:

"I THE UNDERSIGNED HEREBY CERTIFIES THAT THIS TOPOGRAPHY INDICATED BY 1 FOOT CONTOURS AND ELEVATION SHOWN HEREON REPRESENTS AN ACTUAL SURVEY MADE BY ME ON THE 6th DAY OF MARCH, 2014 AND THE ELEVATIONS WERE TAKEN AT AN APPROPRIATE INTERVAL AND AS OF THAT DAY THEY EXISTED AS INDICATED HEREON.

"I HEREBY CERTIFY THAT THIS PLAN WAS PREPARED BY ME AND IS CORRECT TO THE BEST OF MY KNOWLEDGE AND BELIEF"

DAVID W. NOVAK, P.S. No. 7507
0387-0290

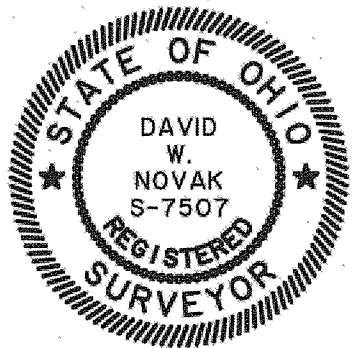

Water Management Plan
Approved as shown and/or noted
JAMES R. GILLS, P.E.
County Drainage Engineer
By: *[Signature]* Date: 5/13/14
Drive culvert shall be approved by DOT

13093.03

REVISIONS	BY
REVISED PER LDR MAY 7, 2014	WSO

Barrington
CONSULTING GROUP, INC.
9114 TYLER BLVD., MENTOR, OHIO 44060
PHONE 440.205.1260 FAX 440.205.1262
www.BarringtonCGL.com

PROBUILT HOMES, INC.
GEORGE DAVIS
P.O. BOX 384
MENTOR, OHIO 44060
PH: 440.255.6535/FAX: 440.974.8360

SITE PLAN
12442 CONCORD-HAMBDEN ROAD
CONCORD TWP., OHIO 44077
BEZDEK RESIDENCE

DRAWN WSO
CHECKED DWN
DATE APR. 2, 2014
SCALE 1" = 30'
JOB NO. 13093.03
SHEET 1/2
OF SHEETS