

I CERTIFY THIS SEWAGE SYSTEM DESIGN MEETS THE MINIMUM REQUIREMENTS ESTABLISHED BY THE LGHD IN THE HSTS GUIDANCE MANUAL, AND THE REQUIREMENTS AND RECOMMENDATIONS OF THE SYSTEM MANUFACTURER.

Name Haley Jones #6313  
Reg. No.

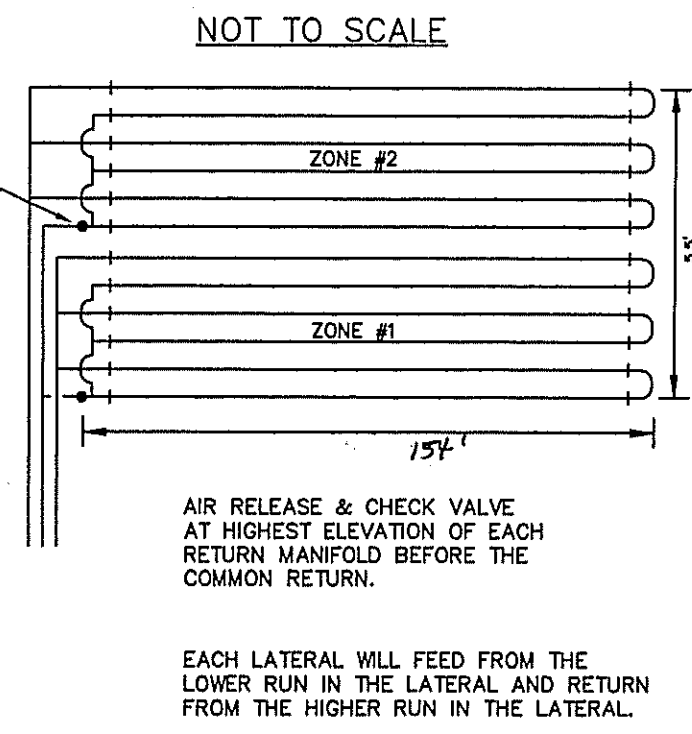
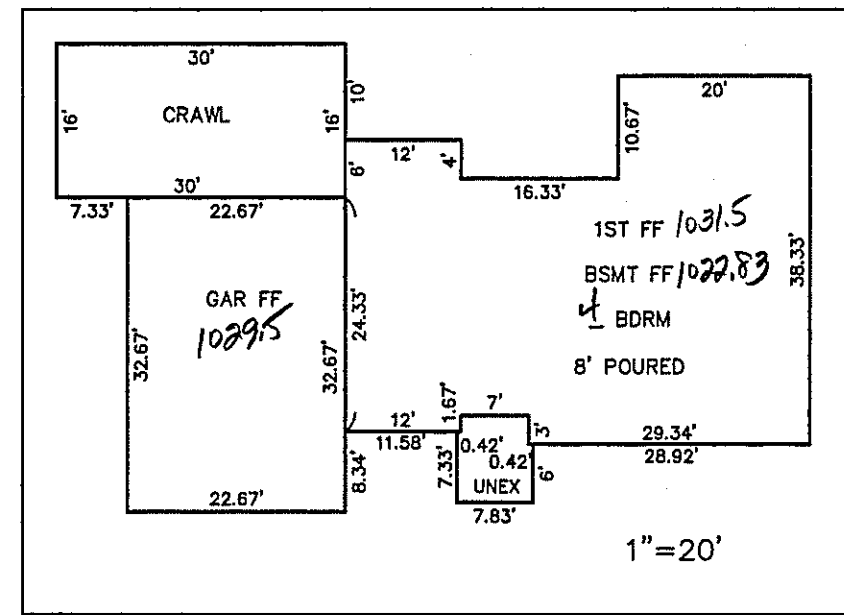

CURVE TABLE						
CURVE	LENGTH	RADIUS	TANGENT	CHORD	BEARING	DELTA
C1	94.97	230.00	48.17	94.30	S37°20'11"W	23°39'32"
C2	259.93	200.00	151.99	242.02	S46°50'00"W	74°27'54"

**Erosion and Sediment Control Schedule**

**Ingress-Egress**  
A stone access drive complete with under lying geo-textile fabric (20 feet wide and 50 feet long) for ingress and egress at the site shall be installed. This drive shall be the only entrance and exit to the site.

**Silt Fence**  
A silt fence shall be installed prior to any earthwork activities at the site in the locations shown on the site plan as well as along the front of any lot that slopes towards the street.

**Temporary Seeding**  
Disturbed areas of the site that are to remain idle for more than thirty(30) days shall be properly seeded and straw mulched within seven(7) days of completion of initial grading. Temporary seeding and mulching as a thirty(30) foot strip of the entire front of the lot shall be maintained on the site once initial grading is complete.

**Stabilization of critical areas** within fifty(50) feet of any stream or wetland shall be complete within two(2) days of the disturbance if the site is to remain inactive for longer than fourteen(14) days.

**Mulching**  
Straw-mulch shall be applied at a rate of 1 bale per every ten (10) feet of curb, at a width of thirty(30) feet to the entire length of the lot. Wood chips may also be used but must be spread at a minimum depth of four inches over the thirty-foot width and must be accompanied by a properly installed silt fence.

**Maintenance**  
Erosion and sediment controls shall be inspected every seven(7) days or within 24 hours of a 0.5" or greater rainfall event. Necessary repairs shall be made at this time.

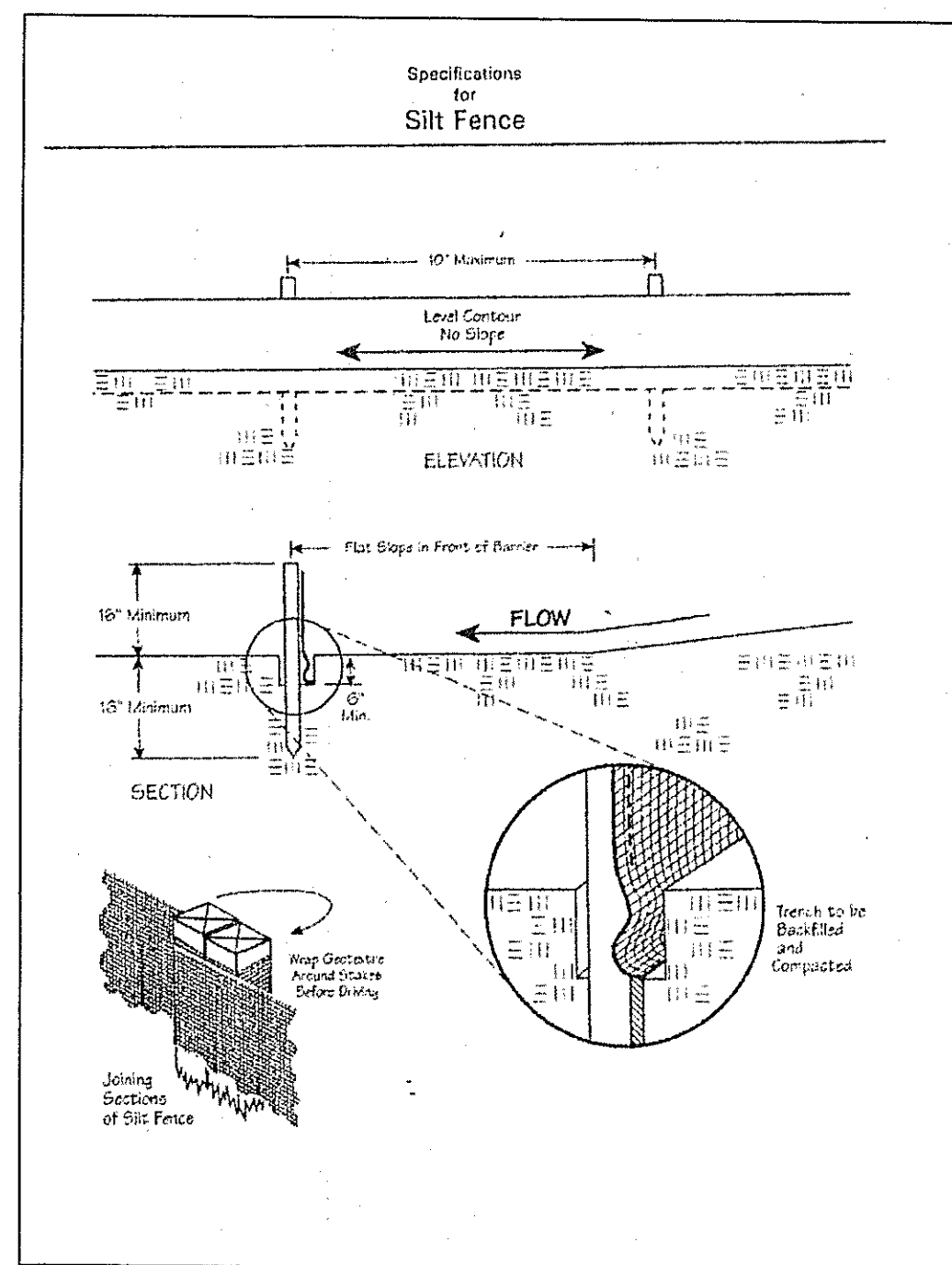

"I, the undersigned hereby certify that this topography indicated by 6", 1", or 2" contours, and elevations shown hereon represent an actual field survey made by me on the 25th day of May, 2005, and that the elevations were taken at appropriate intervals and that as of that date they existed as indicated hereon."

Name Haley Jones #6313  
Reg. No.

**AERMOTOR MODEL: TEP20-50-115**  
1.25" DISCHARGE  
0.5 HORSEPOWER  
115 VOLT  
12.0 AMPS  
1/16" MAX. SOLIDS HANDLING  
1 PHASE  
60 HZ  
MULTI-STAGE CENTRIFUGAL

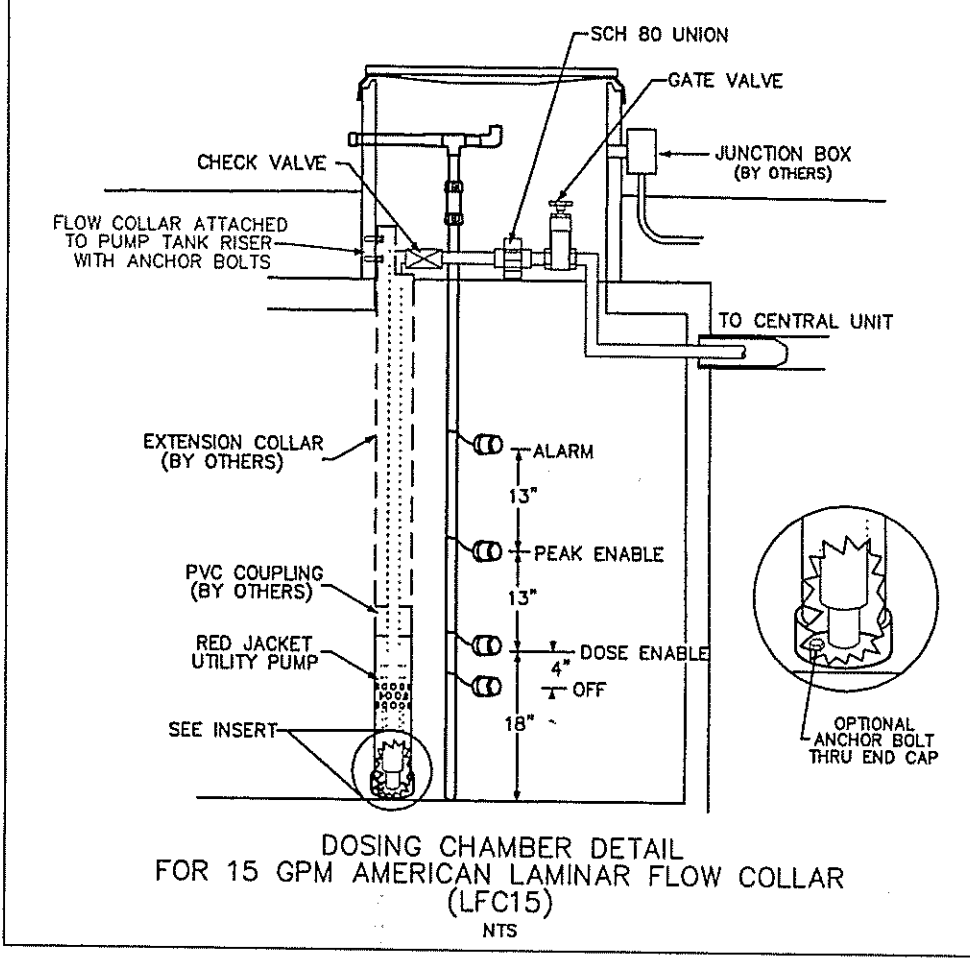

**Stormwater Management Plan**  
Approved as shown and/or noted  
JAMES R. GILLS, P.E.  
County Drainage Engineer  
By L.S. Date 3/22/06  
ORIGINALY APPROVED 3/8/06  
TBM - IP MONUMENT  
ELEV - 1022.64

EXISTING UTILITIES NOTE:  
THE SIZE AND LOCATION, BOTH HORIZONTAL AND VERTICAL OF THE UNDERGROUND UTILITIES SHOWN HEREON, HAVE BEEN OBTAINED BY A SEARCH OF AVAILABLE RECORDS. VERIFICATION BY FIELD OBSERVATION HAS BEEN CONDUCTED WHERE PRACTICAL, HOWEVER, BABCOCK, JONES AND ASSOCIATES, INC. DOES NOT GUARANTEE THE COMPLETENESS NOR ACCURACY THEREOF.

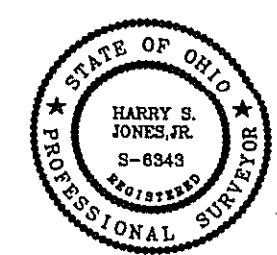

NOTE: ALL IRON PINS SET ARE 5/8" X 30" AND ARE CAPPED BABCOCK, JONES & ASSOC.

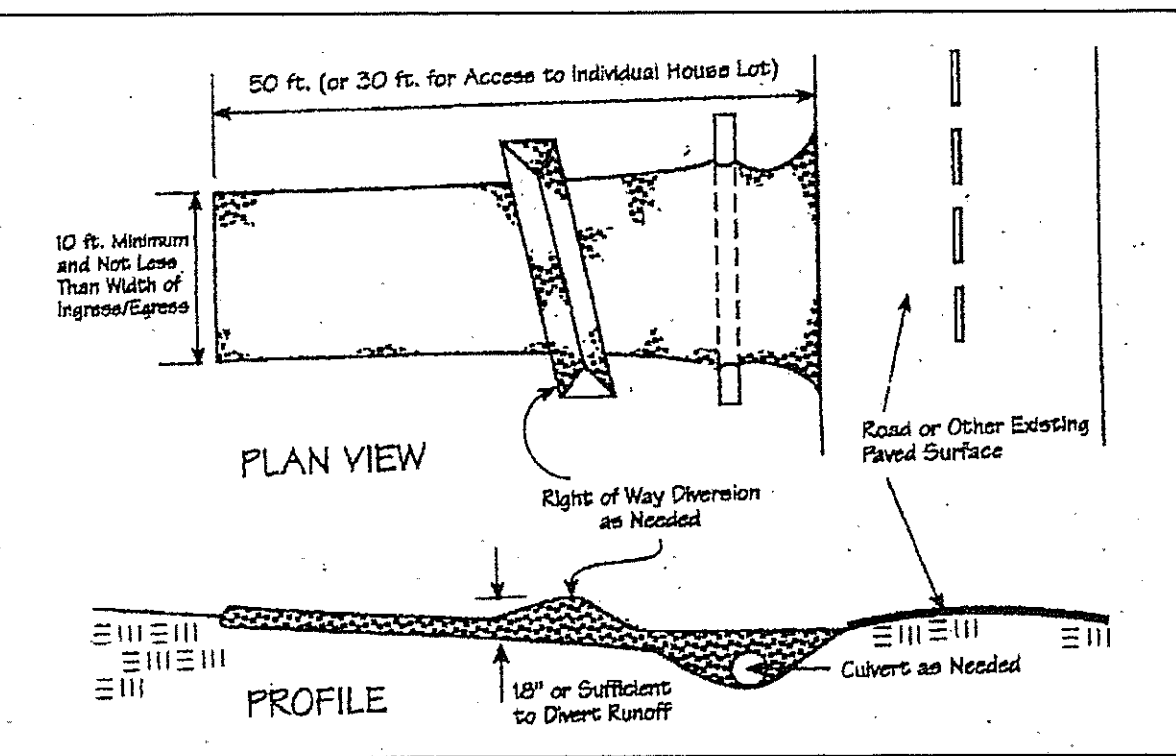
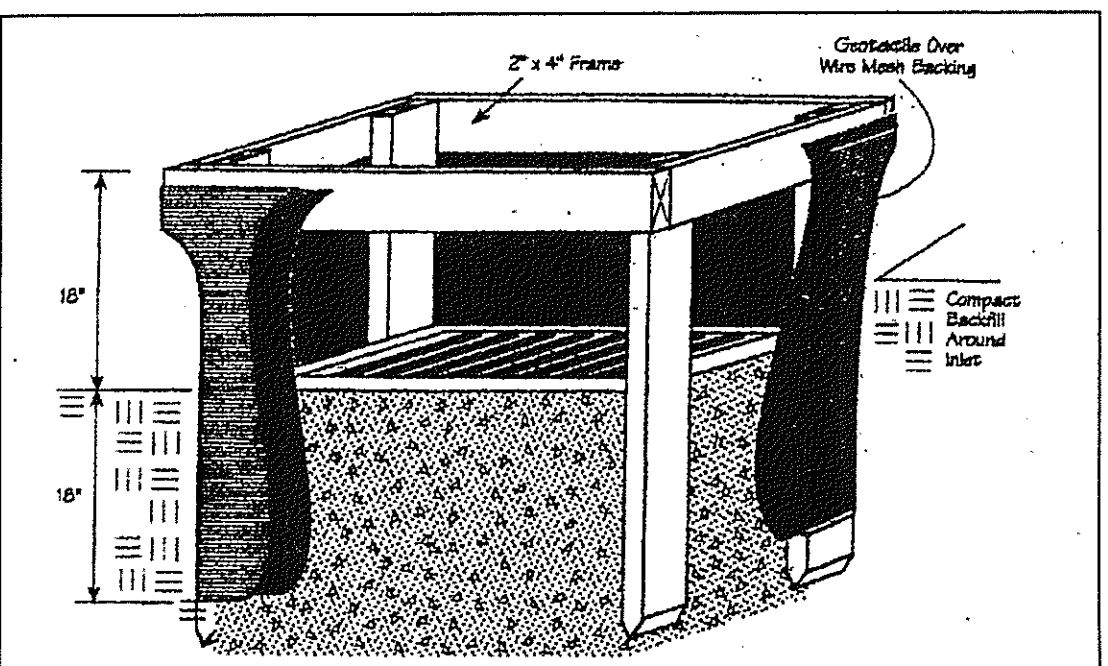

Temporary Seeding Species Selection			
Seeding Dates	Species	Lb./1,000 ft. <sup>2</sup>	Per Ac.
March 1 to August 15	Oats	3	4 bushel
	Tall Fescue	1	40 lb.
	Annual Ryegrass	1	40 lb.
	Perennial Ryegrass	1	40 lb.
	Tall Fescue	1	40 lb.
August 16 to November 1	Rye	3	2 bushel
	Tall Fescue	1	40 lb.
	Annual Ryegrass	1	40 lb.
	Wheat	3	2 bushel
	Tall Fescue	1	40 lb.
November 1 to Spring Seeding	Annual Ryegrass	1	40 lb.
	Perennial Ryegrass	1	40 lb.
	Tall Fescue	1	40 lb.
	Annual Ryegrass	1	40 lb.
	Annual Ryegrass	1	40 lb.

Note: Other approved seed species may be substituted.

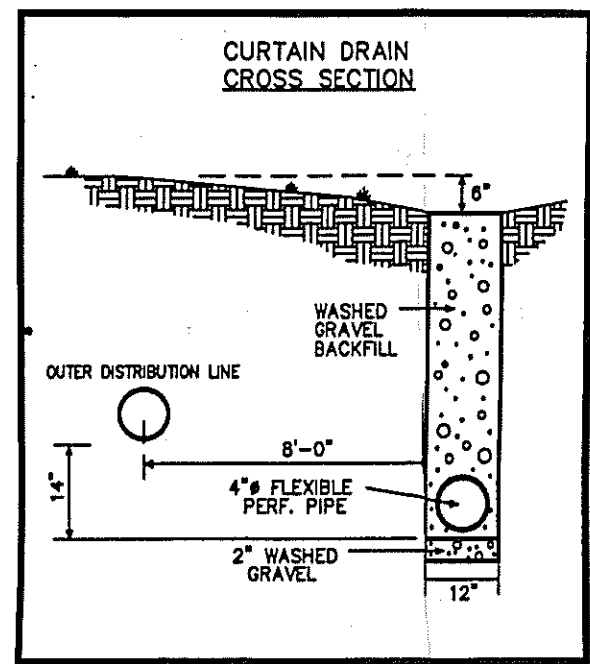
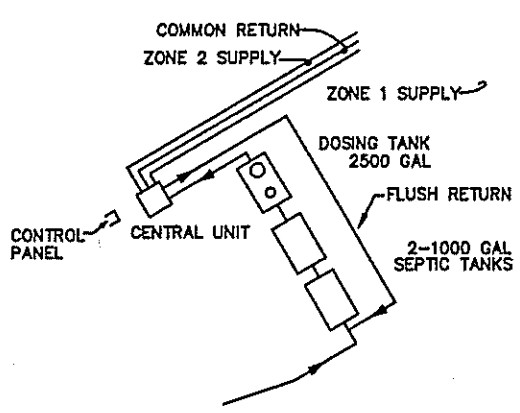

$LLR = 2.7$   
 $\frac{417}{2.7} = 154$   
 $LENGTH = (3 \times 3) + (3 \times 3) + 154 = 172$   
 $WIDTH = (3 \times 3) + (3 \times 3) + 55 = 73.5$

REV NO.	DESCRIPTION	DATE	BY	CHK'D
1	ADDED HOUSE	3/3/06	B.P.	H.J.
2	ADDED DRIP SYS DETAILS	3/17/06	B.P.	H.J.

Drip distribution area has been field verified and protected with marking tape  
Plans submitted to LGHD and meet design criteria  
Hydraulic calculations verified and accurate

3/27/6 DOL  
3/27/6 DOL  
3/27/6 DOL

**babcock, jones and associates, inc**  
CIVIL ENGINEERS - SURVEYORS - LAND PLANNERS  
PAINESVILLE OHIO 44077

DATE	1/27/05
DESIGN BY	H.J.
DRAWN BY	B.P.
APPROVED BY	H.J.
CREW CHIEF	E.H.

**SITE PLAN**  
FOR  
JAY BROWN  
S/L 46 BUCKINGHAM PLACE (MOUNT ROYAL SUB)  
CONCORD TOWNSHIP LAKE COUNTY STATE OF OHIO

SCALE	1"=30'
JOB NO	93-163-46
SHEET	OF
1	2





NOTE: ALL IRON PINS SET ARE  
5/8" X 30" AND ARE CAPPED  
BABCOCK, JONES & ASSOC.

CURVE	LENGTH	RADIUS	TANGENT	CHORD	BEARING	DELTA
C1	94.97	230.00	48.17	94.30	S37°20'11"W	23°39'32"
C2	259.93	200.00	151.99	242.02	S46°50'09"W	74°27'54"

#### Erosion and Sediment Control Schedule

##### Ingress-Egress

A stone access drive complete with under lying geo-textile fabric (20 feet wide and 50 feet long) for ingress and egress at the site shall be installed. This drive shall be the only entrance and exit to the site.

##### Silt Fence

A silt fence shall be installed prior to any earthwork activities at the site in the locations shown on the site plan as well as along the front of any lot that slopes towards the street.

##### Temporary Seeding

Disturbed areas of the site that are to remain idle for more than thirty(30) days shall be properly seeded and straw mulched within seven(7) days of completion of initial grading. Temporary seeding and mulching as a thirty(30) foot strip of the entire front of the lot shall be maintained on the site once initial grading is complete.

Stabilization of critical areas within fifty(50) feet of any stream or wetland shall be complete within two(2) days of the disturbance if the site is to remain inactive for longer than fourteen(14) days.

##### Mulching

Straw-mulch shall be applied at a rate of 1 bale per every ten (10) feet of curb, at a width of thirty(30) feet to the entire length of the lot. Wood chips may also be used but must be spread at a minimum depth of four inches over the thirty-foot width and must be accompanied by a properly installed silt fence.

##### Maintenance

Erosion and sediment controls shall be inspected every seven(7) days or within 24 hours of a 0.5" or greater rainfall event. Necessary repairs shall be made at this time.

"I, the undersigned hereby certify that this topography indicated by 6", 1", or 2" contours, and elevations shown hereon represent an actual field survey made by me on the 25<sup>th</sup> day of May, 2006 and that the elevations were taken at appropriate intervals and that as of that date they existed as indicated hereon."

*Harry Jones*  
Name \_\_\_\_\_ Reg. No. \_\_\_\_\_

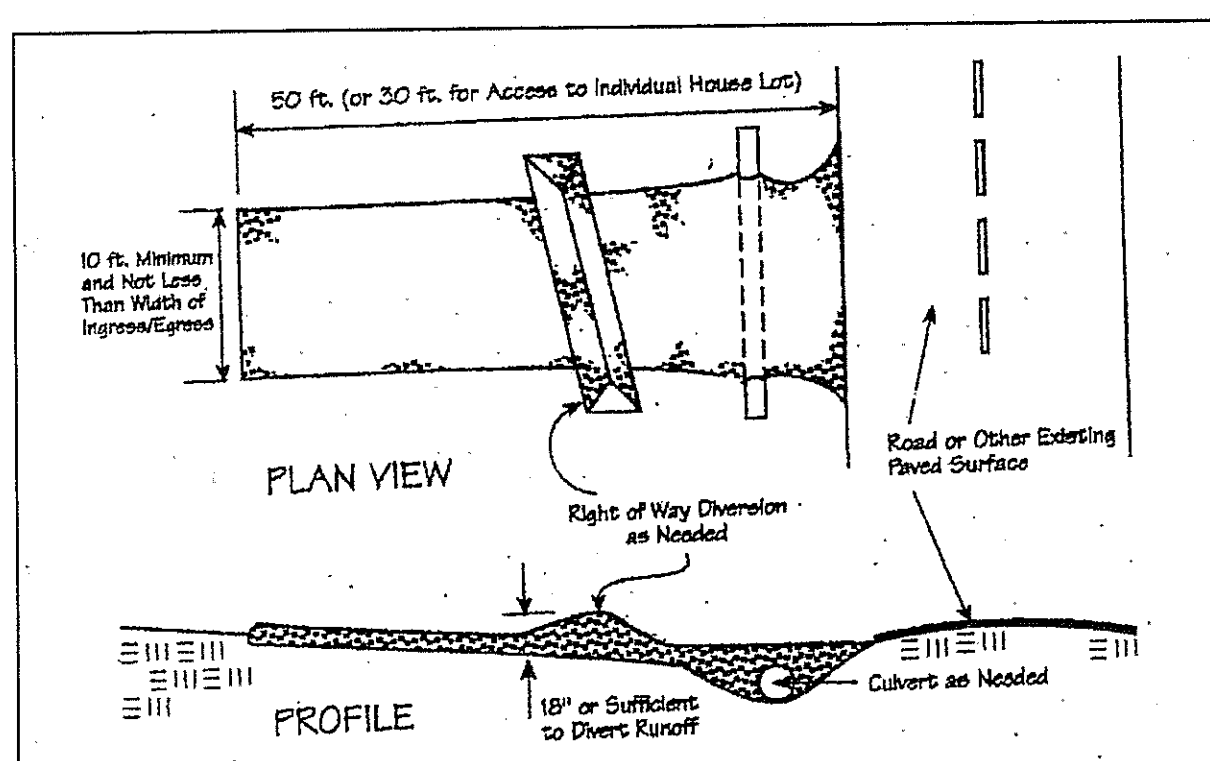
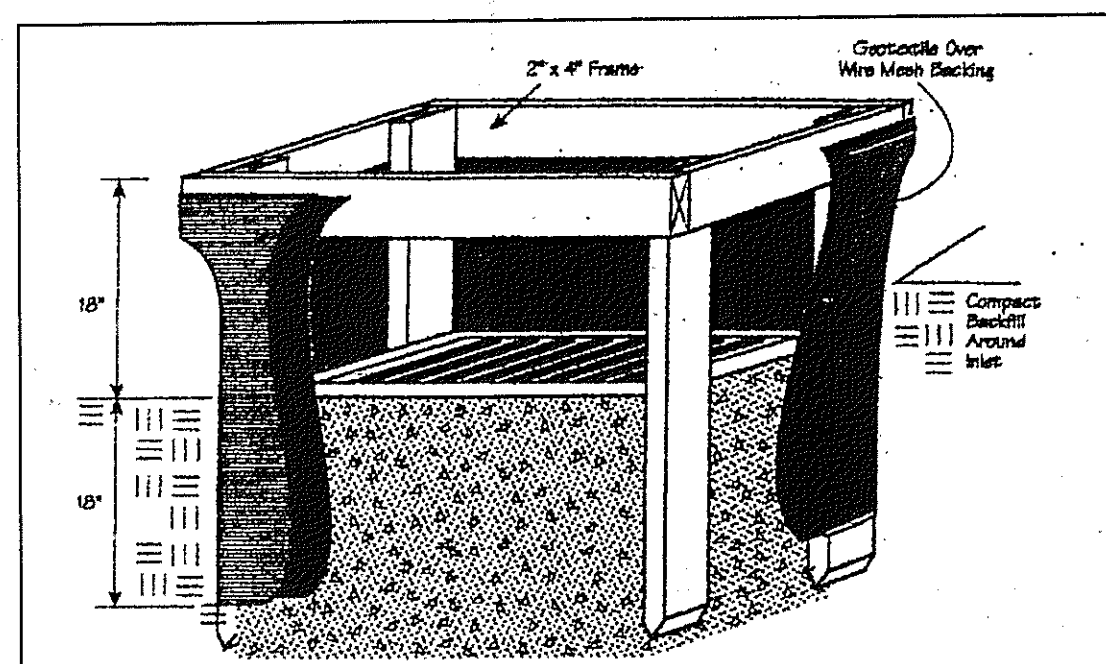
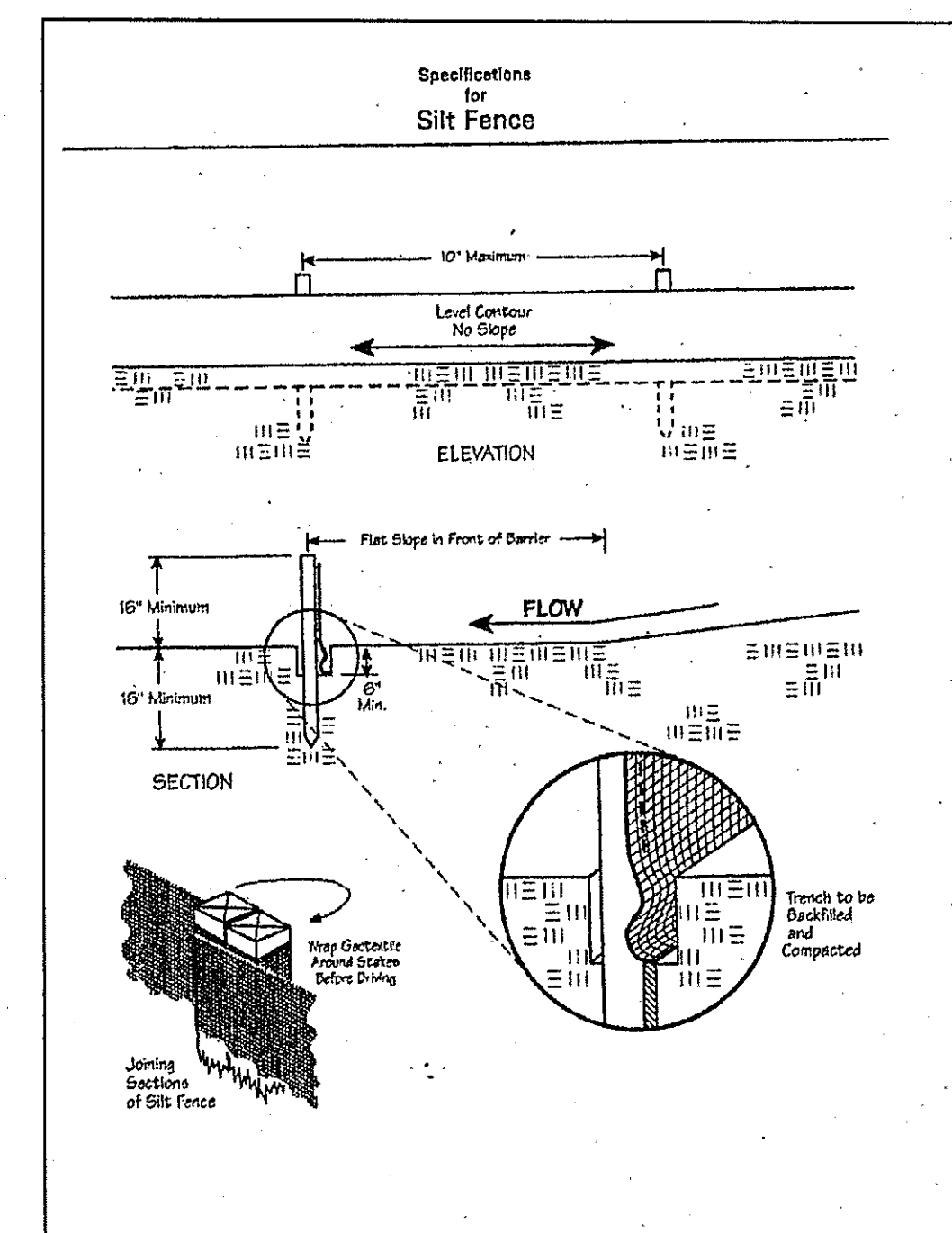

Temporary Seeding Species Selection			
Seeding Dates	Species	Lb./1,000 ft. <sup>2</sup>	Per Ac.
March 1 to August 15	Oats	3	4 bushel
	Tall Fescue	1	40 lb.
	Annual Ryegrass	1	40 lb.
	Perennial Ryegrass	1	40 lb.
August 16 to November 1	Tall Fescue	1	40 lb.
	Annual Ryegrass	1	40 lb.
	Wheat	3	2 bushel
	Tall Fescue	1	40 lb.
November 1 to Spring Seeding	Perennial Ryegrass	1	40 lb.
	Tall Fescue	1	40 lb.
	Annual Ryegrass	1	40 lb.
	Use mulch only, sodding practices or dormant seeding.		

Note: Other approved seed species may be substituted.

REV NO.	DESCRIPTION	DATE	BY	CHK'D
1	ADDED HOUSE	3/3/06	B.P.	H.J.



**BABCOCK, JONES AND ASSOCIATES, INC.**  
CIVIL ENGINEERS - SURVEYORS - LAND PLANNERS  
PAINESVILLE OHIO 44077

DATE	1/27/05
DESIGN BY	H.J.
DRAWN BY	B.P.
APPROVED BY	H.J.
CREW CHIEF	E.H.

SITE PLAN  
FOR  
JAY BROWN

S/L 46 BUCKINGHAM PLACE (MOUNT ROYAL SUB)  
CONCORD TOWNSHIP LAKE COUNTY STATE OF OHIO

SCALE	1"=30'
JOB NO	93-163-46
SHEET	1
OF	1

CONCORD TOWNSHIP ZONING OFFICE  
Zoning Permit # 0306-12992  
Date Issued 3/9/06  
Subject to Approval By:  
☒ Lake Co. Engineer/Storm Water Mgmt.  
☒ Lake Co. Utilities Dept.  
☒ Lake Co. Soil + Water District  
☒ Lake Co. Health District  
☒ Lake Co. Building Dept.

TBM -IP MONUMENT  
ELEV - 1022.64

EXISTING UTILITIES NOTE:  
THE SIZE AND LOCATION, BOTH HORIZONTAL AND VERTICAL  
OF THE UNDERGROUND UTILITIES SHOWN HEREON, HAVE BEEN  
OBTAINED BY A SEARCH OF AVAILABLE RECORDS.  
VERIFICATION BY FIELD OBSERVATION HAS BEEN CONDUCTED  
WHERE PRACTICAL. HOWEVER, BABCOCK, JONES AND ASSOCIATES  
INC. DOES NOT GUARANTEE THE COMPLETENESS NOR ACCURACY  
THEREOF.  
Stormwater Management Plan  
Approved as shown and/or not shown  
JAMES R. GILLS, P.E.  
County Drainage Engineer  
By L.S. Date 3/8/06

