

# House Summary

KEY:  
GAR.FLR.=GARAGE FLOOR ELEVATION AT GARAGE DOOR  
TOP/WALL=TOP OF WALL ELEVATION  
FRST.FLR.=FIRST FLOOR ELEVATION  
BSMT.FLR.=BASEMENT FLOOR ELEVATION  
TOP/FTR.=TOP OF FOOTER ELEVATION

ELEVATIONS USED TO ESTABLISH  
HOUSE FLOOR GRADES:

- GAR.FLR. + 4"=TOP OF WALL
- TOP OF WALL + 13"=FRST.FLR.
- TOP OF WALL -8.0"=TOP/FTR.
- TOP OF FTR.+4"(0.33")=BSMT.FLR.
- TOP OF FTR.-8"(0.67")=BTM.FTR.\*\*\*\*

\*\*\*\*NOTE: BOTTOM OF FOOTER ELEVATION SET BASED UPON RYAN HOMES STANDARD TYPICAL SECTION. POLARIS ENGINEERING & SURVEYING DOES NOT CERTIFY THAT THE APPROPRIATE SOIL BEARING CAPACITY IS ACHIEVABLE AT THIS ELEVATION. CONTRACTOR/BUILDER IS RESPONSIBLE TO CONFIRM THAT THE APPROPRIATE BEARING CAPACITY IS ACHIEVED AT THE PLAN ELEVATIONS.

## HOUSE INFORMATION

MODEL: FLORENCE/VERSION 05/ELEVATION C  
GARAGE: 2 CAR FRONT LOAD/LEFT  
OPTIONS: MORNING ROOM, LDF FIREPLACE

## NOTE:

1. CONTRACTOR TO VERIFY LOCATION & DEPTH OF LATERALS;
2. MINIMUM BUILDING SEPARATION SHALL BE 10'.
3. WATER CONNECTIONS SHALL BE AS PER AQUA OHIO REQUIREMENTS AND STANDARDS.
4. SUMP PUMP SHALL BE CONNECTED TO PROPOSED STORM CONNECTION.
5. ALL DOWNSPOUTS SHALL BE SPLASH BLOCKED (SPLASH BLOCKS TO BE DIRECTED TO THE FRONT OR THE REAR OF THE UNITS NOT TO THE SIDES).
6. SEE IMPROVEMENT PLANS FOR ARIA'S WAY PHASE 3, FOR ADDITIONAL EROSION CONTROL AND GRADING ITEMS.
7. ANY PROPOSED DECKS SHALL COMPLY WITH THE BUILDING SETBACK REQUIREMENTS SET FORTH IN SECTION 17.08
8. GRINDER PUMP REQUIRED FOR BASEMENT SANITARY SERVICE.

000.00 = SPOT ELEVATIONS

## EXISTING UNDERGROUND UTILITIES NOTE:

THE SIZE AND LOCATION, BOTH HORIZONTAL AND VERTICAL OF THE UNDERGROUND UTILITIES SHOWN HEREON, HAVE BEEN OBTAINED BY A SEARCH OF AVAILABLE RECORDS. VERIFICATION BY FIELD OBSERVATION HAS BEEN CONDUCTED WHERE PRACTICAL. HOWEVER, POLARIS ENGINEERING & SURVEYING, INC. DOES NOT GUARANTEE THE COMPLETENESS NOR ACCURACY THEREOF.

## BENCHMARK:

B.M. = T.B.M SET ON TOP OF HYDRANT  
Located FRONT OF UNIT 7  
Elevation 758.50

## CONCORD TOWNSHIP ZONING OFFICE

Zoning Permit # 0914-15497

Date Issued 9/29/2014

Subject to Approval By:

- ☒ Lake Co. Engineer/Storm Water Mgmt.
- ☒ Lake Co. Utilities Dept.
- ☒ Lake Co. Soil + Water District
- ☒ Lake Co. Health District
- ☒ Lake Co. Building Dept.

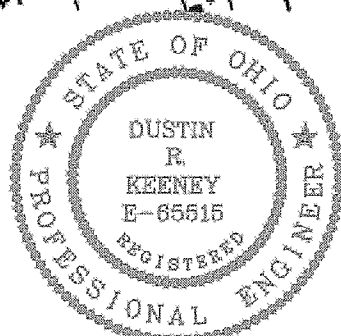
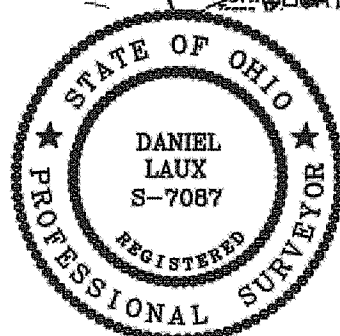

DESIGN CERTIFICATION  
THIS PLAN WAS PREPARED BY ME, AND IS CORRECT TO THE BEST OF MY KNOWLEDGE AND BELIEF.

Dustin R. Keeney  
DUSTIN R. KEENEY, P.E. NO. E-65515

9/24/14  
DATE

THE TOPOGRAPHY, INDICATED BY 1' CONTOURS, AND ELEVATIONS SHOWN HEREON REPRESENT AN ACTUAL FIELD SURVEY MADE BY DANIEL LAUX, P.S. NO. 7087 ON AUGUST 3RD, 2012. THE ELEVATIONS WERE TAKEN AT APPROPRIATE INTERVALS AND AS OF THE ABOVE DATE THEY EXISTED AS INDICATED HEREON.

Daniel Laux  
DANIEL LAUX, P.S. NO. 7087

10/5/12  
DATE

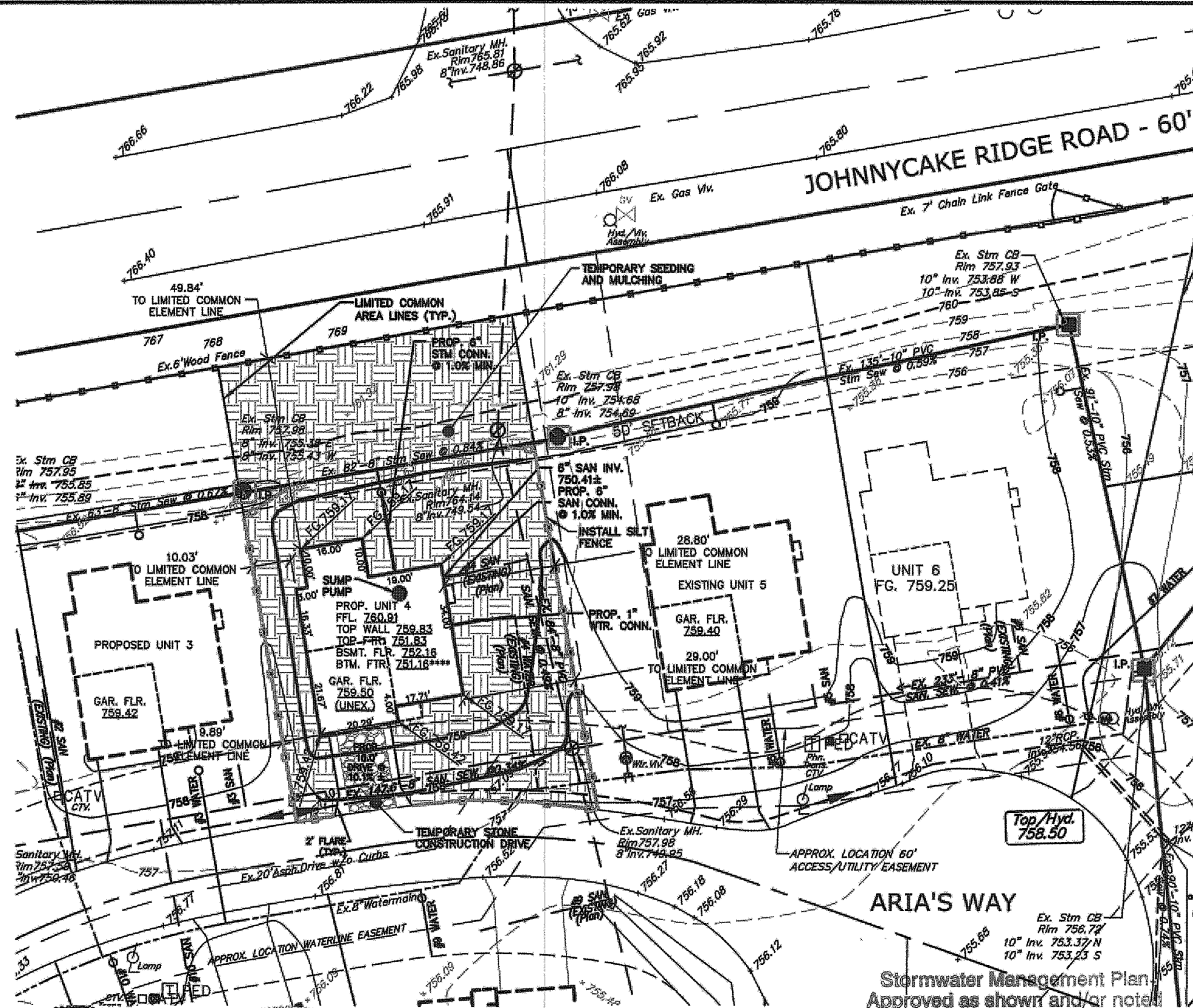

## ARIA'S WAY

Stormwater Management Plan  
Approved as shown and/or noted

JAMES R. GILLS, P.E.  
County Drainage Engineer

By L.S. Date 9-30-14



POLARIS ENGINEERING & SURVEYING, INC.  
34800 CHARDON ROAD  
SUITE D  
WILLOUGHBY HILLS, OH 44094  
(440) 844-4433  
(440) 844-3722 (Fax)  
www.polaris-es.com

DATE: 9/24/14

SCALE: HOR. 1"=30'  
VERT. none

FILENAME: Unit 4 Site Plan

SITE PLAN FOR:  
6856 ARIA'S WAY  
UNIT 4  
ARIA'S WAY  
PHASE 3

CONCORD TOWNSHIP - LAKE COUNTY - OHIO

## OWNER:

RYAN HOMES  
5770 W. SNOWVILLE ROAD  
SUITE 100  
BRECKSVILLE, OHIO 44141

PHONE: (440) 584-4221

CONTACT:  
MARK FAIR

CONTRACT No.

12032

SHEET	OF
1	2