

RAY & EDYTHE KENNEDY
V124 - PG 388
7A-1J-10

ORIGINAL - 5.6550 Ac
LOT SPLIT "A" - 1.5100 Ac
LOT SPLIT "B" - 1.5100 Ac
BALANCE - 2.635 Ac

PETER & NANCY HALLAHAN
V 646-PG 23
7A-1J-11

PAMELA S & MATHEW D SLEEK
No 9900-9183
7A-1J-20

1.6746 ACRE SPLIT
0.1389 ACRE R/W
1.5357 - NET

LOT SPLIT "B" - 1.5100 Ac
RIGHT-OF-WAY - 0.1122 Ac
NET - 1.3978 Ac

LOT SPLIT "A" - 1.5100 Ac
RIGHT-OF-WAY - 0.1122 Ac
NET - 1.3978 Ac

RUTH G ET AL REMKUS
V17 - PG 225
7A-1J-12

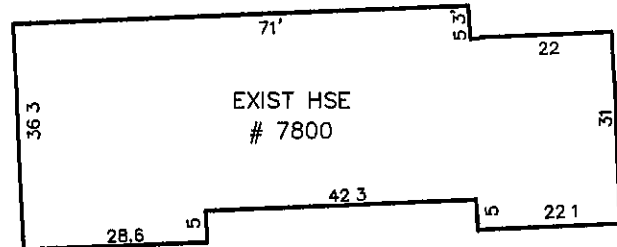

PAINESVILLE WARREN ROAD - 66'

SUMNER ROAD - 60'

NOTE ALL IRON PINS SET ARE
5/8" X 30" AND CAPPED
BABCOCK LONES & ASSOC

BASIS OF BEARINGS IS THE CENTERLINE
OF SUMNER ROAD OF NORTH 0°30'00" EAST
AND IS USED TO DESCRIBE ANGLES ONLY.

Harry Jones, Jr. #42313 Sept 10, 2002
SURVEYOR NAME DATE

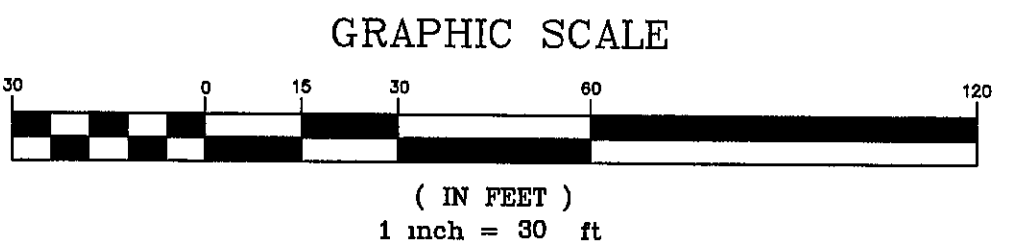
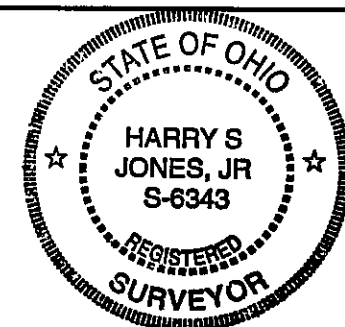

REV NO.	DESCRIPTION	DATE	BY	CHK'D
1	REVISIONS PER L.C. ENGINEER	10-17-02	HJT	HJT

bj BABCOCK, JONES AND ASSOCIATES, INC
CIVIL ENGINEERS - SURVEYORS - LAND PLANNERS
PAINESVILLE OHIO 44077

DATE 9/11/02
DESIGN BY H.J.
DRAWN BY B.P.
APPROVED BY H.J.

PLAT OF SURVEY
FOR
HARRY REMINGTON
LOT No 2
LERoy TOWNSHIP LAKE COUNTY

SCALE 1"=30'
JOB NO 02-208
SHEET 1 OF 1