

Bearings are based upon the centerline of Painesville-Warren Road being South 40°30'00" East and are used to describe angles only.

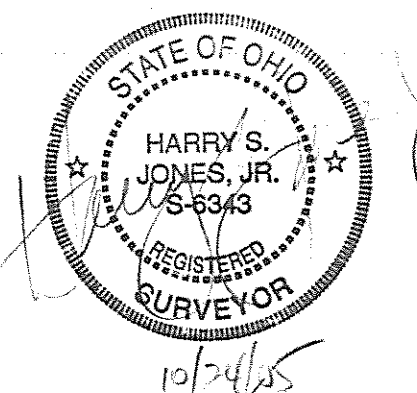

PAINESVILLE WARREN ROAD-60' (STATE ROUTE 86)

REV. NO.	DESCRIPTION	DATE	BY	CHK'D
1	Added Areas R, S & T	12-14-05	HJ	HT
2	Revised Plat	12-19-05	HT	HT

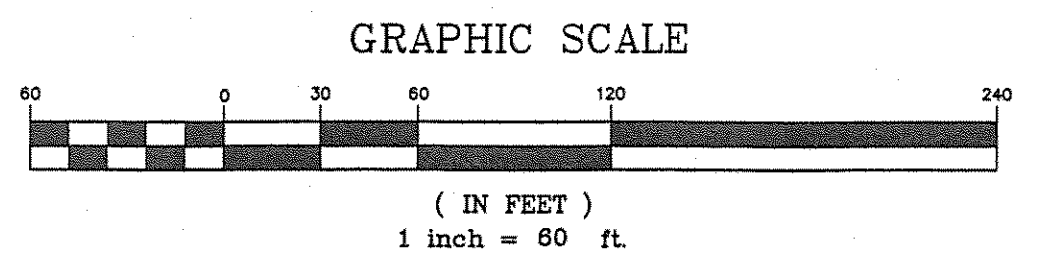

bj BABCOCK, JONES AND ASSOCIATES, INC
 CIVIL ENGINEERS - SURVEYORS - LAND PLANNERS
 PAINESVILLE OHIO 44077

DATE	6/18/02
DESIGN BY	H.J.
DRAWN BY	B.P.
APPROVED BY	H.J.

PLAT OF SURVEY
 FOR
 LARRY LENNON
 LEROY TOWNSHIP LAKE COUNTY STATE OF OHIO

SCALE:	1"=60'
JOB NO.	00-286
SHEET	1
OF	1